

**ULINE** H-11242, H-11243  
H-11248, H-11249  
**EXECUTIVE OFFICE DESK**

1-800-295-5510  
uline.com

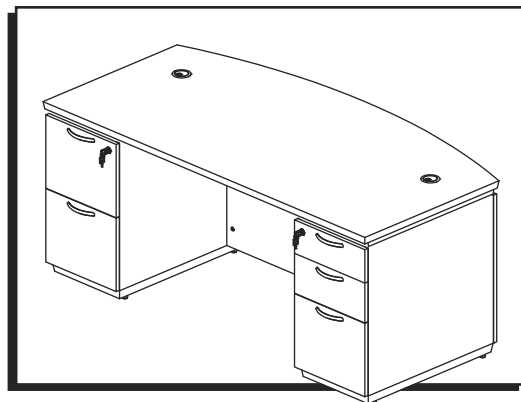

**TOOLS NEEDED**

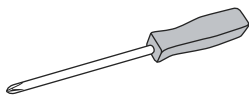

Phillips Screwdriver



Allen Wrench  
(included)



Two Person Assembly  
Recommended

**DESK PARTS**

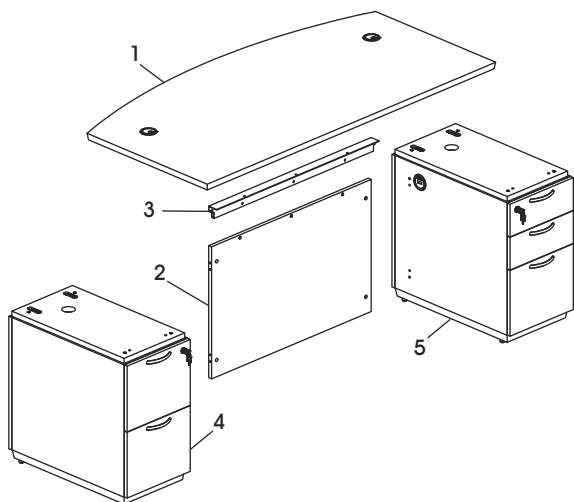

#	DESCRIPTION	QTY.
1	Desktop	1
2	Laminate Modesty Panel	1
3	Modesty Panel Trim	1
4	Pedestal File – 2-Drawer	1
5	Pedestal File – 3-Drawer	1



**NOTE:** If assembling L-Desk, skip to page 5.



**NOTE:** Tighten all bolts, screws, cam lock pins and cam locks using Phillips screwdriver.



**NOTE:** Assembly shows bow front desk. Rectangular desks follow same assembly.

**DESK HARDWARE**



Desktop Grommet x 2

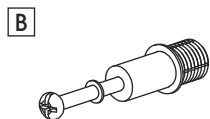

Cam Lock Pin x 4



Cam Lock x 4

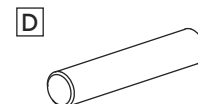

Dowel x 4



Cam Lock Cap x 4

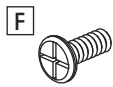

M6 x 15 mm Bolt x 3

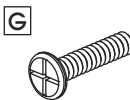

M6 x 25 mm Bolt x 3



Pedestal Grommet x 4

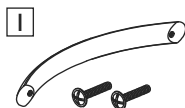

Handle x 5  
M4 x 22 mm Bolt x 10

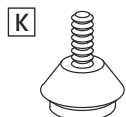

Adjustable Glide x 8



Shoulder Bolt x 4

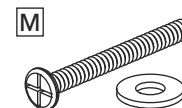

M6 x 55 mm Bolt x 4  
Washer x 4

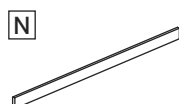

Metal Bar x 3



File Clip x 6

# DESK ASSEMBLY



If assembling L-Desk, skip to page 5.



**NOTE:** Assemble unit on a smooth, non-marring surface to prevent scratching. Check drawers and packaging to ensure all parts and hardware are included.

1. Remove pre-attached handles (I) from inside of pedestal files (4,5). Align holes on handle with holes on outside of drawer. Attach using two M4 x 22 mm bolts (I). Repeat for remaining drawers. (See Figure 1)

Figure 1

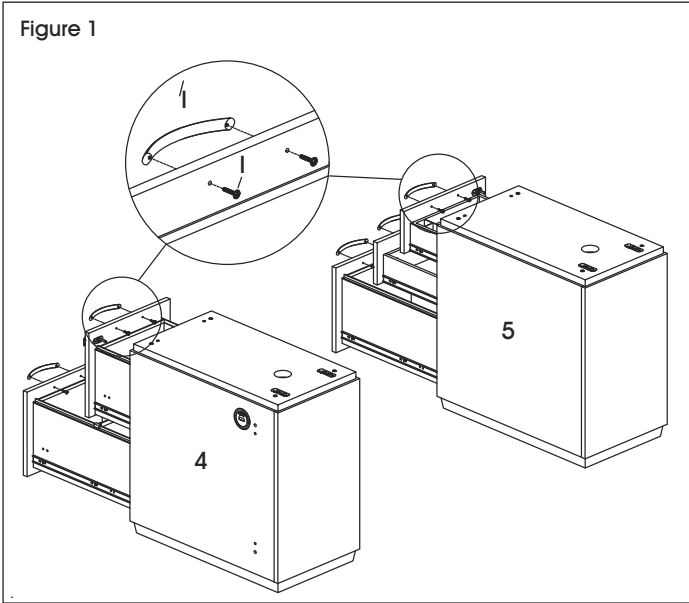

2. With a second person, carefully flip pedestal files (4,5) upside down. Install four adjustable glides (K) into the bottom panel of each pedestal file. Place pedestal files upright. (See Figure 2)

Figure 2

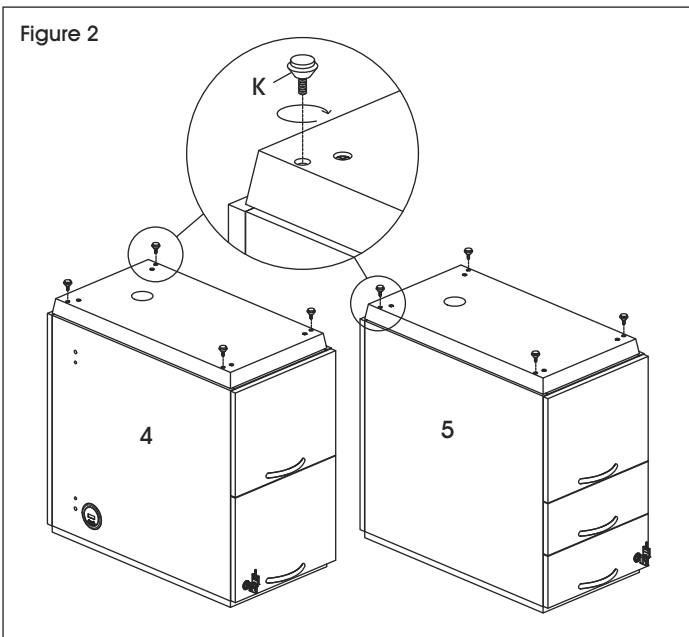

3. Install two cam lock pins (B) into the side of the 2-drawer pedestal file (4). Repeat on the 3-drawer pedestal file (5). (See Figure 3)



**IMPORTANT!** Cam lock pins (B) must be tightened once inserted into panel. To tighten, grasp lower part of cam lock pin and tighten using a Phillips screwdriver.

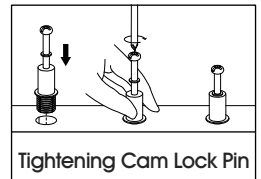
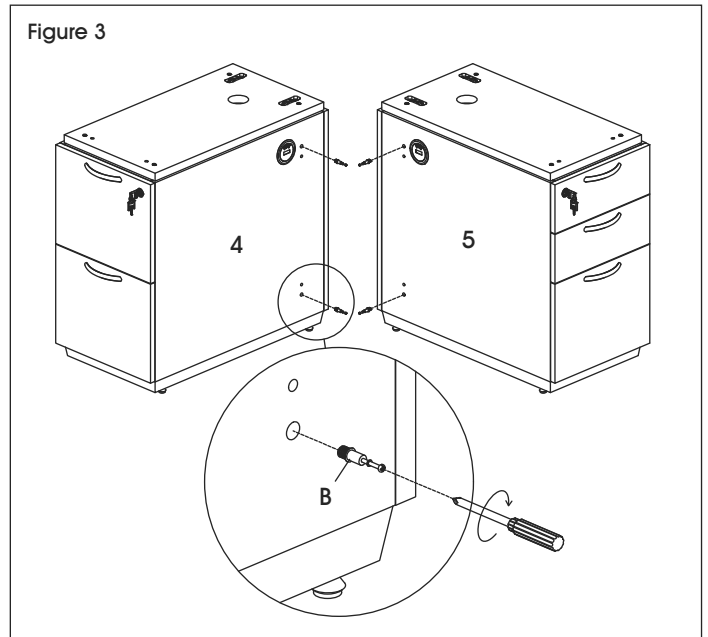

Figure 3



4. Install four cam locks (C) into holes on laminate modesty panel (2). Insert two dowels (D) into each side edge of the laminate modesty panel. (See Figure 4)



**IMPORTANT!** Ensure arrow is pointing toward edge of panel before inserting into panel's hole. Turn cam lock 1/4 to the right to lock.

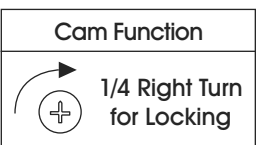
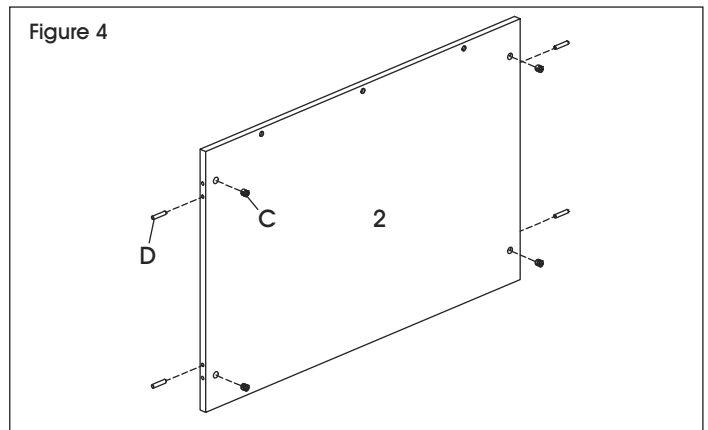

Figure 4



## DESK ASSEMBLY CONTINUED

5. With a second person, connect laminate modesty panel (2) in between the pedestal files (4,5). Tighten cam locks (C). (See Figure 5)

 **NOTE:** Cam lock caps (E) can be applied once cam locks are tightened for a finished look.

 **NOTE:** 2-drawer pedestal file will be on the left side of laminate modesty panel. 3-drawer will be on the right side.

Figure 5

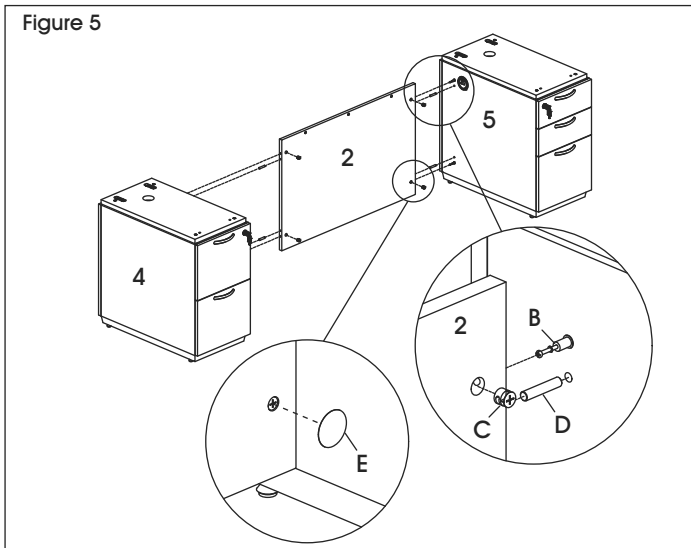

6. Attach modesty panel trim (3) to top edge of laminate modesty panel (2) using three M6 x 25 mm bolts (G). (See Figure 6)

Figure 6

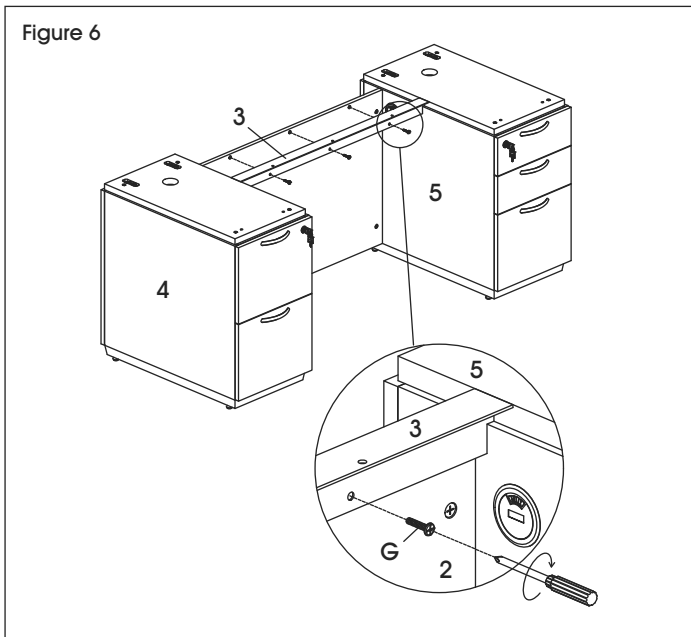

7. Remove all drawers from both pedestal files (4,5). (See Figure 7)

 **NOTE:** To remove drawers, fully open drawer and locate tabs on drawer slides. While pressing down on the left tab and pulling up on the right tab, pull out drawer body from cabinet.

Figure 7



8. With a second person, place desktop (1) upside down with pre-threaded holes facing up. Install four shoulder bolts (L) into black pre-threaded holes. (See Figure 8)

Figure 8

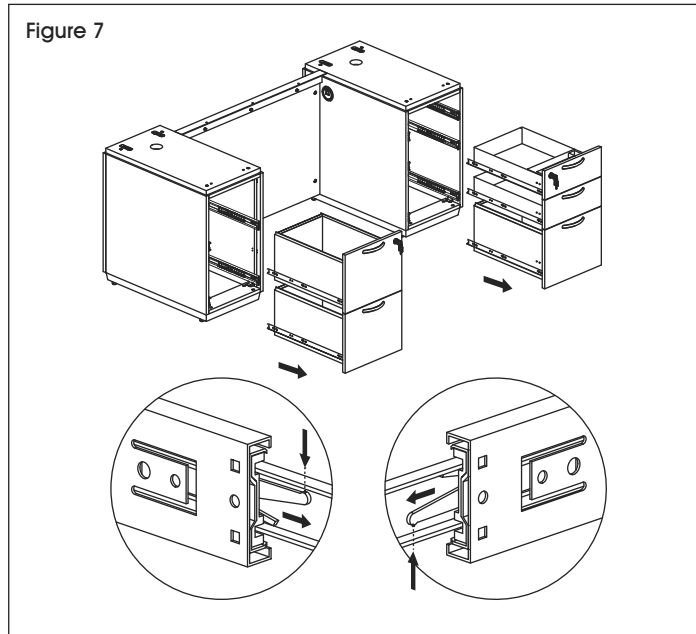
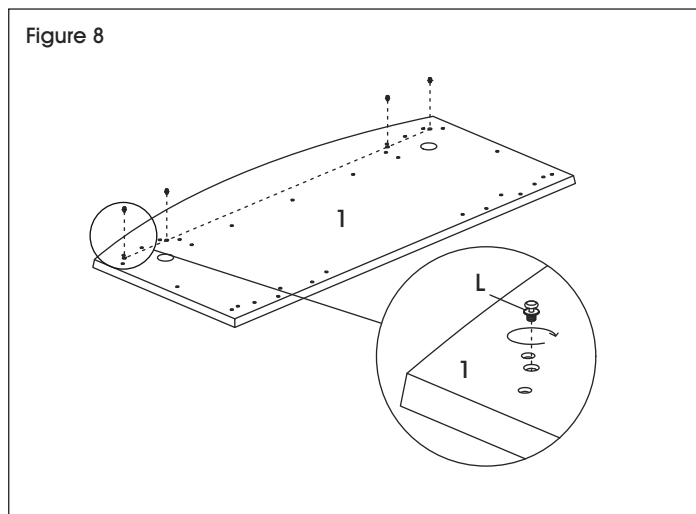

# DESK ASSEMBLY CONTINUED

9. With a second person, pick up the desktop (1) and align shoulder bolts (L) with slotted brackets in each pedestal file (4,5). Carefully lower desktop onto pedestal files. (See Figure 9)

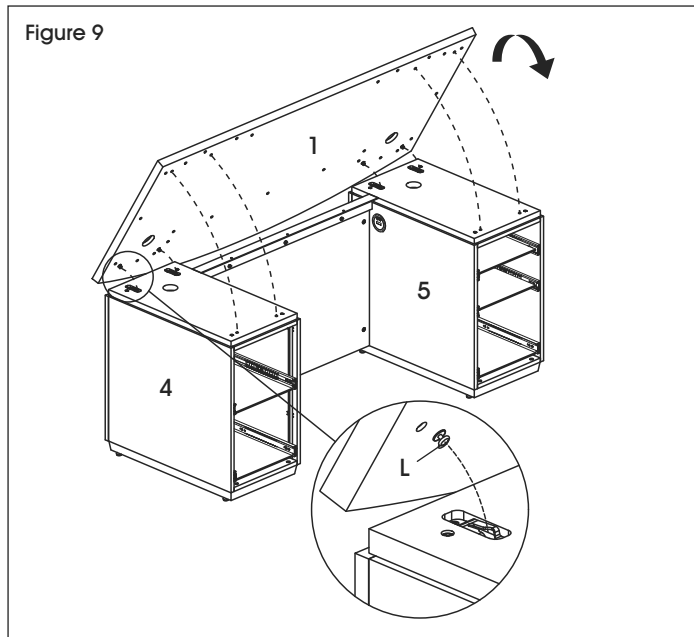

10. Carefully push the desktop (1) toward the rear of the pedestal files (4,5) to lock shoulder bolts (L) into place. (See Figure 10)

 **NOTE:** Desktop should shift about 3/4" toward the rear of pedestal files.

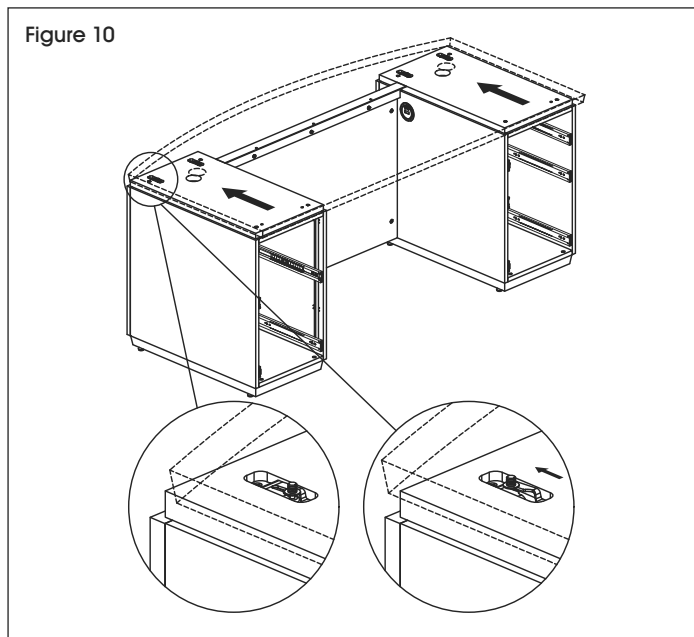

11. Connect desktop (1) to front of pedestal files (4,5) using four M6 x 55 mm bolts and four washers (M). (See Figure 11)

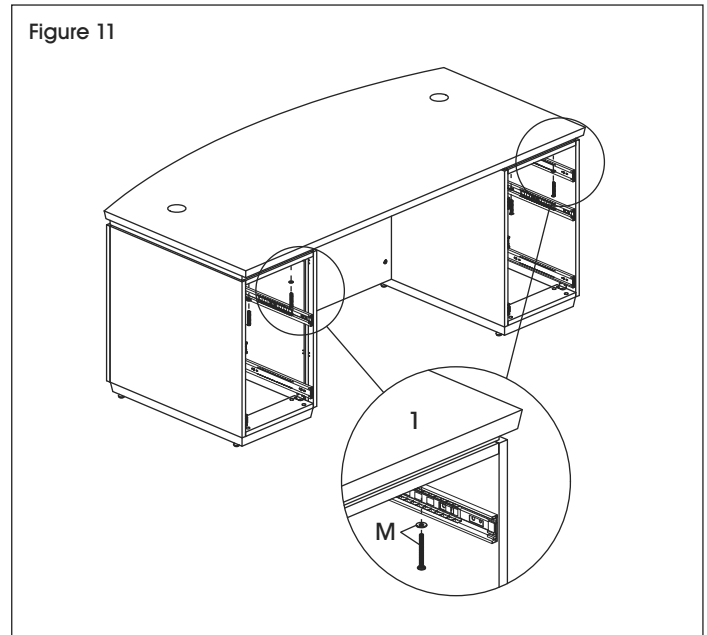

12. Attach modesty panel trim (3) to the desktop (1) using three M6 x 15 mm bolts (F). (See Figure 12)

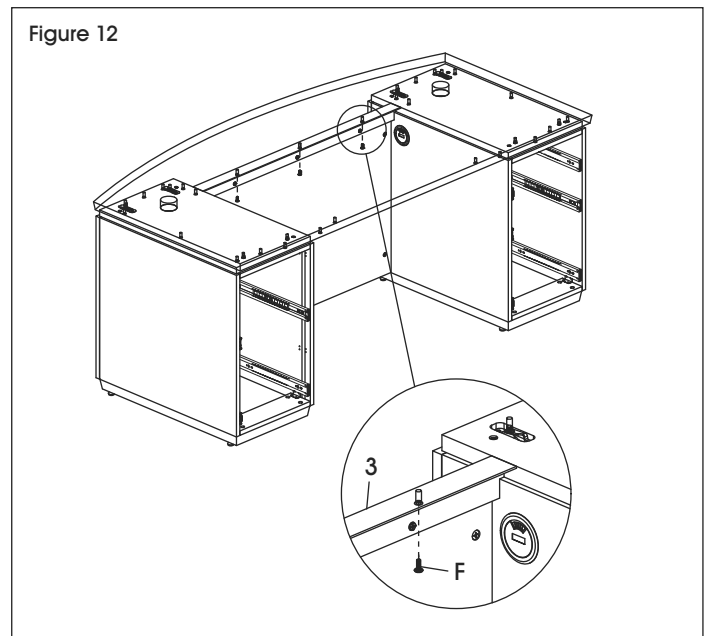

## DESK ASSEMBLY CONTINUED

13. Reinstall drawers into each pedestal file (4,5) and insert desktop grommets (A). (See Figure 13)

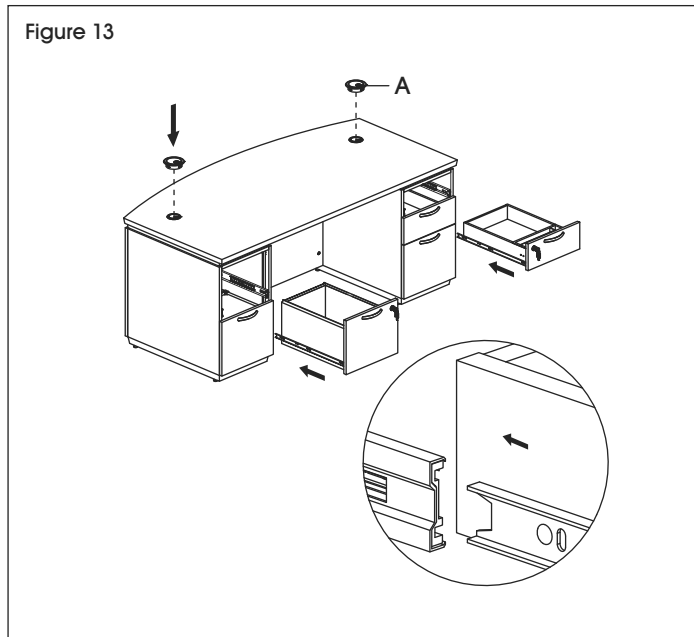

14. In each file drawer, attach file clips (O) to both sides of drawer and insert metal bar (N). (See Figure 14)

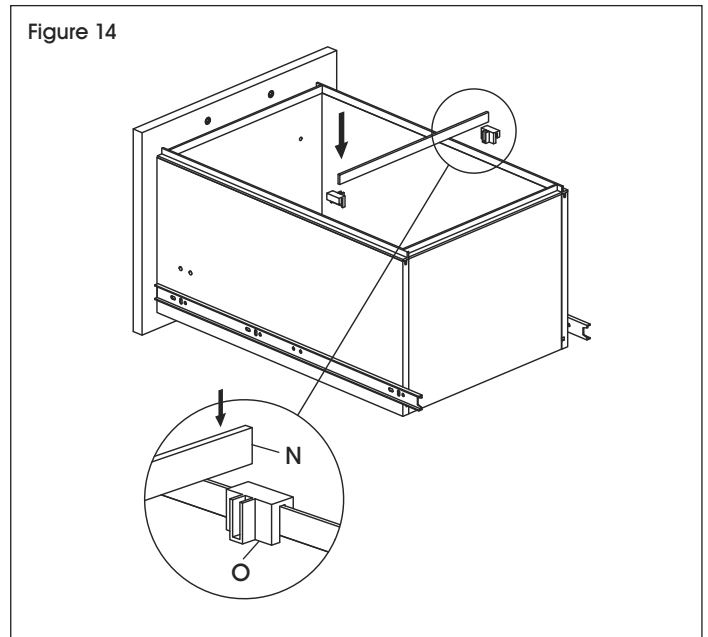

Assembly Complete

## L-DESK PARTS

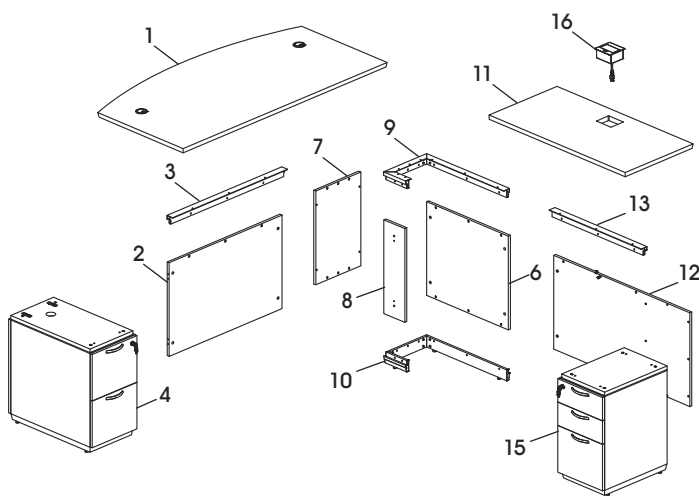

Right-Hand Return shown above

#	DESCRIPTION	QTY.
1	Desktop	1
2	Laminate Modesty Panel	1
3	Modesty Panel Trim	1
4	Pedestal File – 2-Drawer (Right-Hand L-Desk)	1
6	Side Panel	1
7	Back Panel	1
8	Inner Side Panel	1
9	Half Leg Top Trim	1
10	Half Leg Bottom Trim	1
11	Return Desktop	1
12	Return Modesty Panel	1
13	Return Modesty Panel Trim	1
15	Return Pedestal File – 3-Drawer (Right-Hand L-Desk)	1
16	Return Power Center	1
	Pedestal File – 3-Drawer (Left-Hand L-Desk) (Not Shown)	1
	Return Pedestal File – 2-Drawer (Left-Hand L-Desk) (Not Shown)	1

# L-DESK HARDWARE



**A**  
Desktop Grommet x 2

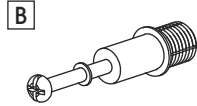

**B**  
Cam Lock Pin x 16

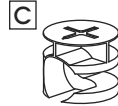

**C**  
Cam Lock x 20

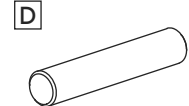

**D**  
Dowel x 4



**E**  
Cam Lock Cap x 20

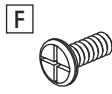

**F**  
M6 x 15 mm Bolt x 22

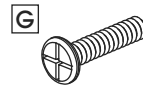

**G**  
M6 x 25 mm Bolt x 22

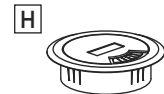

**H**  
Pedestal Grommet x 4

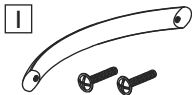

**I**  
Handle x 5  
M4 x 22 mm Bolt x 10

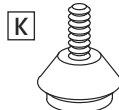

**K**  
Adjustable Glide x 11

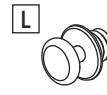

**L**  
Shoulder Bolt x 2

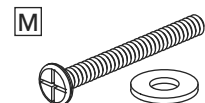

**M**  
M6 x 55 mm bolt x 6  
Washer x 6

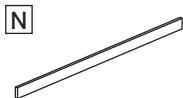

**N**  
Metal Bar x 3

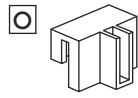

**O**  
File Clip x 6

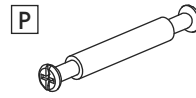

**P**  
Double-End  
Cam Lock Pin x 2

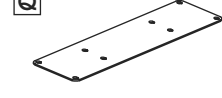

**Q**  
Connector Plate x 1

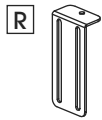

**R**  
L-Bracket x 2

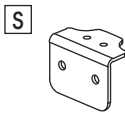

**S**  
Small Bracket x 2

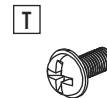

**T**  
M4 x 10 Bolt x 4

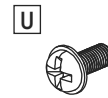

**U**  
M3 x 8 Bolt x 4



**V**  
ST3.5 x 12 Screw x 2

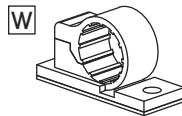

**W**  
Cable Clip x 5

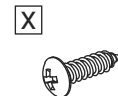

**X**  
Screw ST4 x 16 mm x 5



**NOTE:** The following instructions show a Bow Front Desk with a Right-Hand Return.



**NOTE:** Tighten all bolts, screws, cam lock pins and cam locks using Phillips screwdriver.



**NOTE:** If assembling a left-hand L-desk, main desk pedestal file will be 3-drawer and return pedestal will be 2-drawer.



**NOTE:** Assemble unit on a smooth, non-marring surface to prevent scratching. Check drawers and packaging to ensure all parts and hardware are included.

# L-DESK ASSEMBLY

**NOTE:** For Left-Hand L-Desk configuration, attach pedestal files and return components on opposite side of desktop.

1. Remove pre-attached handles (I) from the inside of 2-drawer pedestal file (4) and return pedestal file (15). Align holes on outside of drawer with holes on handle. Attach using two M4 x 22 mm bolts (I). Repeat for other drawers. (See Figure 15)

Figure 15

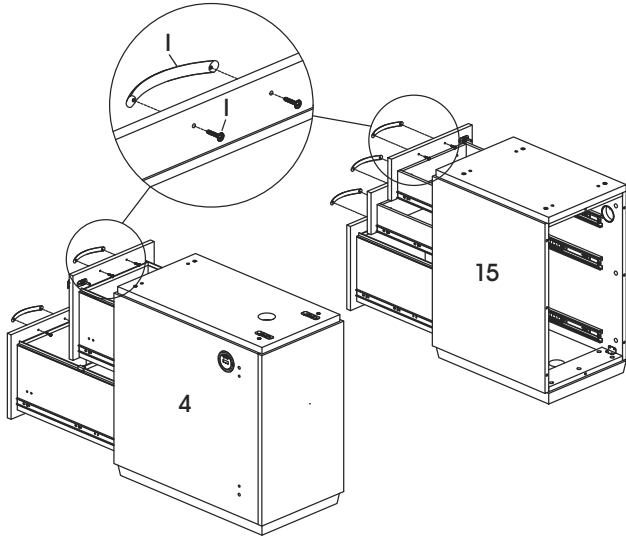

2. With a second person, carefully flip pedestal files (4,15) upside down. Install four adjustable glides (K) into each pedestal file. Place pedestal files upright. (See Figure 16)

Figure 16

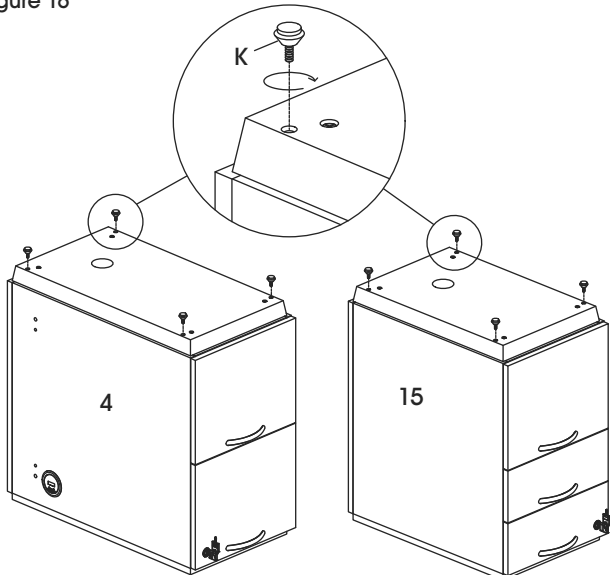

3. Install four cam lock pins (B) into back panel (7). Install four cam locks (C) into side panel (6) and inner side panel (8). Attach side panel and inner side panel to back panel. (See Figure 17)

Figure 17

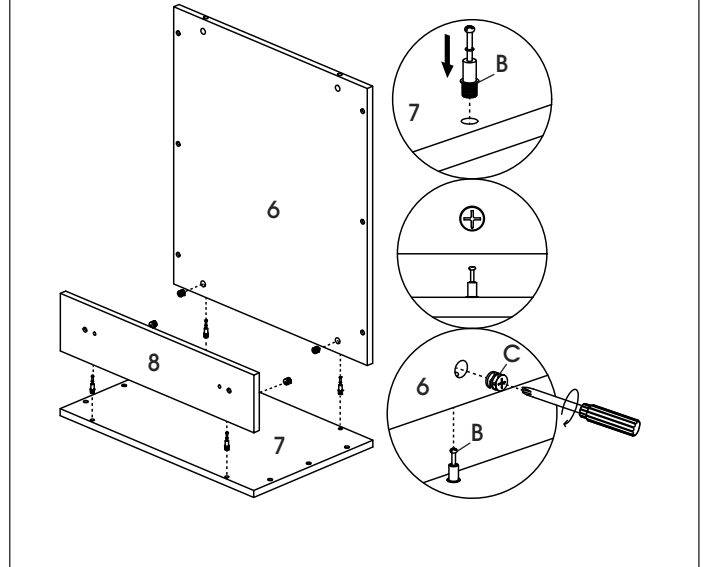

**IMPORTANT!** Ensure arrow is pointing toward edge of panel before inserting into panel's hole. Turn cam lock 1/4 to the right to lock.

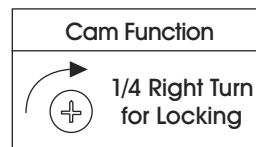

**IMPORTANT!** Cam lock pins (B) must be tightened once inserted into panel. To tighten, grasp lower part of cam lock pin and tighten using a Phillips screwdriver.

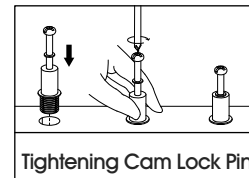

# L-DESK ASSEMBLY

- Attach half leg bottom trim (10) to the bottom edge of the half leg panels using eight M6 x 25 mm bolts (G). Install three adjustable glides (K) into the half leg bottom trim. (See Figure 18)

 **NOTE:** If assembling a left-hand configuration, side panel (6) will be on the right side when assembled panels are placed upside down.

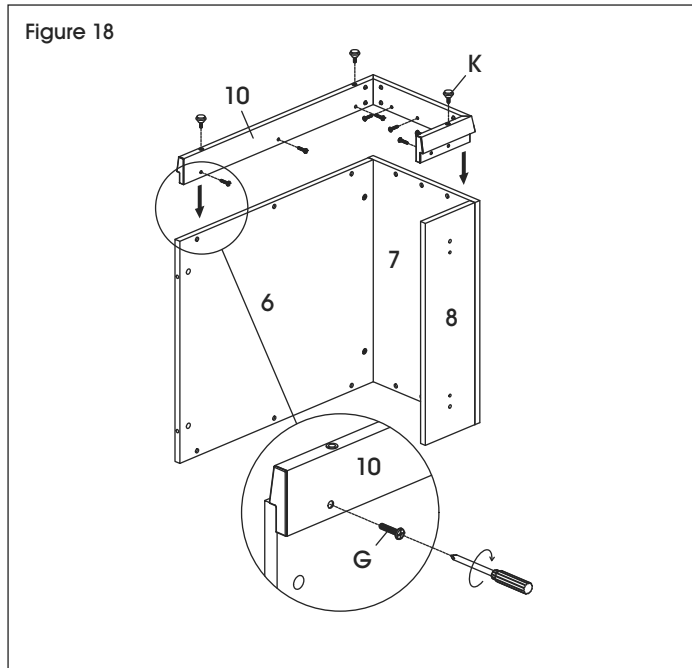

- Flip the half leg onto adjustable glides. Install half leg top trim (9) using eight M6 x 25 mm bolts (G). (See Figure 19)

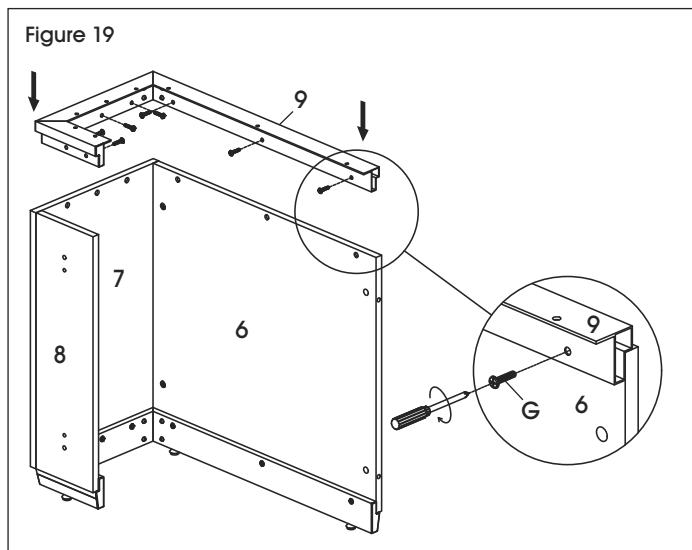

- Remove all drawers from both pedestal files (4,15). (See Figure 20)

 **NOTE:** To remove drawers, locate tabs on drawer slides. Press down on the left tab while pulling up on the right tab and pull out drawer body from cabinet.

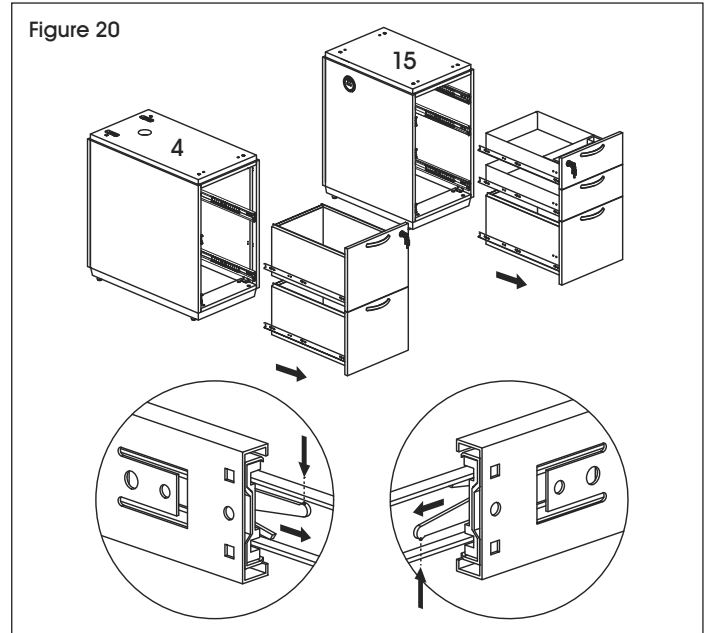

- Install two cam lock pins (B) into the inner panel of the 2-drawer pedestal file (4) and inner side panel (8) on the half leg. (See Figure 21)

 **NOTE:** If assembling left-hand L-Desk, 3-drawer pedestal file will be used.

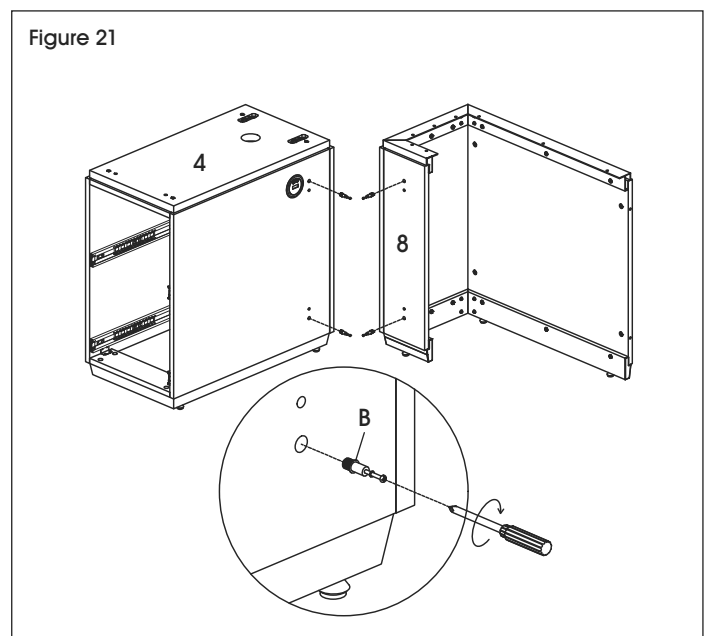



## L-DESK ASSEMBLY CONTINUED

8. Install four cam locks (C) and four dowels (D) into laminate modesty panel (2). (See Figure 22)

Figure 22

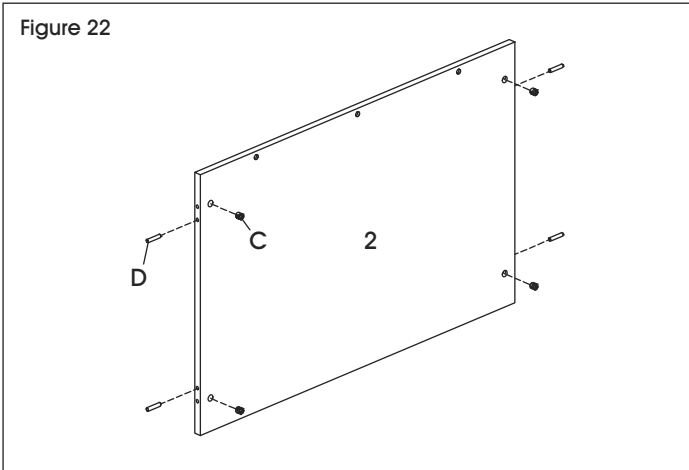

9. With a second person, connect laminate modesty panel (2) in between the 2-drawer pedestal file (4) and inner side panel (8). Tighten cam locks (C). (See Figure 23)

Figure 23

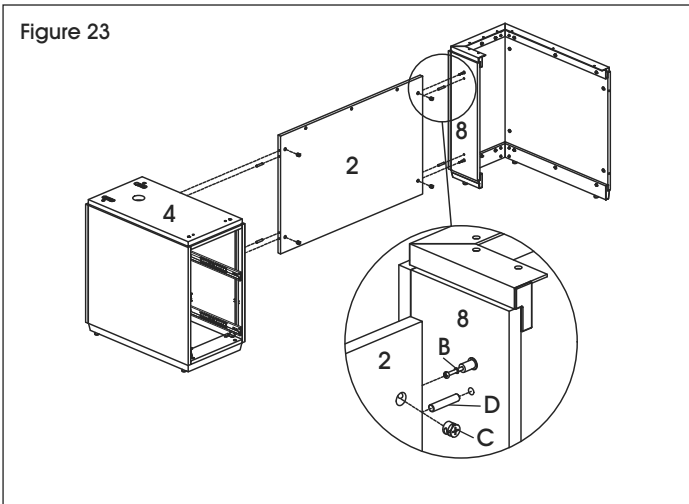

10. Attach modesty panel trim (3) to the top edge of laminate modesty panel (2) using three M6 x 25 mm bolts (G). (See Figure 24)

Figure 24

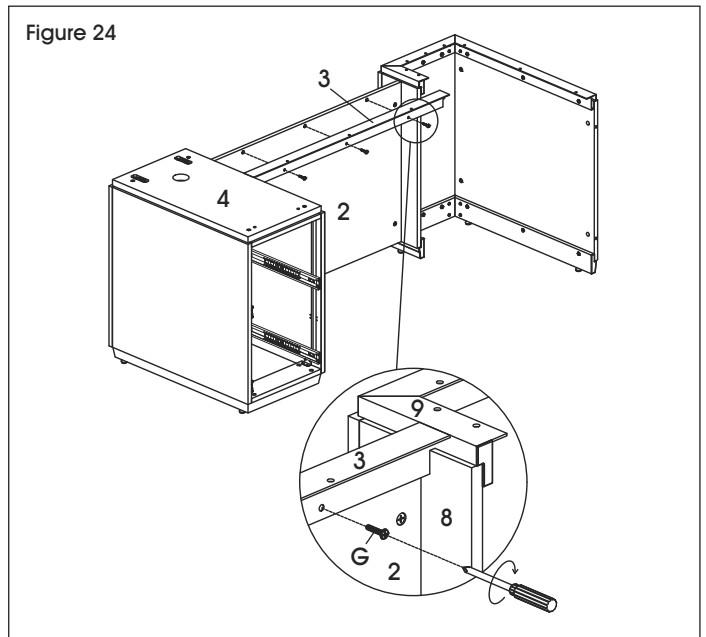

11. Install eight cam lock pins (B) on return modesty panel (12). (See Figure 25)

Figure 25

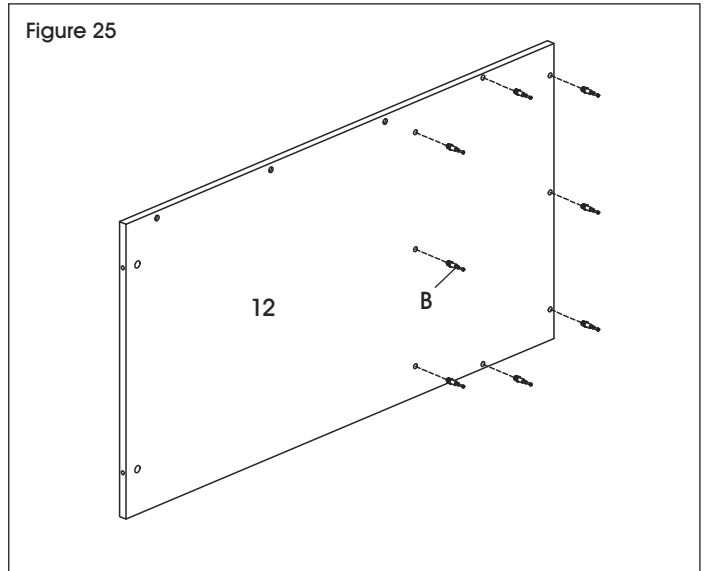

## L-DESK ASSEMBLY CONTINUED

12. Install eight cam locks (C) inside the return pedestal file (15). (See Figure 26)

Figure 26

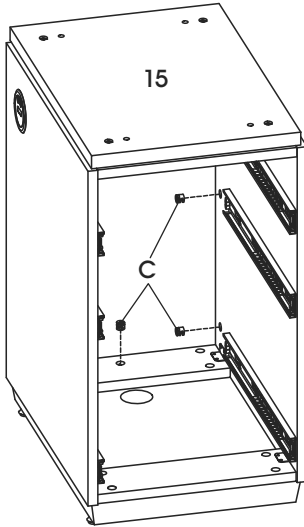

13. Attach return pedestal file (15) to return modesty panel (12). Tighten cam locks (C) on the inside of return pedestal file. (See Figures 27-28)

Figure 27

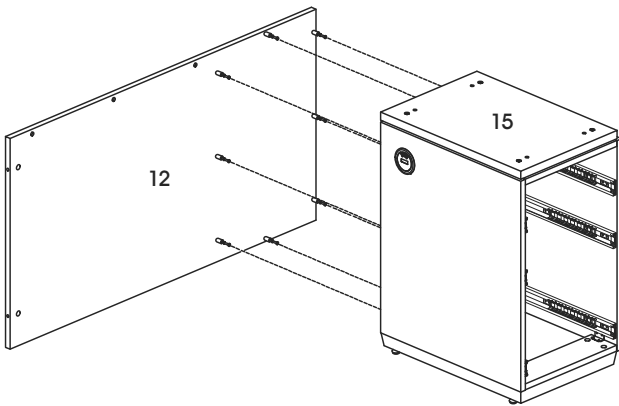
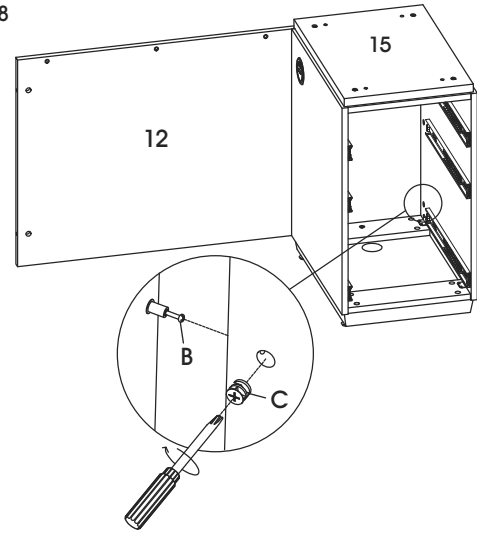
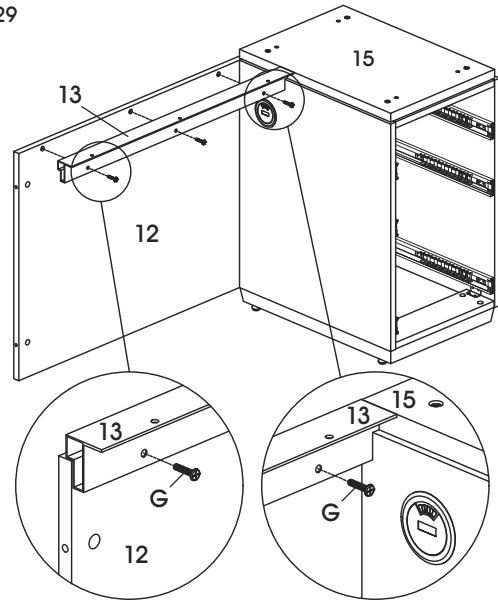

Figure 28



14. Attach return modesty panel trim (13) to the top edge of return modesty panel (12) using three M6 x 25 mm bolts (G). (See Figure 29)

Figure 29



## L-DESK ASSEMBLY CONTINUED



Position assembled components in desired location.

15. With a second person, connect return modesty panel (12) to the side panel (6) on half leg using two double-end cam lock pins (P) and four cam locks (C). (See Figure 30)

Figure 30

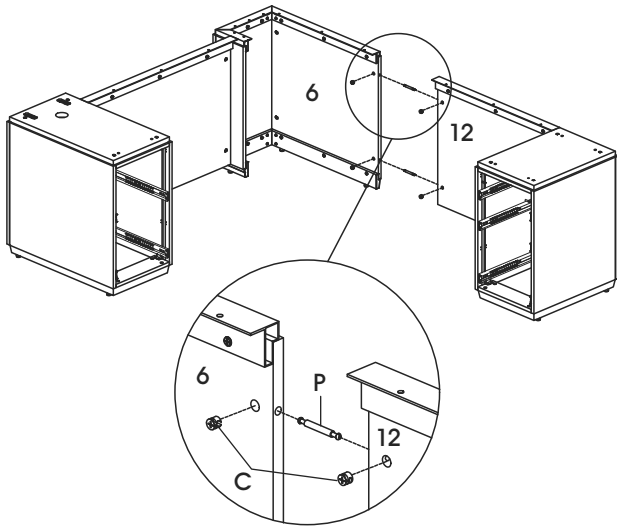

16. With a second person, place desktop (1) upside down. Pre-threaded holes in desktop should be facing up. Install two shoulder bolts (L) into the black pre-threaded holes on right side of desktop. (See Figure 31)



**NOTE:** If assembling left-hand configuration, install shoulder bolts (L) on left side of upside down desktop (1).

Figure 31

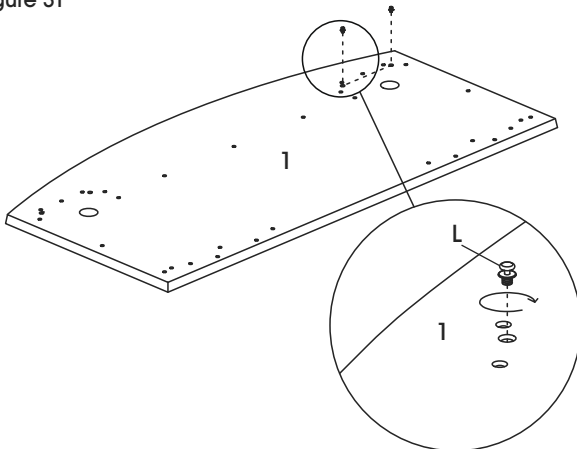

17. With a second person, lift desktop (1) and carefully align shoulder bolts (L) with slotted brackets in 2-drawer pedestal file (4). Lower desktop onto assembled desk frame. (See Figure 32)

Figure 32

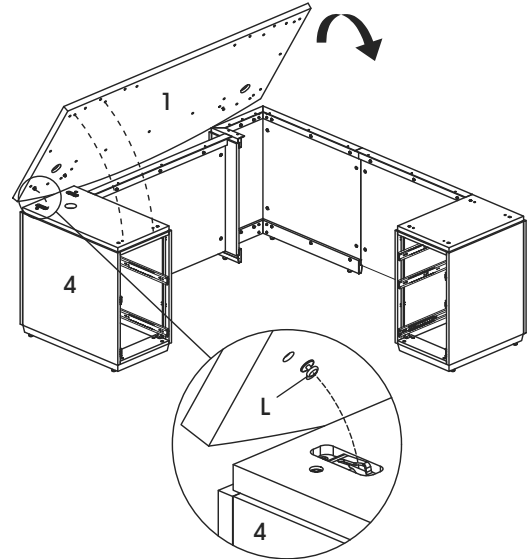

## L-DESK ASSEMBLY CONTINUED

18. Carefully push the desktop (1) toward the rear of the pedestal file (4) and half leg to lock shoulder bolts (L) into place. (See Figure 33)

 **NOTE:** Desktop should shift about 3/4" toward the rear of the pedestal file.

 **NOTE:** Slotted brackets are only on one side of the desktop. Favor the side that includes slotted brackets when pushing the desktop.

Figure 33

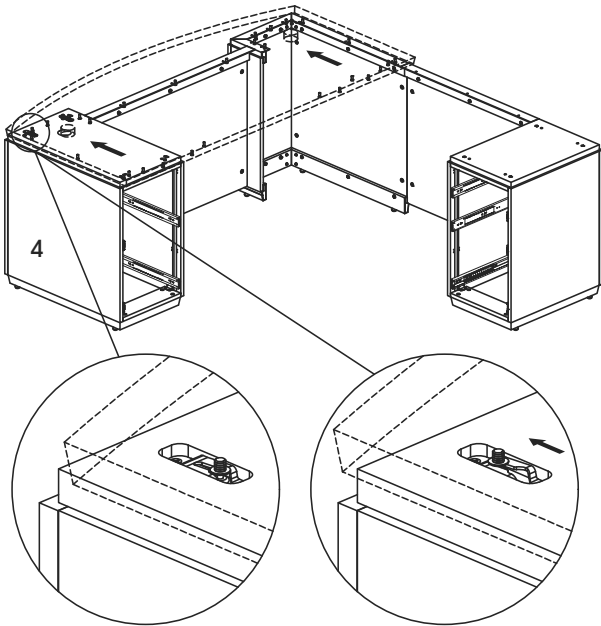

19. Connect desktop (1) to pedestal file (4) using two M6 x 55 mm bolts and washers (M). (See Figure 34)

Figure 34

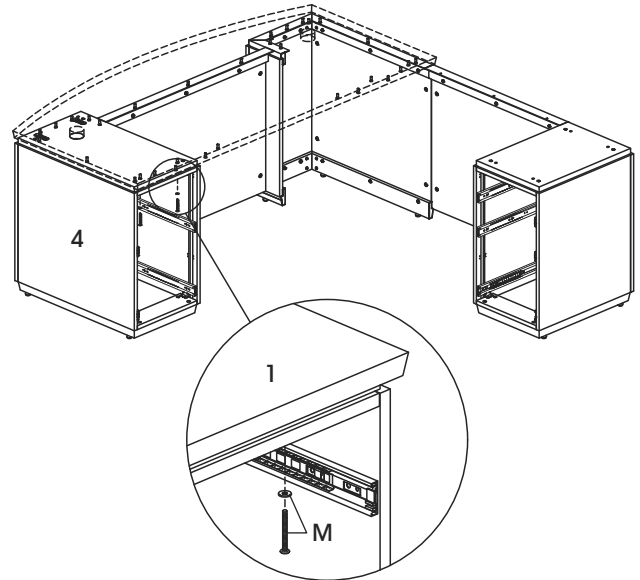

20. Insert return power center (16) into return desktop (11). With second person, carefully flip return desktop upside down. (See Figure 35)

Figure 35

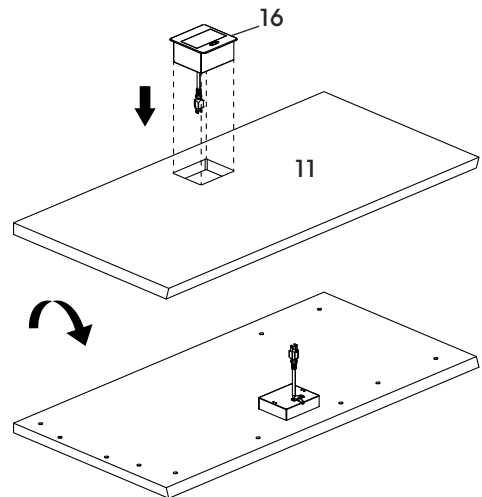

## L-DESK ASSEMBLY CONTINUED

21. Loosely connect L-Bracket (R) and small bracket (S) using two M4 x 10 mm bolts (T). Repeat for remaining L-Bracket and small bracket. (See Figure 36)

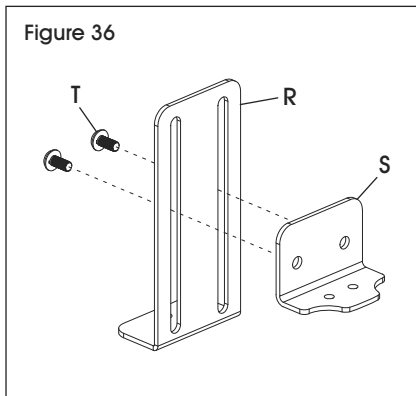

22. Attach assembled brackets to underside of return power center (16) using four M3 x 8 mm bolts (U). (See Figure 37)

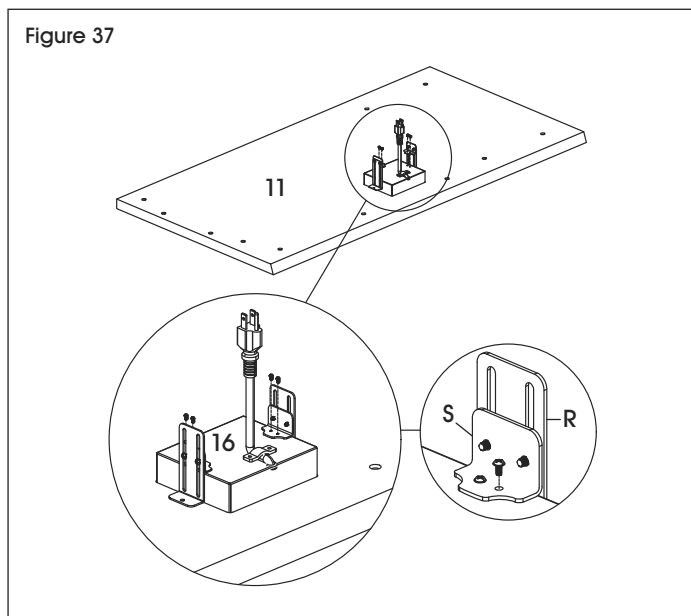

23. Attach both L-Brackets (R) to the return desktop (11) using two ST3.5 x 12 mm screws (V). Fully tighten bolts connecting L-Bracket and small bracket (S). (See Figure 38)

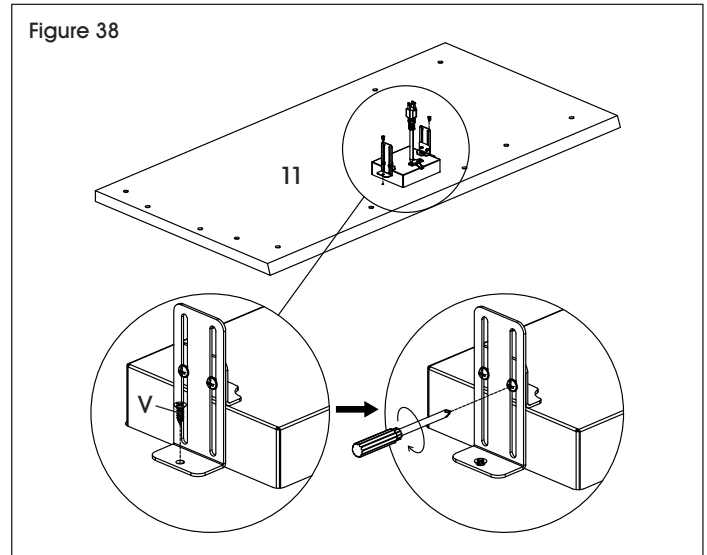

24. With a second person, place the return desktop (11) on the return frame and pedestal file (15). Attach the connector plate (Q) in between the desktop (1) and return desktop (11) with eight M6 x 15 mm bolts (F). (See Figure 39)

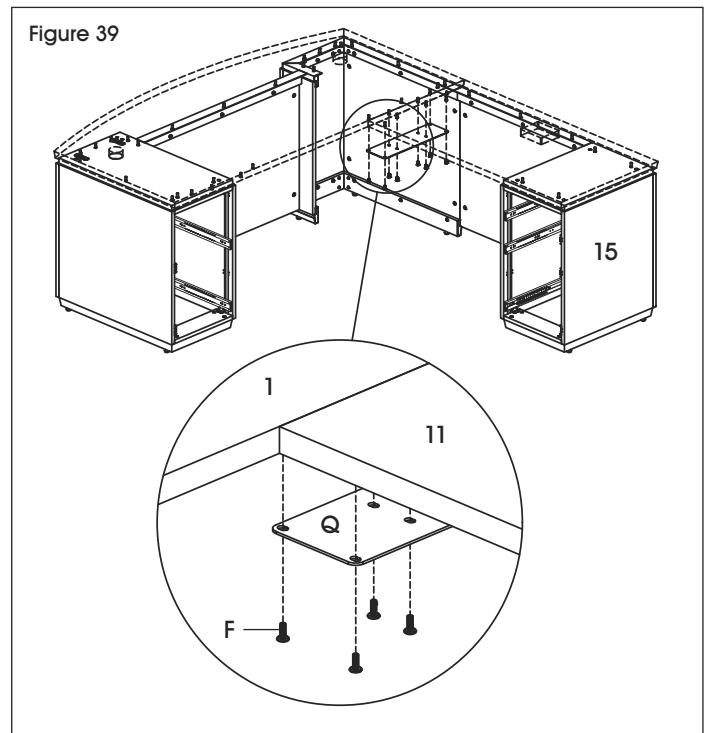

## L-DESK ASSEMBLY CONTINUED

25. Attach return pedestal file (15) to the return desktop (11) using four M6 x 55 mm bolts and washers (M). (See Figure 40)

Figure 40

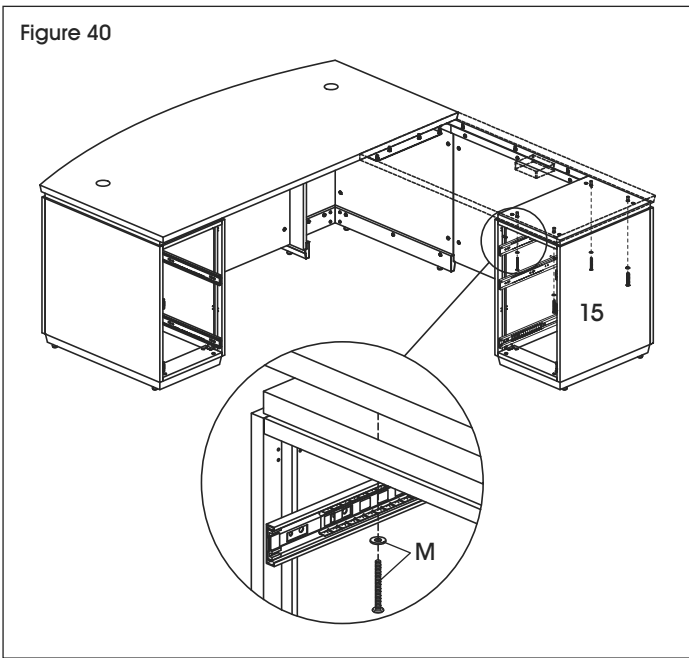

26. Attach modesty panel trim (3), half leg top trim (9), and return modesty panel trim (13) to the desktop (1) and return desktop (11) using 14 M6 x 15 mm bolts (F). (See Figure 41)

Figure 41

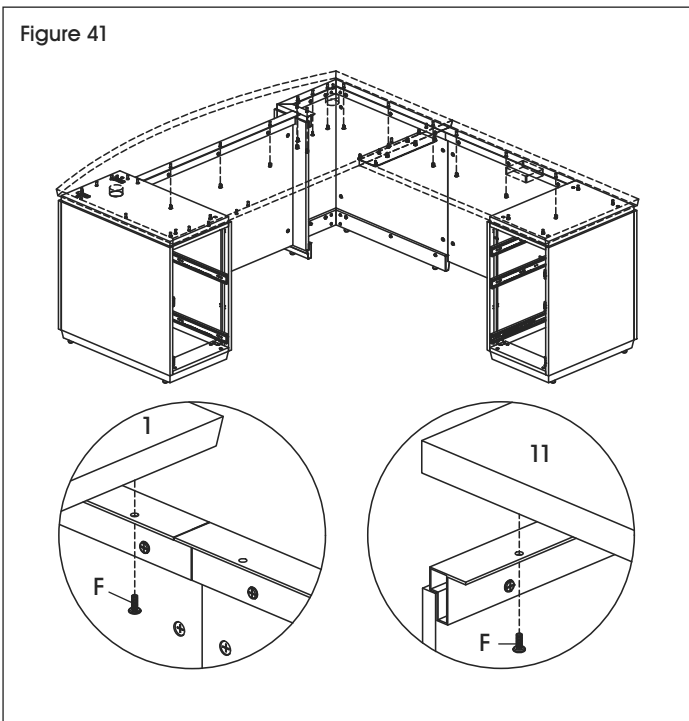

27. Install desktop grommets (A) into desktop (1). Apply cam lock caps (E) for a finished look. (See Figure 42)

Figure 42

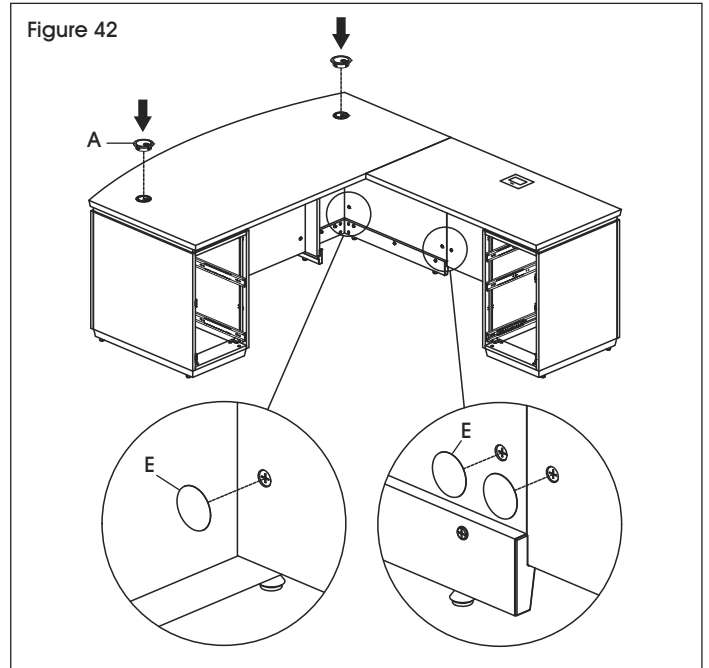

28. Reinstall drawers into the pedestal file (4) and return pedestal file (15). (See Figure 43)

Figure 43

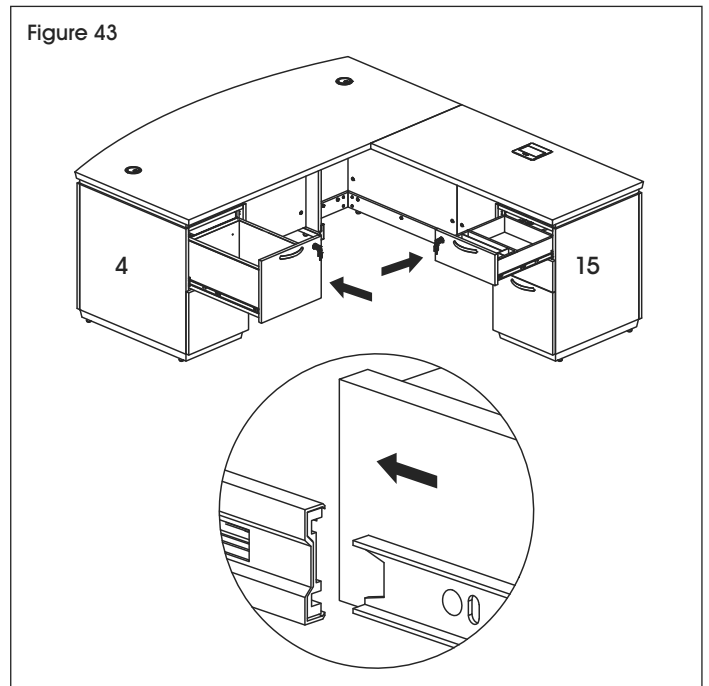

## L-DESK ASSEMBLY CONTINUED

29. In each file drawer, attach file clips (O) to both sides of drawer and insert metal bar (N). (See Figure 44)

Figure 44

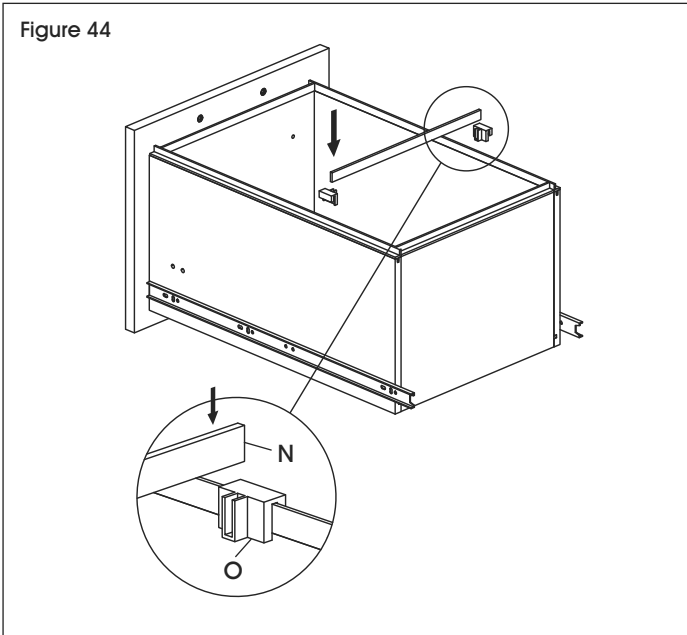

30. Place cable clips (W) in desired location to neatly organize cables underneath the desktop. Cable clips can be attached using adhesive or ST4 x 16 mm screws (X). (See Figure 45)

Figure 45

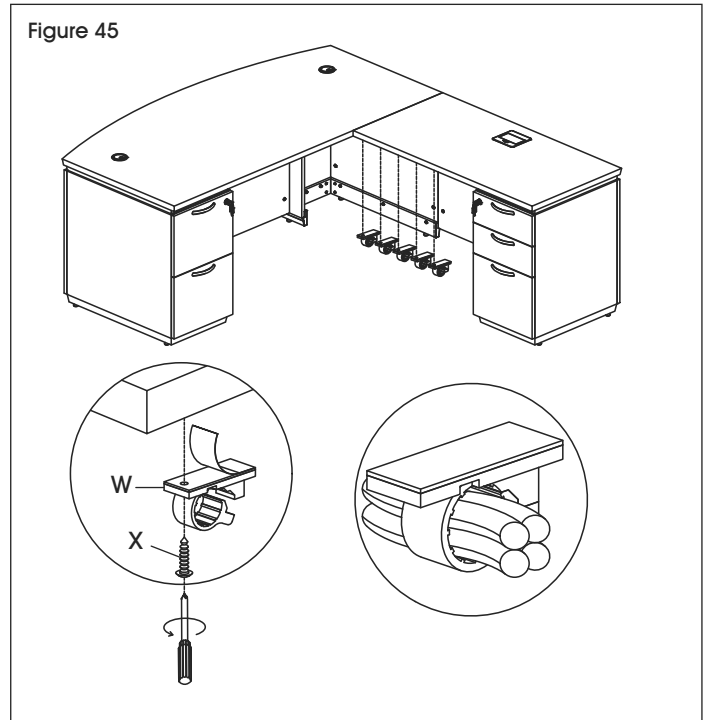

Assembly Complete

# ESCRITORIO EJECUTIVO DE OFICINA

## HERRAMIENTAS NECESARIAS

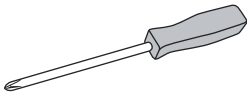

Desarmador de Cruz



Llave Allen (incluida)



Se recomienda Armar Entre Dos Personas

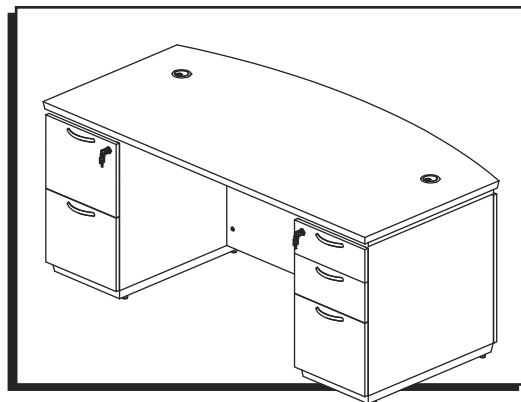

## PARTES DEL ESCRITORIO

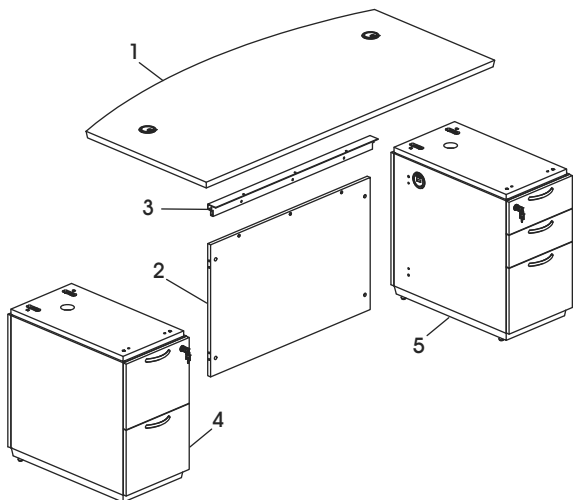

#	DESCRIPCIÓN	CANT.
1	Cubierta	1
2	Recato Laminado	1
3	Moldura del Recato	1
4	Archivero de Pedestal – 2 Cajones	1
5	Archivero de Pedestal – 3 Cajones	1

**NOTA:** Si ensambla un Escritorio en L, pase a la página 22.

**NOTA:** Apriete todos los pernos, tornillos, pasadores para tuercas minifix y tuercas minifix utilizando un desarmador de cruz.

**NOTA:** El ensamble muestra el escritorio con frente curvado. Los escritorios rectangulares se ensamblan de la misma forma.

## TORNILLERÍA PARA ESCRITORIO

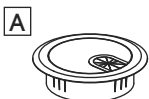

2 Ojales para Cubierta

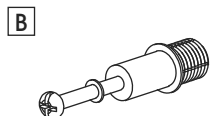

4 Pasadores para Tuercas Minifix



4 Tuercas Minifix

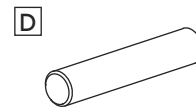

4 Taquetes



4 Tapas para Tuercas Minifix

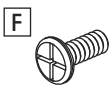

3 Pernos M6 x 15 mm

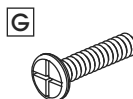

3 Pernos M6 x 25 mm



4 Ojales para Pedestal



5 Asas  
10 Pernos M4 x 22 mm

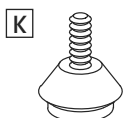

8 Tapas Niveladoras



4 Pernos de Tope

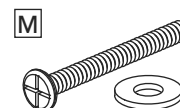

4 Pernos M6 x 55 mm  
4 Rondanas

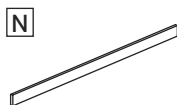

3 Barra de Metal

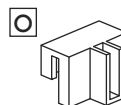

6 Clips para Archivo



# ENSAMBLE DEL ESCRITORIO



Si ensambla un Escritorio en L, pase a la página 22.



**NOTA:** Ensamble la unidad sobre una superficie lisa que no deje marcas para evitar rayones. Verifique los cajones y los paquetes para asegurarse de que todas las partes y tornillería estén incluidas.

1. Retire las asas preinstaladas (I) del interior de los archiveros de pedestal (4,5). Alinee los orificios del asa con los que están fuera del cajón. Fije utilizando dos pernos M4 x 22 mm (I). Repita la operación con los cajones restantes. (Vea Diagrama 1)

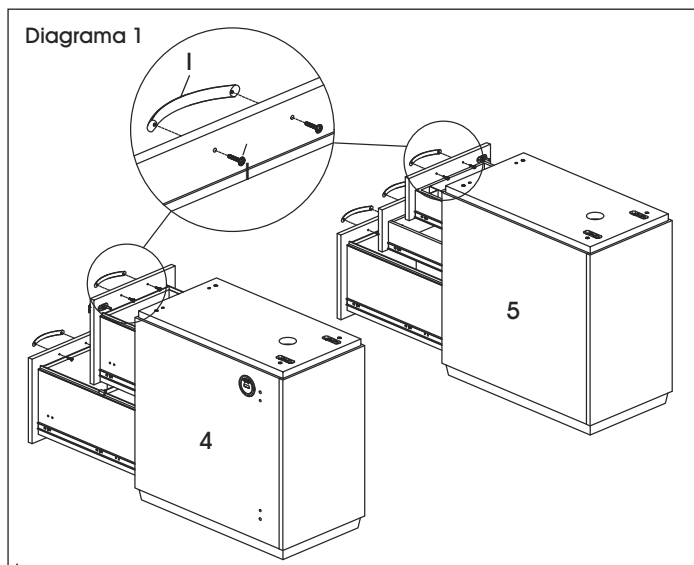

2. Con la ayuda de otra persona, coloque los archiveros de pedestal (4,5) boca abajo. Instale cuatro tapas niveladoras (K) en el panel inferior de cada archivero de pedestal. Coloque los archiveros de pedestal en posición vertical. (Vea Diagrama 2)

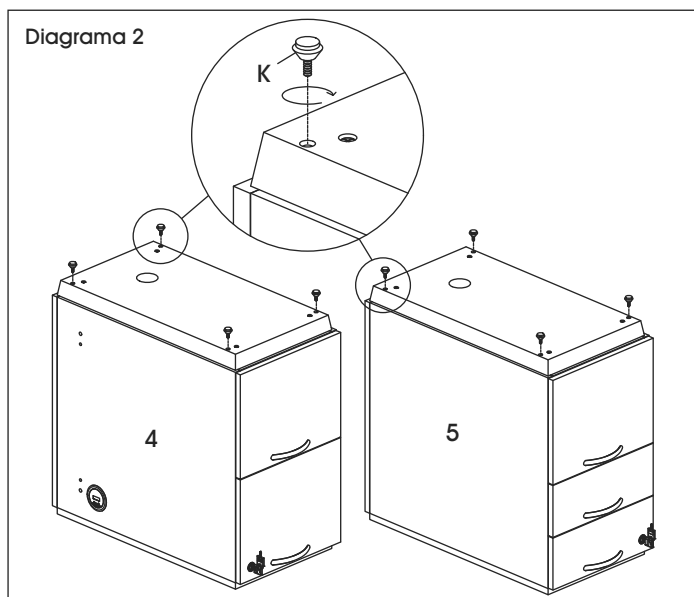

3. Instale dos pasadores para tuercas minifix (B) en el lateral del archivero de pedestal de 2 cajones (4). Repita en el archivero de pedestal de 3 cajones (5). (Vea Diagrama 3)



**¡IMPORTANTE!** Los pasadores para tuercas minifix (B) se deben apretar una vez se hayan insertado en el panel. Para apretarlos, sostenga la parte inferior del pasador y apriete con el desarmador de cruz.



Diagrama 3

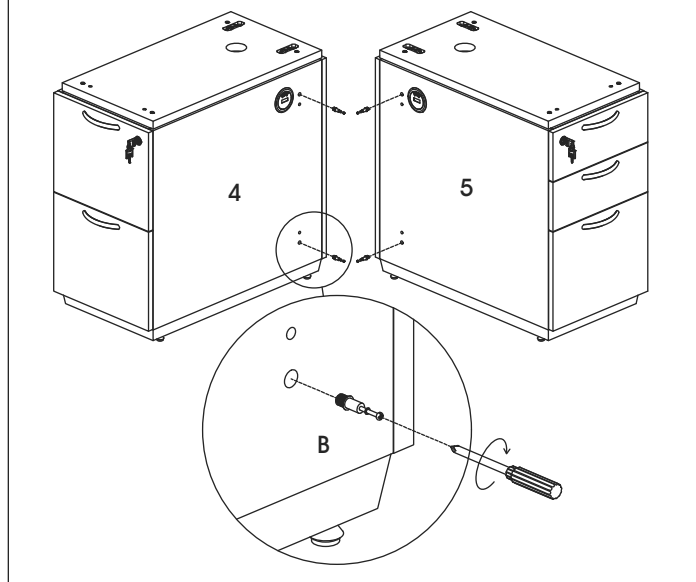

4. Instale cuatro tuercas minifix (C) en los orificios del recato laminado (2). Inserte dos taquetes (D) en cada borde lateral del recato laminado. (Vea Diagrama 4)



**¡IMPORTANTE!** Asegúrese de que la flecha apunte hacia el borde del panel antes de introducirla en el orificio del panel. Gire la tuerca minifix  $\frac{1}{4}$  a la derecha para asegurarla.

Función de la Tuerca Minifix





Diagrama 4

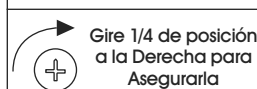
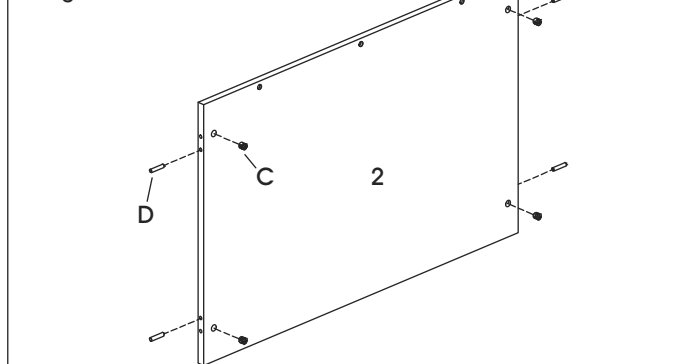

## CONTINUACIÓN DEL ENSAMBLE DEL ESCRITORIO

5. Con la ayuda de otra persona, conecte el recato laminado (2) entre los archiveros de pedestal (4,5). Apriete las tuercas minifix (C). (Vea Diagrama 5)

 **NOTA:** Puede colocar las tapas de las tuercas minifix (E) después de apretar las tuercas para darle una apariencia terminada.

 **NOTA:** El archivero de pedestal de 2 cajones estará en el lado izquierdo del recato laminado. El de 3 cajones estará en el lado derecho.

Diagrama 5



6. Fije la moldura del recato (3) al borde superior del recato laminado (2) con tres pernos M6 x 25 mm (G). (Vea Diagrama 6)

Diagrama 6

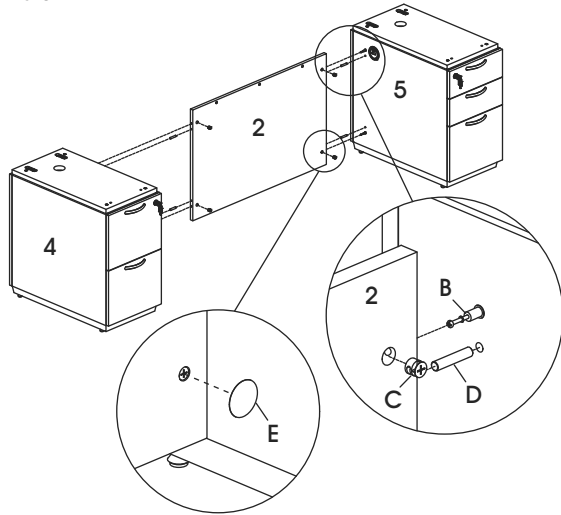
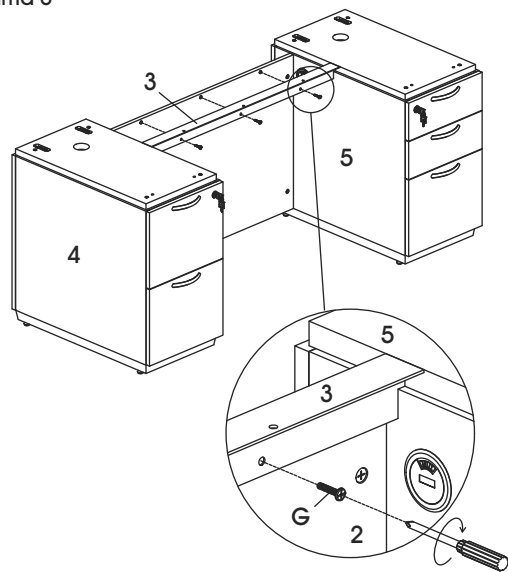

7. Retire todos los cajones de ambos archiveros de pedestal (4,5). (Vea Diagrama 7)

 **NOTA:** Para retirar los cajones, abra cada cajón y localice las pestañas de los deslizadores. Presione la pestaña izquierda mientras eleva la pestaña derecha y extraiga el cuerpo del cajón del gabinete.

Diagrama 7



8. Entre dos personas, coloquen el escritorio ensamblado (1) boca abajo con los orificios prerroscaados hacia arriba. Instale cuatro pernos de tope (L) en los orificios prerroscaados negros. (Vea Diagrama 8)

Diagrama 8

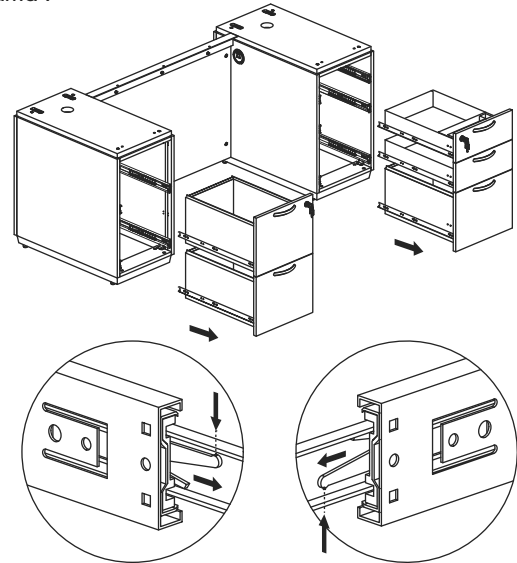
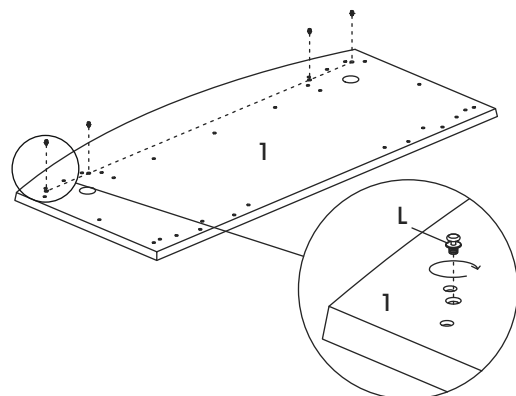

## CONTINUACIÓN DEL ENSAMBLE DEL ESCRITORIO

9. Con la ayuda de una segunda persona, levante la cubierta (1) y alinee los pernos de tope (L) con los soportes ranurados en cada archivero de pedestal (4,5). Coloque la cubierta con cuidado sobre los archiveros de pedestal. (Vea Diagrama 9)

Diagrama 9

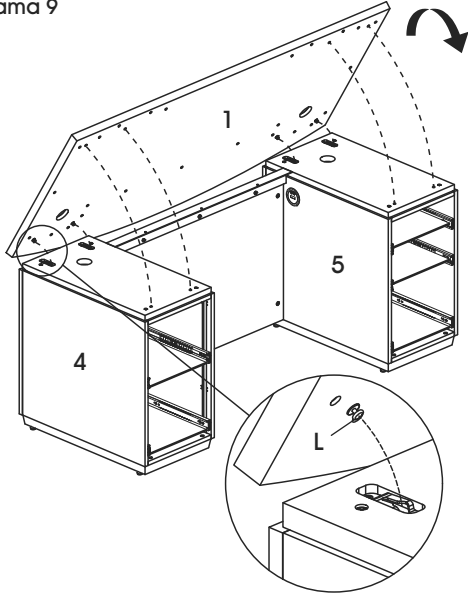

10. Empuje la cubierta con cuidado (1) hacia la parte posterior de los archiveros de pedestal (4,5) para asegurar los pernos de tope (L) en su lugar. (Vea Diagrama 10)



**NOTA:** La cubierta se debe desplazar alrededor de 3/4" hacia la parte posterior de los archiveros de pedestal.

Diagrama 10

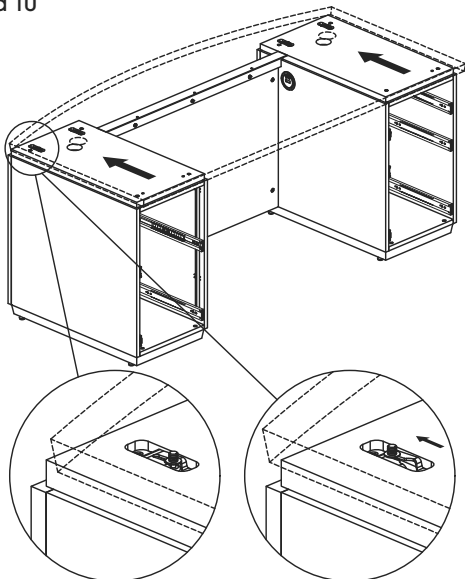

11. Conecte la cubierta (1) al frente de los archiveros de pedestal (4,5) utilizando cuatro pernos M6 x 55 mm y cuatro rondanas (M). (Vea Diagrama 11)

Diagrama 11

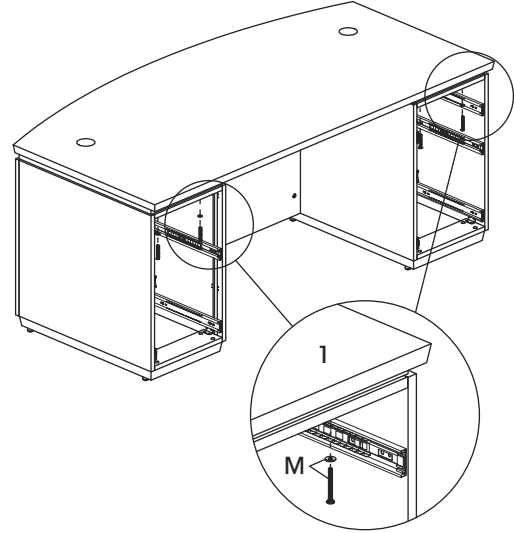

12. Fije la moldura del recato (3) a la cubierta (1) con tres pernos M6 x 15 mm (F). (Vea Diagrama 12)

Diagrama 12

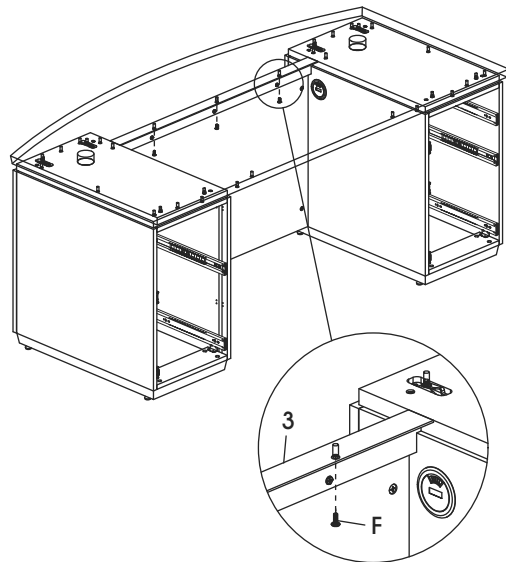

## CONTINUACIÓN DEL ENSAMBLE DEL ESCRITORIO

13. Vuelva a instalar los cajones en cada archivero de pedestal (4,5) e inserte los ojales para cubierta (A). (Vea Diagrama 13)

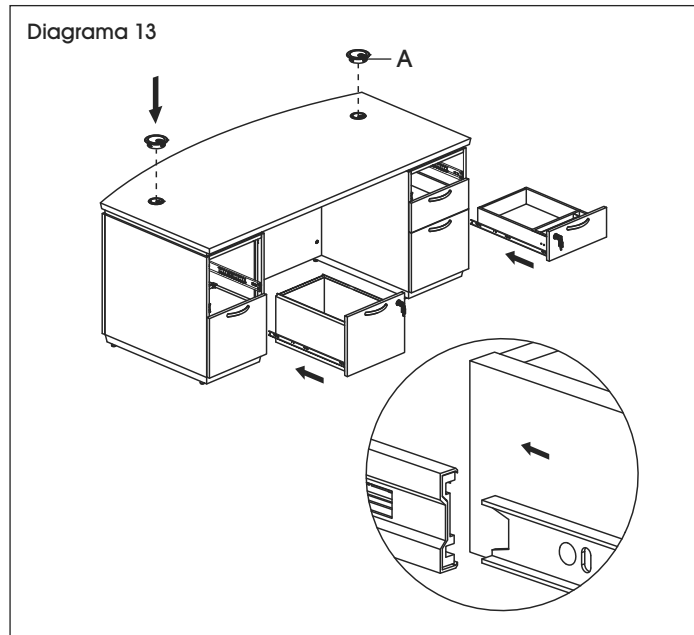

14. En cada cajón de archivero, fije los clips para archivo (O) en ambos lados del cajón inferior e inserte la barra de metal (N). (Vea Diagrama 14)

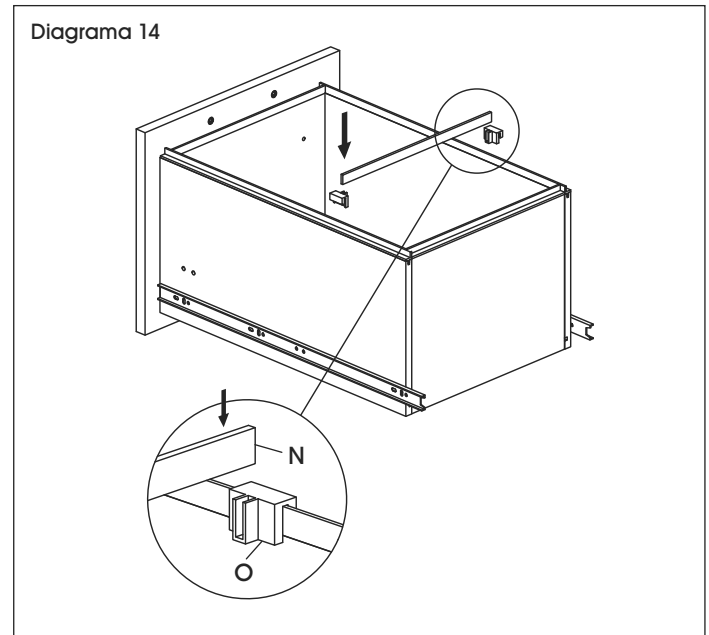

Ensamble Terminado

## PARTES DEL ESCRITORIO EN L

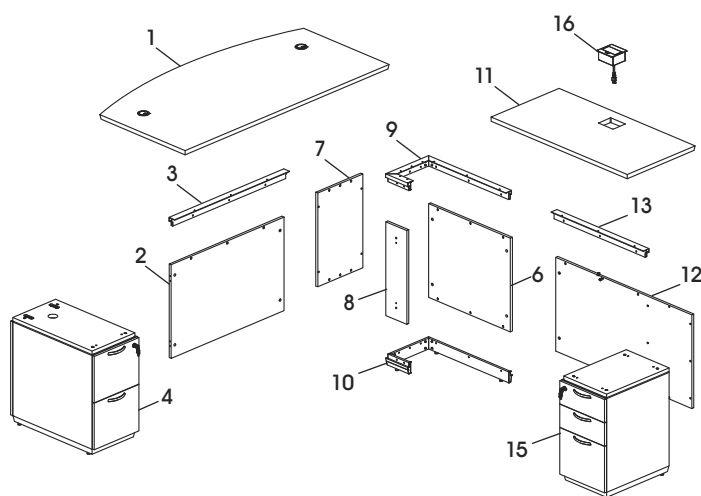

El Retorno para Diestros se muestra arriba

#	DESCRIPCIÓN	CANT.
1	Cubierta	1
2	Recato Laminado	1
3	Moldura del Recato	1
4	Archivero de Pedestal – 2 Cajones (Escritorio en L para Diestros)	1
6	Panel Lateral	1
7	Panel Posterior	1
8	Panel Lateral Interior	1
9	Moldura Superior de Media Pata	1
10	Moldura Inferior de Media Pata	1
11	Cubierta del Retorno para Escritorio	1
12	Recato del Retorno	1
13	Moldura del Recato del Retorno	1
15	Archivero de Pedestal del Retorno – 3 Cajones (Escritorio en L para Diestros)	1
16	Multicontacto de Retorno	1
	Archivero de Pedestal – 3 Cajones (Escritorio en L para Zurdos) (No Se Muestra)	1
	Archivero de Pedestal del Retorno – 2 Cajones (Escritorio en L para Zurdos) (No Se Muestra)	1

# TORNILLERÍA PARA ESCRITORIO EN L

A



2 Ojales para Cubierta

B

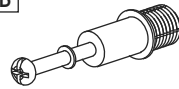

16 Pasadores para Tuercas Minifix

C



20 Tuercas Minifix

D

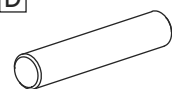

4 Taquetes

E



20 Tapas para Tuercas Minifix

F



22 Pernos M6 x 15 mm

G

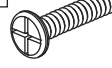

22 Pernos M6 x 25 mm

H



4 Ojales para Pedestal

I

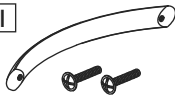

5 Asas  
10 Pernos M4 x 22 mm

K

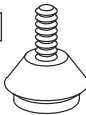

11 Tapas Niveladoras

L



2 Pernos de Tope

M

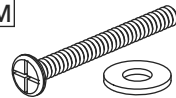

6 Pernos M6 x 55 mm  
6 Rondanas

N

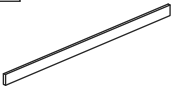

3 Barras de Metal

O



6 Clips para Archivo

P

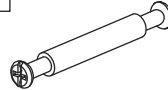

2 Pasadores para Tuercas Minifix de Doble Extremo

Q

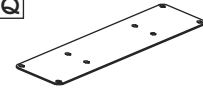

1 Placa Conectora

R

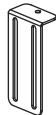

2 Soportes en L

S



2 Soportes Chicos

T



4 Tornillos M4 x 10

U



4 Pernos M3 x 8

V



2 Tornillos ST3.5 x 12

W

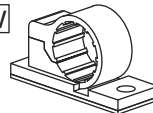

5 Sujetadores para Cables

X



5 Tornillos ST4 x 16 mm



**NOTA:** Las siguientes instrucciones muestran un Escritorio con Frente Curvado y Retorno para Diestros.



**NOTA:** Apriete todos los pernos, tornillos, pasadores para tuercas minifix y tuercas minifix utilizando un desarmador de cruz.



**NOTA:** Si está ensamblando un escritorio en L para zurdos, el archivero de pedestal para el escritorio principal será de 3 cajones y el pedestal de retorno será de 2 cajones.



**NOTA:** Ensamble la unidad sobre una superficie lisa que no deje marcas para evitar rayones. Verifique los cajones y los paquetes para asegurarse de que todas las partes y tornillería estén incluidas.

# ENSAMBLE DEL ESCRITORIO EN L

**NOTA:** Para la configuración del Escritorio en L para Zurdos, fije los archiveros de pedestal y los componentes del retorno en el lado opuesto de la cubierta.

1. Retire las asas preinstaladas (I) del interior del archivero de pedestal de 2 cajones (4) y archivero de pedestal del retorno (15). Alinee los orificios en el exterior del cajón con los orificios del asa. Fije utilizando dos pernos M4 x 22 mm (I). Repita la operación para otros cajones. (Vea Diagrama 15)

Diagrama 15

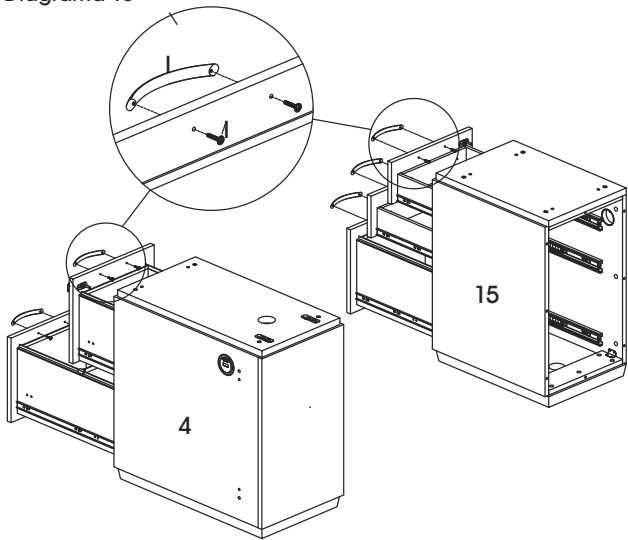

2. Con la ayuda de otra persona, voltee los archiveros de pedestal (4,15) boca abajo. Instale cuatro tapas niveladoras (K) en cada archivero de pedestal. Coloque los archiveros de pedestal en posición vertical. (Vea Diagrama 16)

Diagrama 16

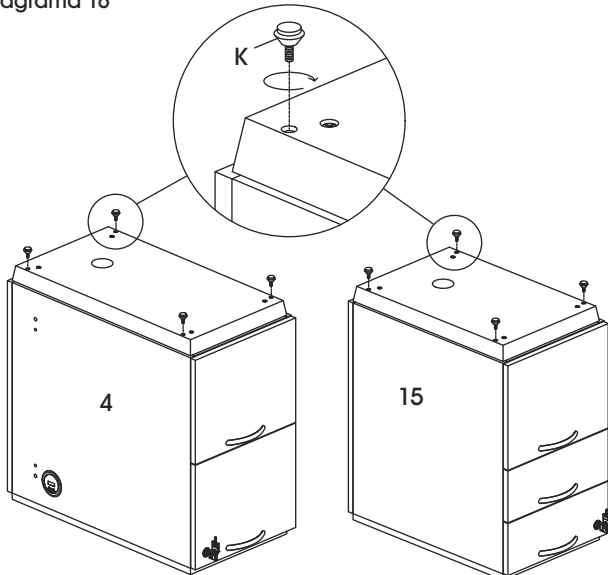

3. Instale cuatro pasadores para tuercas minifix (B) en el panel posterior (7). Instale cuatro tuercas minifix (C) en el panel lateral (6) y el panel lateral interior (8). Fije el panel lateral y el panel lateral interior al panel posterior. (Vea Diagrama 17)

Diagrama 17

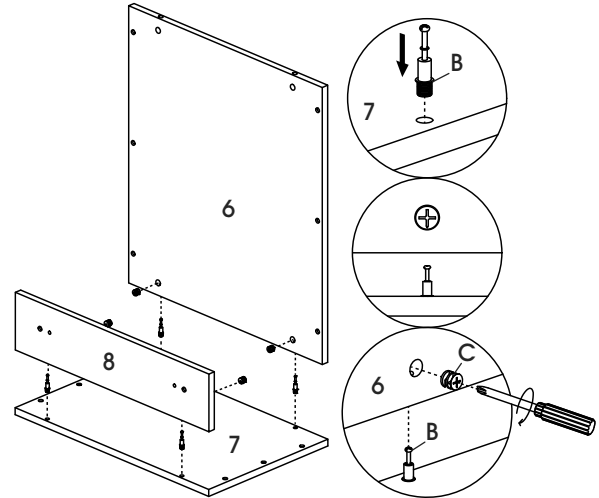

**¡IMPORTANTE!** Asegúrese de que la flecha apunte hacia el borde del panel antes de insertarla en el orificio del panel. Gire la tuerca minifix 1/4 a la derecha para asegurarla.

Función de la Tuerca Minifix

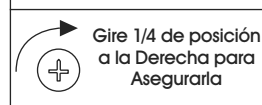

**¡IMPORTANTE!** Los pasadores para tuercas minifix (B) se deben apretar una vez se hayan insertado en el panel. Para apretarlos, sostenga la parte inferior del pasador y apriete con el desarmador de cruz.

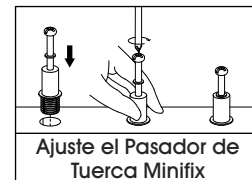

# ENSAMBLE DEL ESCRITORIO EN L

- Fije la moldura inferior de media pata (10) al borde inferior de los paneles de media pata utilizando ocho pernos M6 x 25 mm (G). Instale tres tapas niveladoras (K) en la moldura inferior de media pata. (Vea Diagrama 18)

 **NOTA:** Si ensambla una configuración para zurdos, el panel lateral (6) estará en el lado derecho cuando los paneles se coloquen boca abajo.

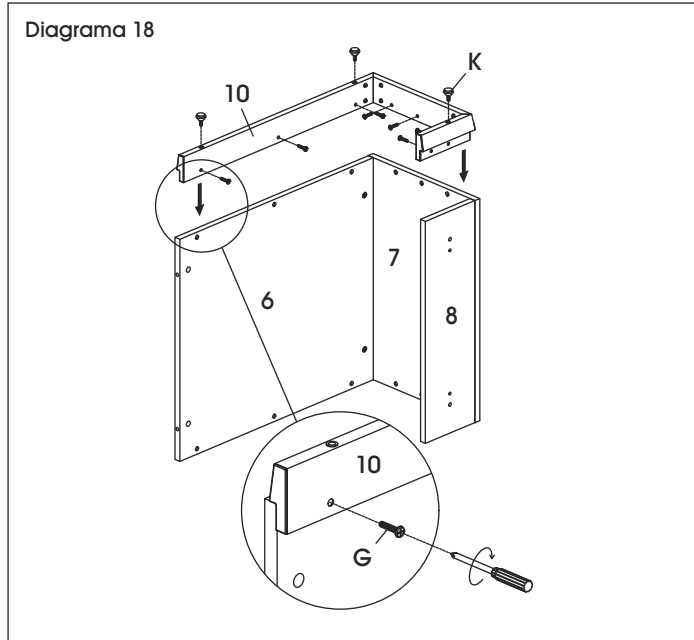

- Voltee la media pata sobre las tapas niveladoras. Inserte la moldura superior de media pata (9) utilizando ocho pernos M6 x 25 mm (G). (Vea Diagrama 19)

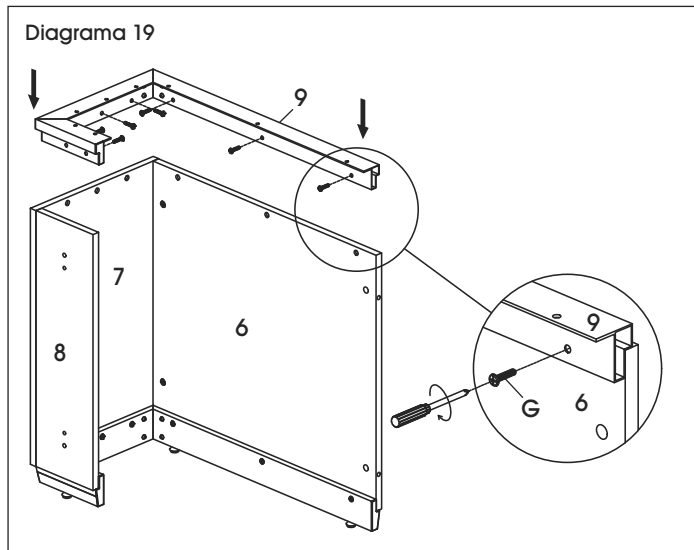

- Retire todos los cajones de ambos archiveros de pedestal (4,15). (Vea Diagrama 20)

 **NOTA:** Para retirar los cajones, localice las pestañas de los deslizadores. Presione la pestaña izquierda mientras eleva la pestaña derecha y extraiga el cuerpo del cajón del gabinete.

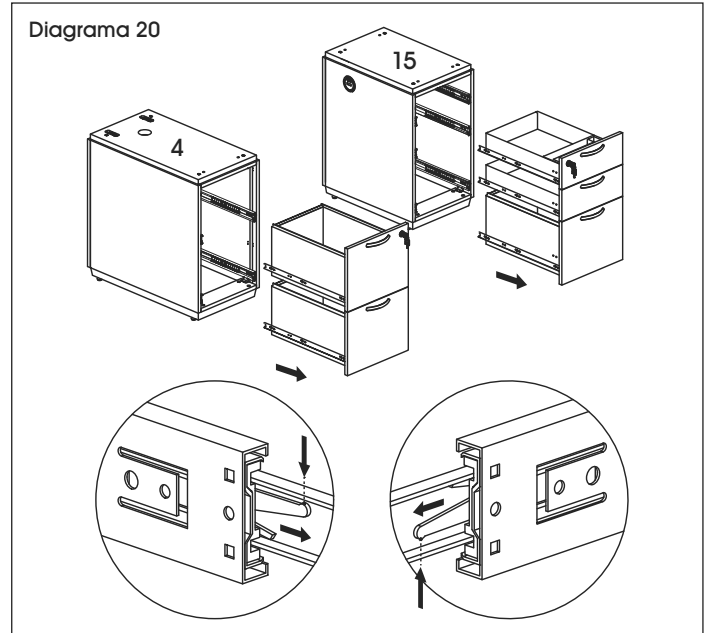

- Instale dos pasadores de tuerca minifix (B) en el panel interior del archivero de pedestal de 2 cajones (4) y el panel lateral interior (8) de la media pata. (Vea Diagrama 21)

 **NOTA:** Si ensambla el Escritorio en L para Zurdos, se utilizará el archivero de pedestal de 3 cajones.

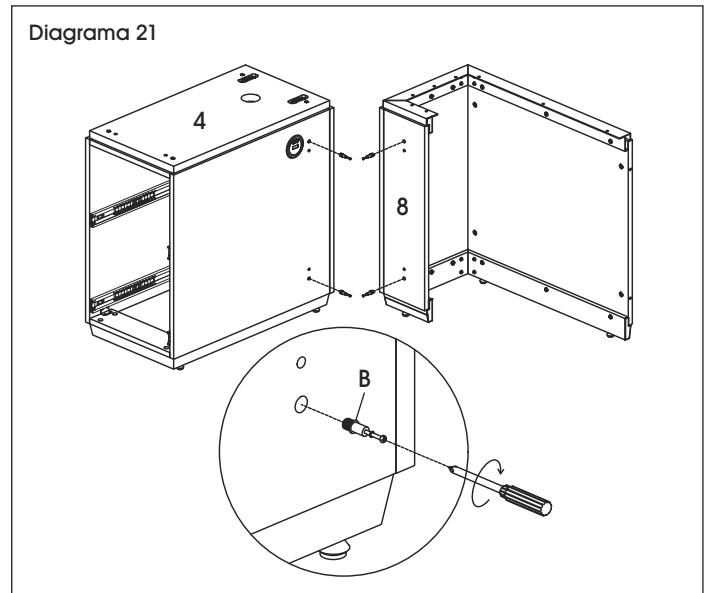

## CONTINUACIÓN DEL ENSAMBLE DEL ESCRITORIO EN L

8. Instale cuatro tuercas minifix (C) y cuatro taquetes (D) en los orificios del recato laminado (2). (Vea Diagrama 22)

Diagrama 22

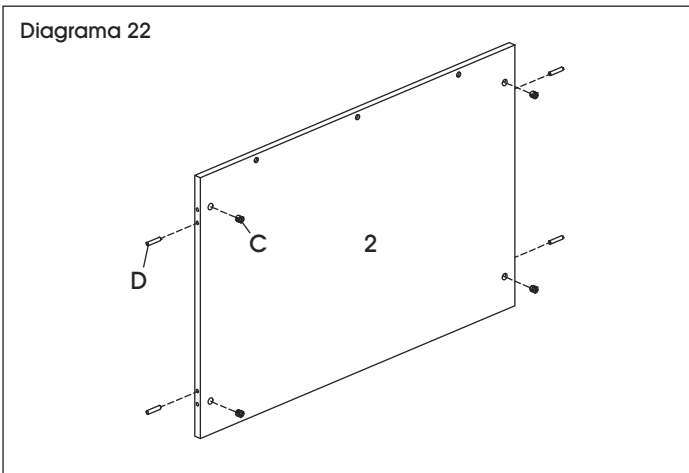

9. Con la ayuda de otra persona, conecte el recato laminado (2) entre los archiveros de pedestal de 2 cajones (4) y el panel lateral interior (8). Apriete las tuercas minifix (C). (Vea Diagrama 23)

Diagrama 23

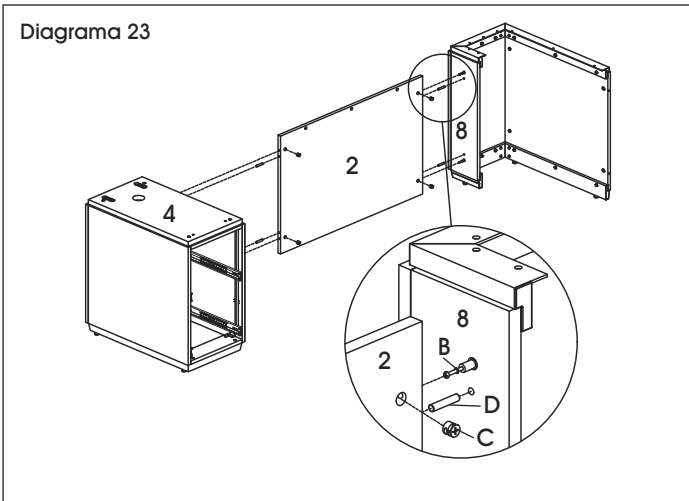

10. Fije la moldura del recato (3) al borde superior del recato laminado (2) con tres pernos M6 x 25 mm (G). (Vea Diagrama 24)

Diagrama 24

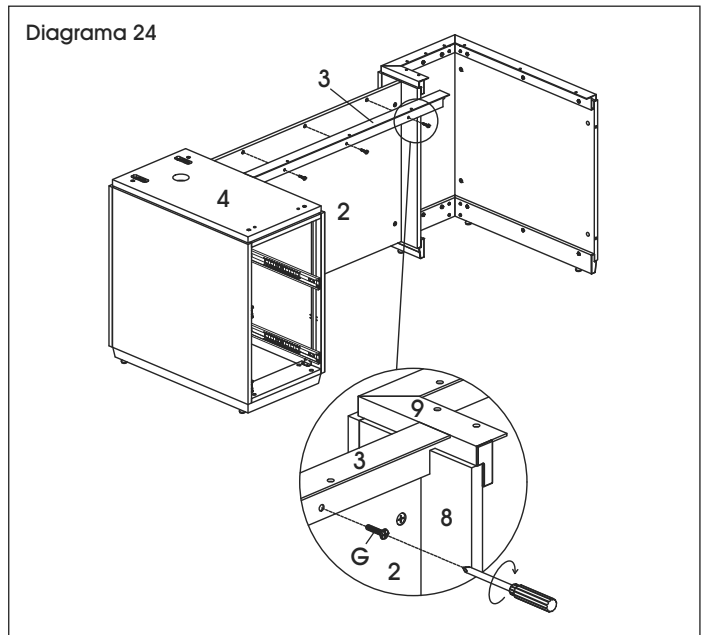

11. Instale ocho pasadores para tuercas minifix (B) en el recato del retorno (12). (Vea Diagrama 25)

Diagrama 25

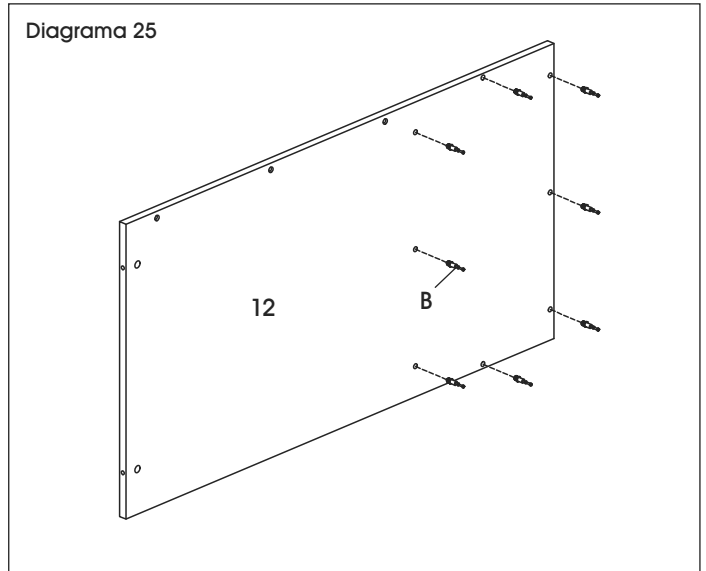



## CONTINUACIÓN DEL ENSAMBLE DEL ESCRITORIO EN L

12. Instale ocho tuercas minifix (C) dentro del archivero de pedestal del retorno (15). (Vea Diagrama 26)

Diagrama 26

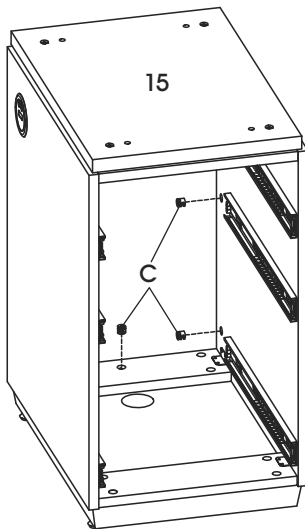

13. Fije el archivero de pedestal del retorno (15) al recato del retorno (12). Apriete las tuercas minifix (C) en el interior del archivero de pedestal del retorno. (Vea Diagramas 27-28)

Diagrama 27



Diagrama 28



14. Fije la moldura del recato (13) al borde superior del recato del retorno (12) con tres pernos M6 x 25 mm (G). (Vea Diagrama 29)

Diagrama 29

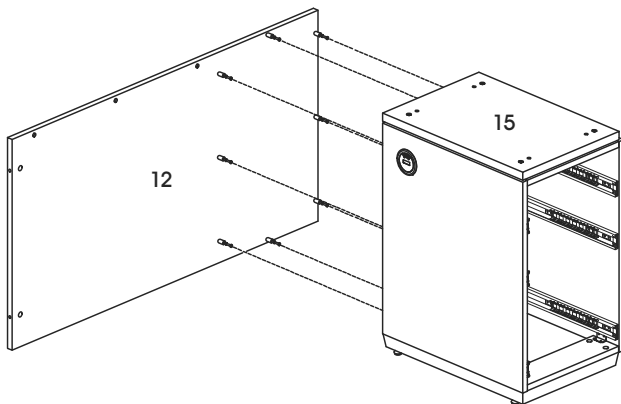
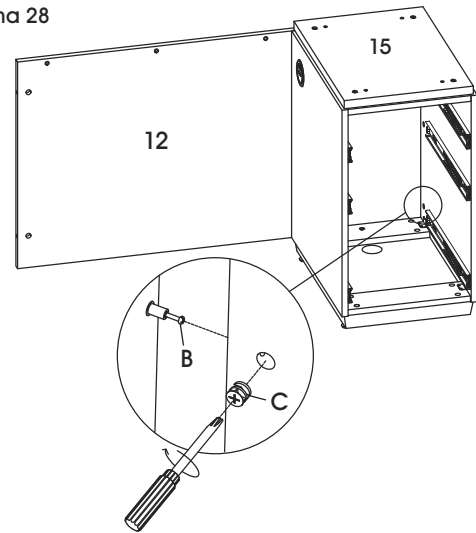
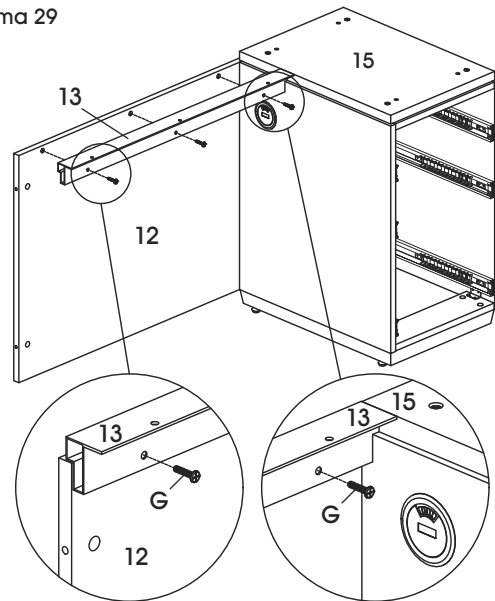

## CONTINUACIÓN DEL ENSAMBLE DEL ESCRITORIO EN L

**ALTO**

Coloque los componentes ensamblados en el lugar deseado.

15. Con la ayuda de otra persona, conecte el recato del retorno (12) al panel lateral (6) en la media pata utilizando dos pasadores para tuercas minifix de doble extremo (P) y cuatro tuercas minifix (C). (Vea Diagrama 30)

Diagrama 30

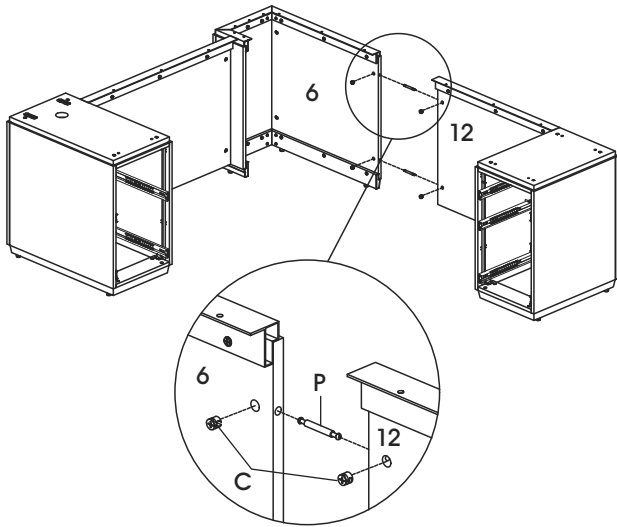

16. Con la ayuda de otra persona, coloque la cubierta (1) boca abajo. Los orificios prerroscados de la cubierta deben estar hacia arriba. Instale dos pernos de tope (L) en los orificios prerroscados negros en el lado derecho de la cubierta. (Vea Diagrama 31)



**NOTA:** Si ensambla la configuración para zurdos, instale los pernos de tope (L) en el lado izquierdo de la cubierta boca abajo (1).

Diagrama 31

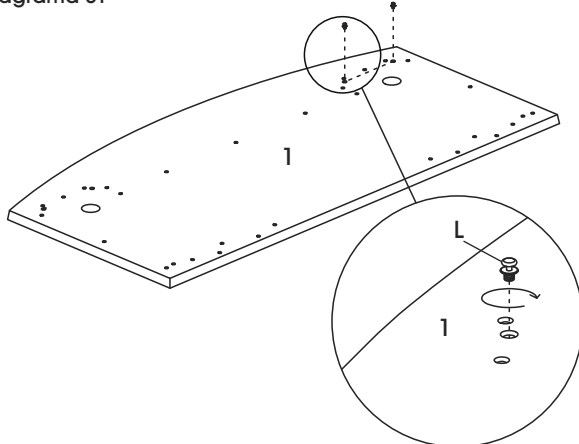

17. Con la ayuda de otra persona, levante la cubierta (1) y alinee con cuidado los pernos de tope (L) con los soportes ranurados en cada archivero de pedestal de 2 cajones (4). Coloque la cubierta sobre el armazón del escritorio ensamblado. (Vea Diagrama 32)

Diagrama 32

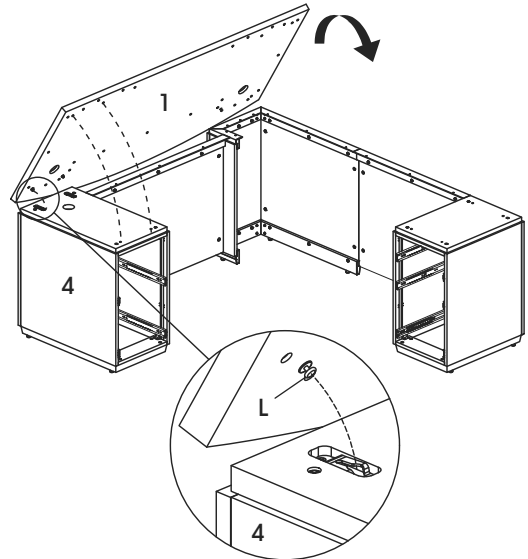

## CONTINUACIÓN DEL ENSAMBLE DEL ESCRITORIO EN L

18. Empuje la cubierta (1) con cuidado hacia la parte posterior del archivero de pedestal (4) y la media pata para asegurar los pernos de tope (L) en su lugar. (Vea Diagrama 33)

 **NOTA:** La cubierta se debe desplazar alrededor de 3/4" hacia la parte posterior del archivero de pedestal.

 **NOTA:** Los soportes ranurados están solo en un lado de la cubierta. Dé prioridad al lado que no incluye los soportes ranurados al empujar la cubierta.

Diagrama 33



19. Conecte la cubierta (1) al archivero de pedestal (4) utilizando dos pernos M6 x 55 mm y rondanas (M). (Vea Diagrama 34)

Diagrama 34

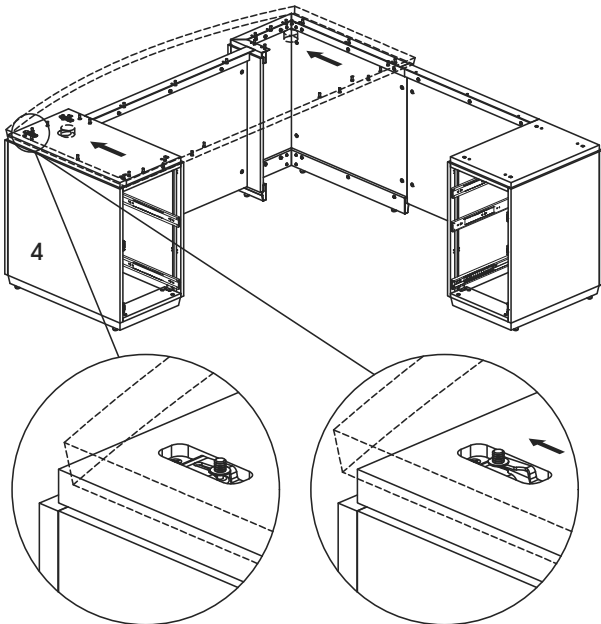
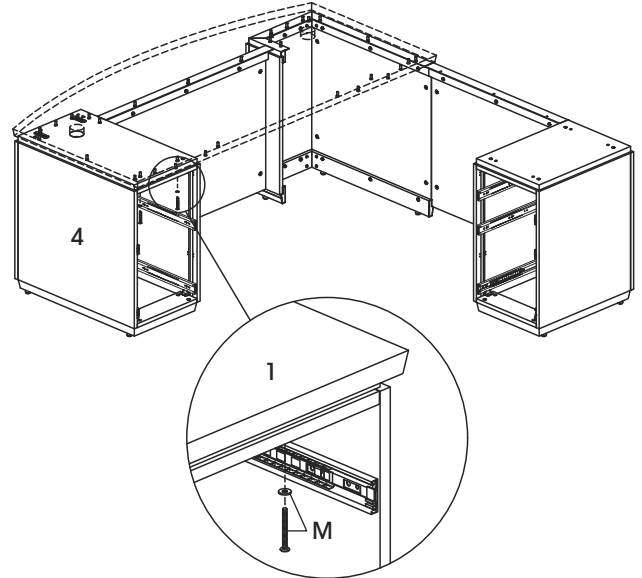

20. Inserte el multicontacto del retorno (16) en la cubierta del retorno (11). Con la ayuda de otra persona, voltee la cubierta del retorno boca abajo. (Vea Diagrama 35)

Diagrama 35

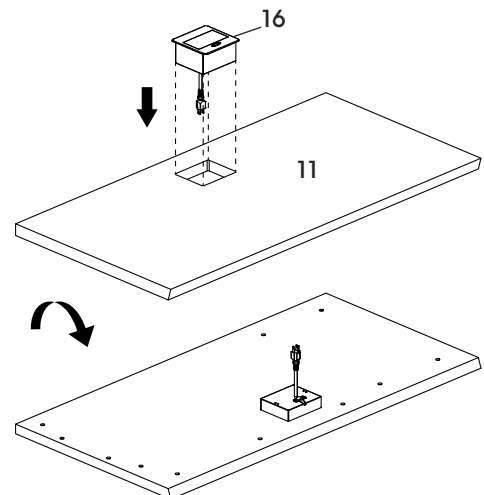

## CONTINUACIÓN DEL ENSAMBLE DEL ESCRITORIO EN L

21. Conecte sin apretar el Soporte en L (R) y el soporte chico (S) utilizando dos pernos M4 x 10 mm (T). Repita con el Soporte en L y soporte chico restantes. (Vea Diagrama 36)

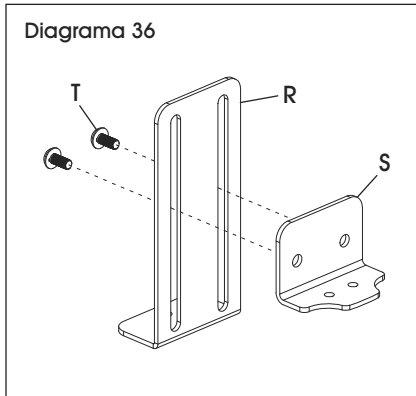

22. Fije los conectores ensamblados al lado inferior del multicontacto del retorno (16) utilizando cuatro pernos M3 x 8 mm (U). (Vea Diagrama 37)

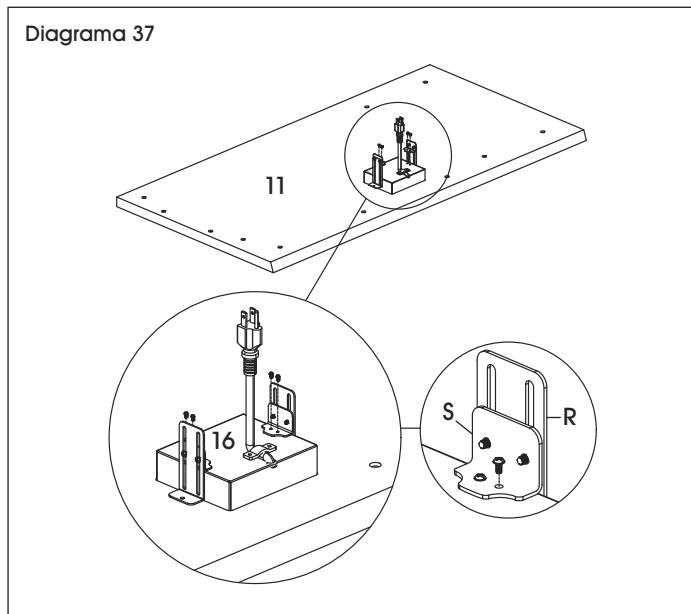

23. Fije ambos Soportes en L (R) a la cubierta del retorno (11) utilizando dos tornillos ST3.5 x 12 mm (V). Apriete por completo los pernos que conectan el Soporte en L y el soporte chico (S). (Vea Diagrama 38)

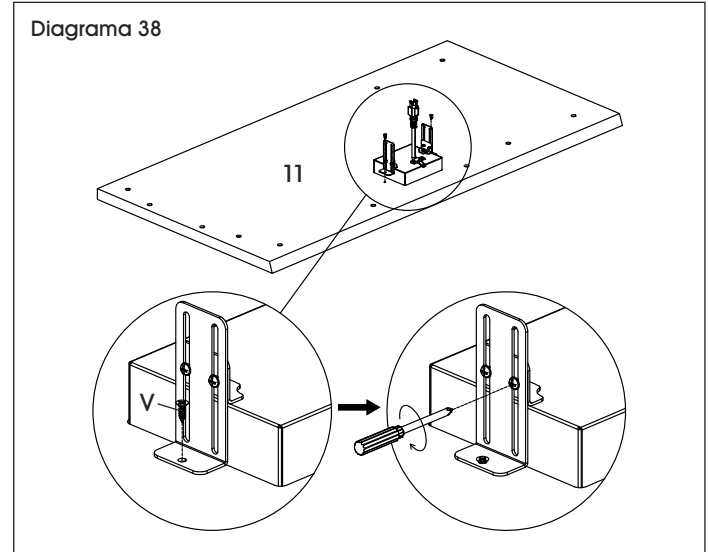

24. Con la ayuda de otra persona, coloque la cubierta del retorno (11) en el armazón del retorno y el archivero de pedestal (15). Fije la placa conectora (Q) entre la cubierta (1) y la cubierta del retorno (11) utilizando ocho pernos M6 x 15 mm (F). (Vea Diagrama 39)

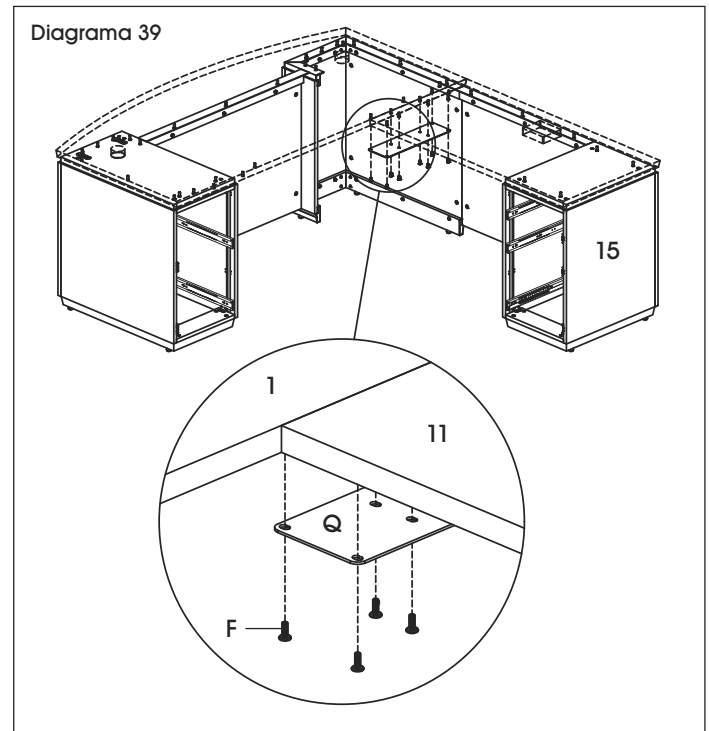

## CONTINUACIÓN DEL ENSAMBLE DEL ESCRITORIO EN L

25. Fije el archivero de pedestal del retorno (15) a la cubierta del retorno (11) utilizando cuatro pernos y rondanas M6 x 55 mm (M). (Vea Diagrama 40)

Diagrama 40

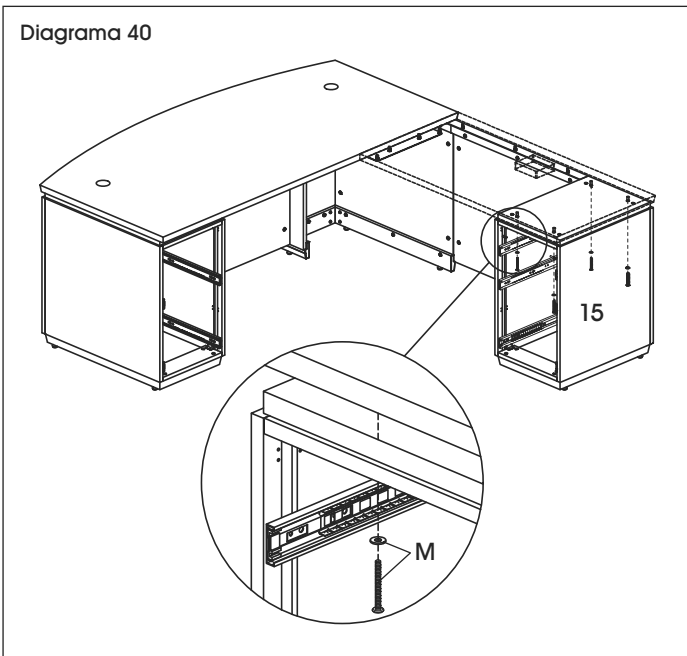

26. Fije la moldura del recato (3), la moldura superior de media pata (9) y la moldura del recato del retorno (13) a la cubierta (1) y la cubierta del retorno (11) utilizando 14 pernos M6 x 15 mm (F). (Vea Diagrama 41)

Diagrama 41

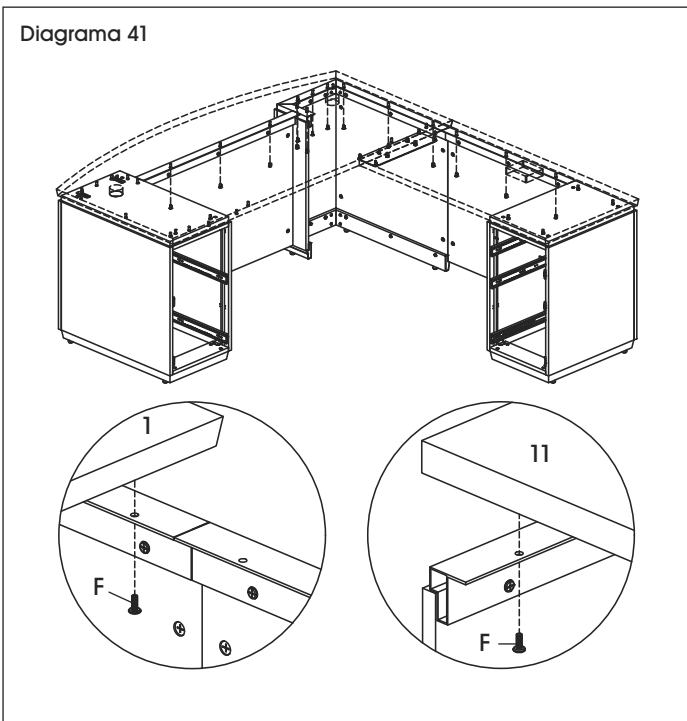

27. Instale los ojales de la cubierta (A) en la cubierta (1). Aplique las tapas de las tuercas minifix (E) para una apariencia terminada. (Vea Diagrama 42)

Diagrama 42

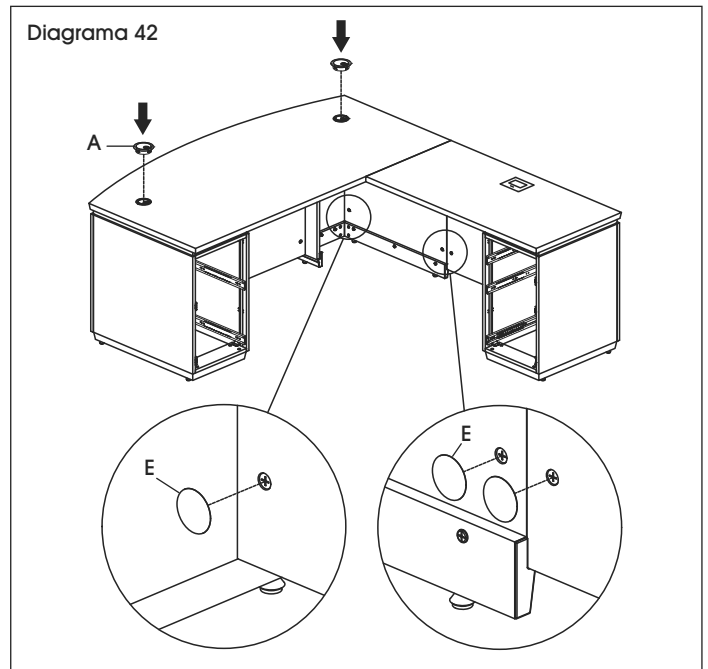

28. Vuelva a instalar los cajones en el archivero de pedestal de pata (4) y el archivero de pedestal del retorno (15). (Vea Diagrama 43)

Diagrama 43

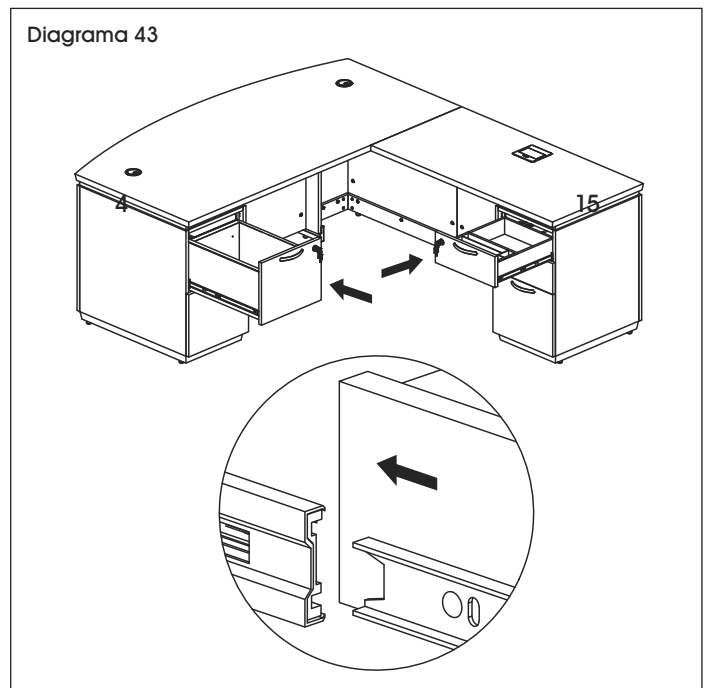

## CONTINUACIÓN DEL ENSAMBLE DEL ESCRITORIO EN L

29. En cada cajón de archivero, fije los clips para archivo (O) en ambos lados e inserte la barra de metal (N). (Vea Diagrama 44)

Diagrama 44

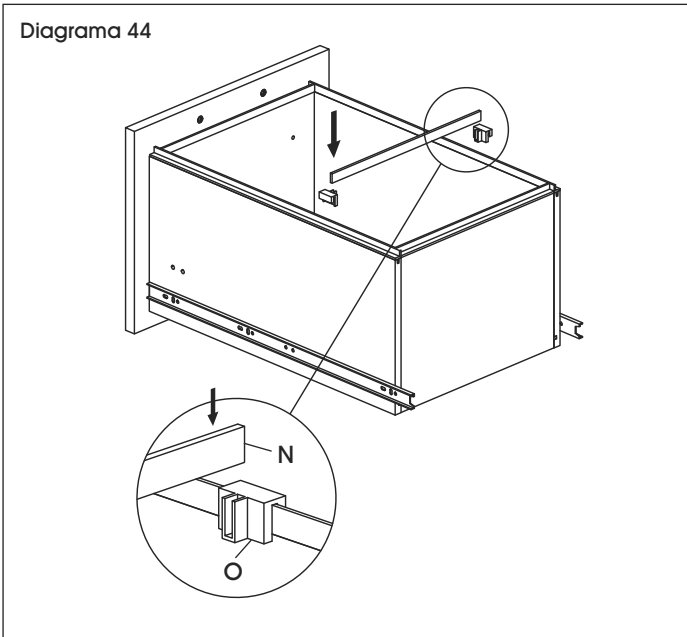

30. Coloque los sujetadores para cables (W) en la ubicación deseada para organizarlos debajo de la cubierta. Se pueden fijar utilizando adhesivo y tornillos ST4 x 16 mm (X). (Vea Diagrama 45)

Diagrama 45

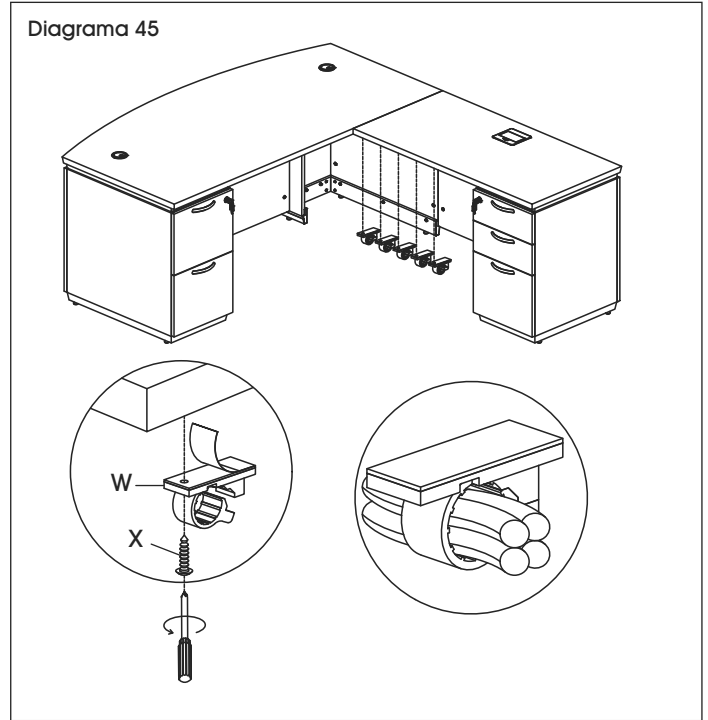

Ensamble Terminado

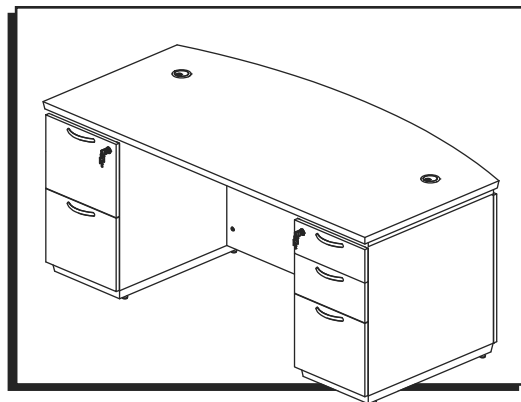

**OUTILS REQUIS**

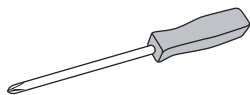

Tournevis cruciforme



Clé Allen  
(inclus)



Montage à deux  
personnes recommandé

**PIÈCES DU BUREAU**

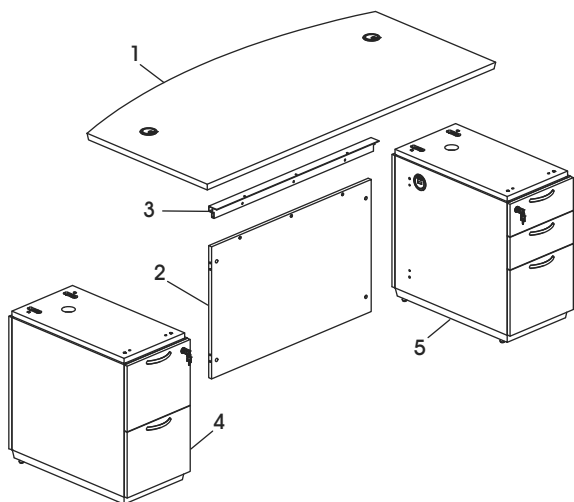

#	DESCRIPTION	QTÉ
1	Surface de bureau	1
2	Panneau cache-jambes stratifié	1
3	Garniture de panneau cache-jambes	1
4	Classeur à caisson – 2 tiroirs	1
5	Classeur à caisson – 3 tiroirs	1

**REMARQUE :** Si vous assemblez le bureau en L, passez à la page 35.

**REMARQUE :** Serrez tous les boulons, vis, goujons d'excentrique et excentriques à l'aide d'un tournevis cruciforme.

**REMARQUE :** L'illustration présente un bureau à devant arqué. Les bureaux rectangulaires sont montés de la même manière.

**MATÉRIEL D'INSTALLATION DU BUREAU**

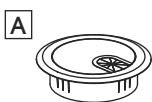

Passe-fil pour surface de bureau x 2

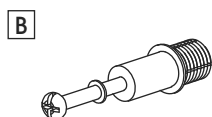

Goujon d'excentrique x 4

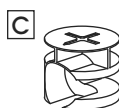

Excentrique x 4

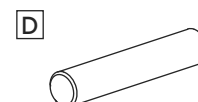

Cheville x 4



Cache pour excentrique x 4



Boulon M6 x 15 mm x 3



Boulon M6 x 25 mm x 3

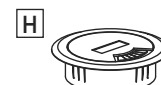

Passe-fil pour caisson x 4



Poignée x 5  
Boulon M4 x 22 mm x 10

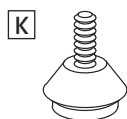

Patin réglable x 8

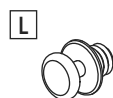

Boulon à épaulement x 4

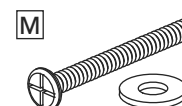

Boulon M6 x 55 mm x 4  
Rondelle x 4

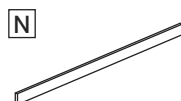

Barre métallique x 3

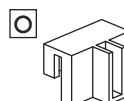

Attache pour classeur x 6

# MONTAGE DU BUREAU



Si vous assemblez le bureau en L, passez à la page 35.



**REMARQUE :** Montez le meuble sur une surface lisse qui ne marque pas afin d'éviter les rayures. Vérifiez les tiroirs et les emballages pour vous assurer que toutes les pièces et le matériel d'installation sont inclus.

1. Retirez les poignées préfixées (I) de l'intérieur des classeurs à caisson (4,5). Alignez les trous de l'une des poignées sur les trous à l'extérieur du tiroir. Fixez la poignée à l'aide de deux boulons M4 x 22 mm (I). Répétez l'opération pour les autres tiroirs. (Voir Figure 1)

Figure 1

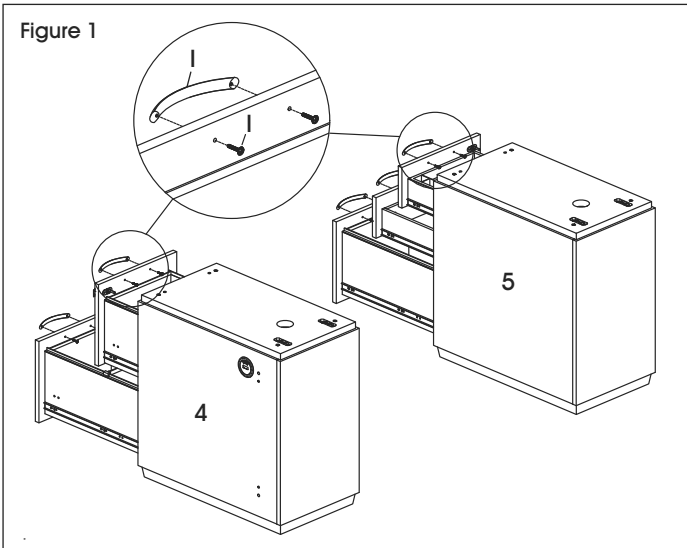

2. À deux, retournez avec précaution les classeurs à caisson (4,5). Installez quatre patins réglables (K) dans le panneau inférieur de chacun des classeurs à caisson. Placez les classeurs à caisson à l'endroit. (Voir Figure 2)

Figure 2

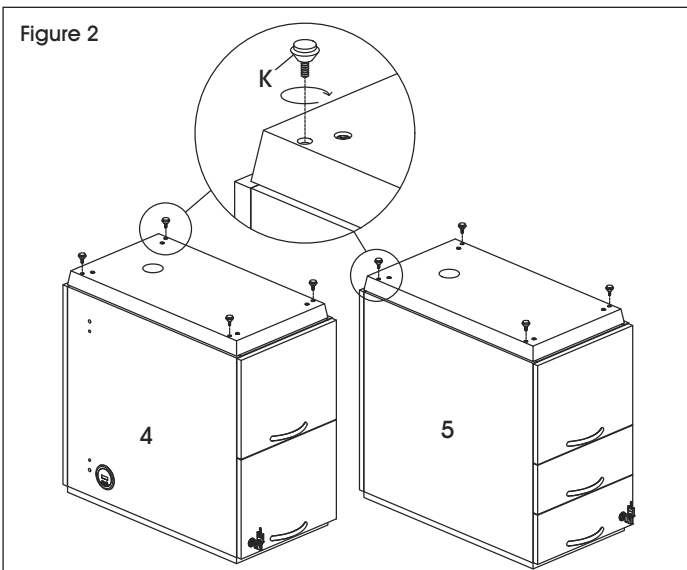

3. Installez deux goujons d'excentrique (B) sur le côté du classeur à caisson à 2 tiroirs (4). Répétez l'opération pour le classeur à caisson à 3 tiroirs (5). (Voir Figure 3)



**IMPORTANT!** Les goujons d'excentrique (B) doivent être serrés après insertion dans le panneau. Pour les serrer, saisissez la partie inférieure du goujon et serrez avec un tournevis cruciforme.

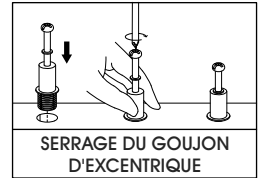
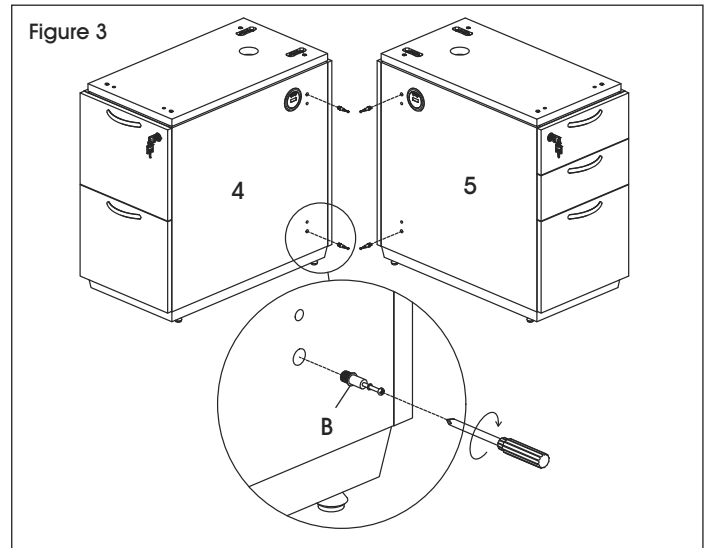

Figure 3



4. Installez quatre excentriques (C) dans les trous du panneau cache-jambes stratifié (2). Insérez deux chevilles (D) dans chacun des bords latéraux du panneau cache-jambes stratifié. (Voir Figure 4)



**IMPORTANT!** Vérifiez que la flèche pointe vers le bord du panneau avant d'insérer l'excentrique dans le trou du panneau. Tournez-le de  $\frac{1}{4}$  de tour vers la droite pour le verrouiller.

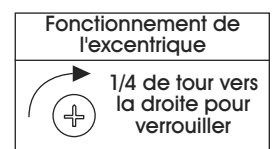
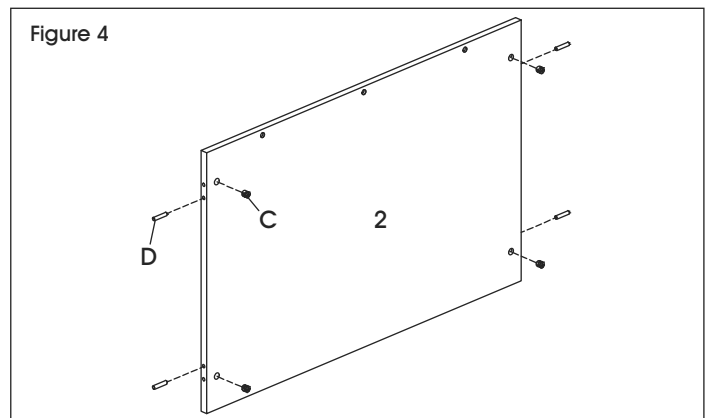



Figure 4





# MONTAGE DU BUREAU SUITE

5. À deux, fixez le panneau cache-jambes stratifié (2) entre les classeurs à caisson (4,5). Serrez les excentriques (C). (Voir Figure 5)

 **REMARQUE :** Une fois que les excentriques ont été serrés, les caches pour excentrique (E) peuvent être installés pour donner un aspect fini.

 **REMARQUE :** Le classeur à caisson à 2 tiroirs sera positionné sur le côté gauche du panneau cache-jambes stratifié. Le classeur à caisson à 3 tiroirs sera positionné sur le côté droit.

Figure 5



6. Fixez la garniture de panneau cache-jambes (3) sur le bord supérieur du panneau cache-jambes stratifié (2) au moyen de trois boulons M6 x 25 mm (G). (Voir Figure 6)

Figure 6

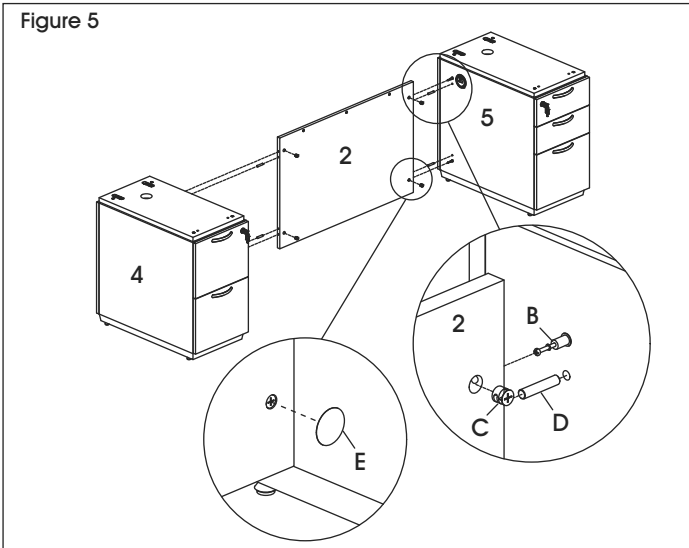
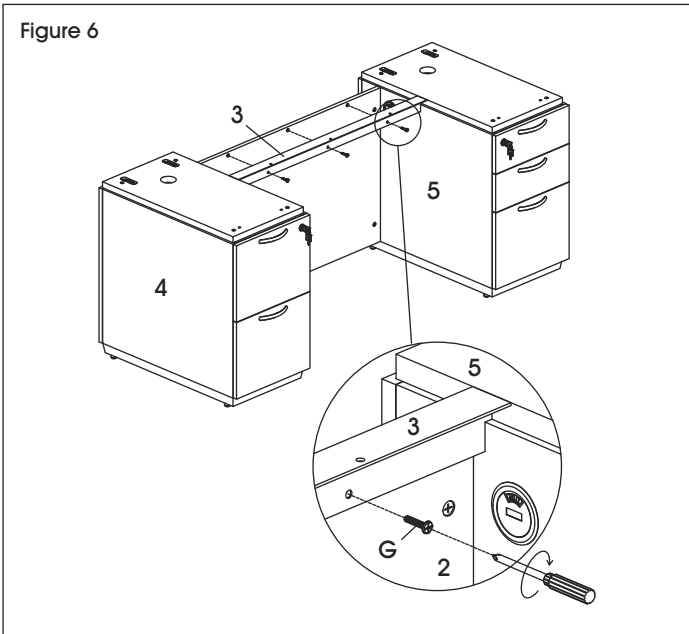

7. Retirez tous les tiroirs des deux classeurs à caisson (4,5). (Voir Figure 7)

 **REMARQUE :** Pour retirer les tiroirs, ouvrez-les complètement et repérez les languettes sur les glissières des tiroirs. En appuyant sur la languette gauche et en tirant la languette droite vers le haut, retirez le corps du tiroir du classeur.

Figure 7



8. À deux, placez la surface de bureau (1) à l'envers avec les trous préfiletés vers le haut. Installez quatre boulons à épaulement (L) dans les trous noirs préfiletés. (Voir Figure 8)

Figure 8

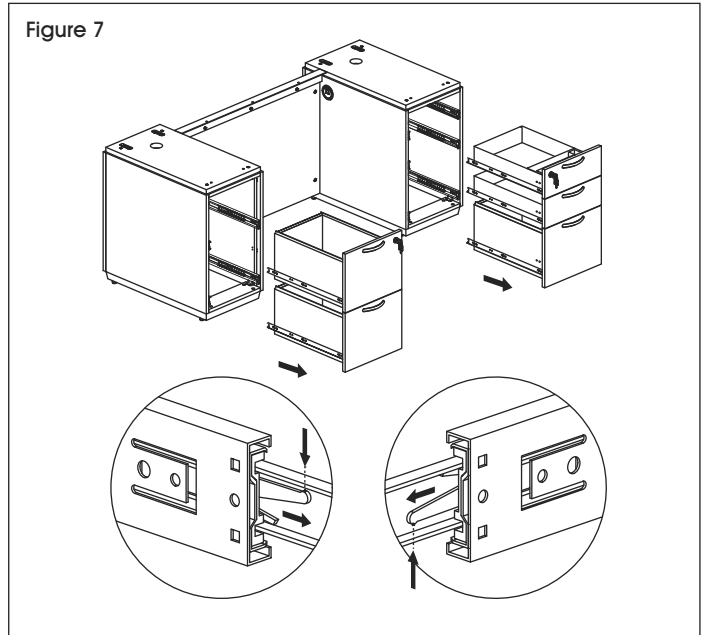
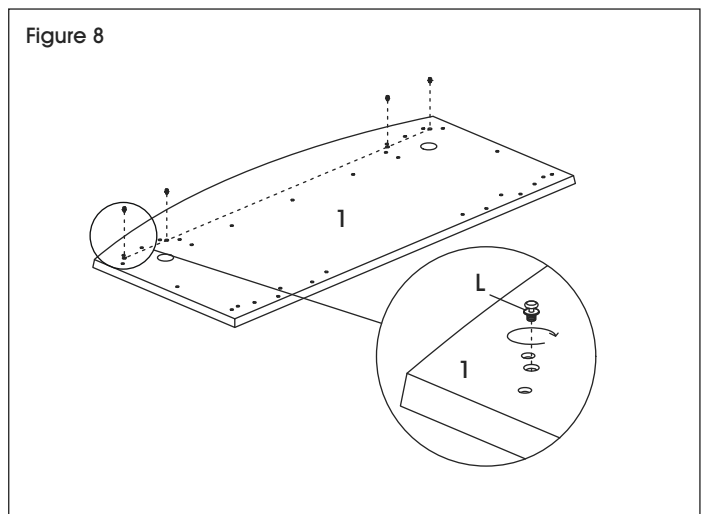

## MONTAGE DU BUREAU SUITE

9. À deux, soulevez la surface de bureau (1) et alignez les boulons à épaulement (L) avec les supports à fentes se trouvant dans chacun des classeurs à caisson (4,5). Abaissez avec précaution la surface de bureau sur les classeurs à caisson. (Voir Figure 9)

Figure 9

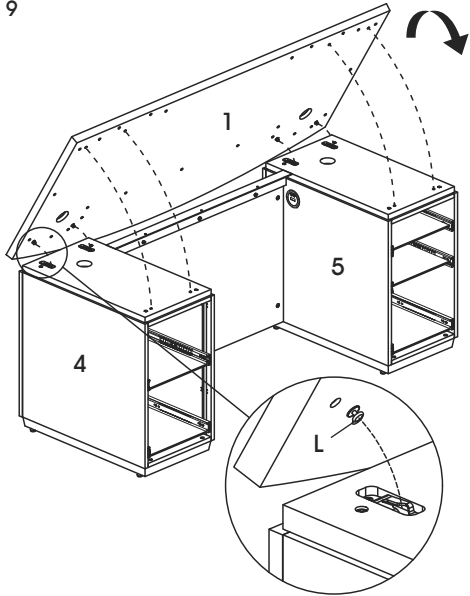

10. Poussez avec soin la surface de bureau (1) vers l'arrière des classeurs à caisson (4,5) pour verrouiller les boulons à épaulement (L) en place. (Voir Figure 10)

 **REMARQUE :** La surface de bureau doit être déplacée d'environ 3/4 po vers l'arrière des classeurs à caisson.

Figure 10



11. Fixez la surface de bureau (1) à l'avant des classeurs à caisson (4,5) à l'aide de quatre boulons M6 x 55 mm et de quatre rondelles (M). (Voir Figure 11)

Figure 11

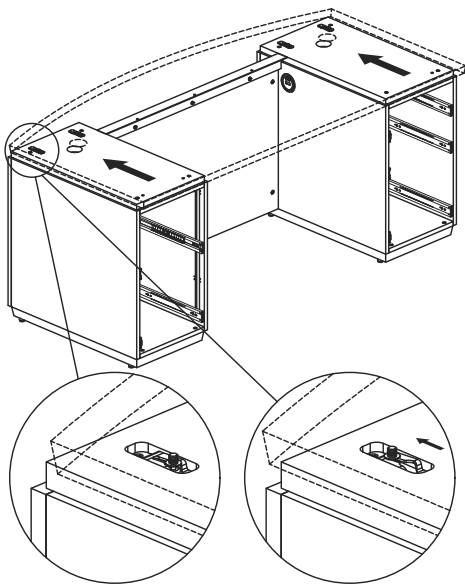
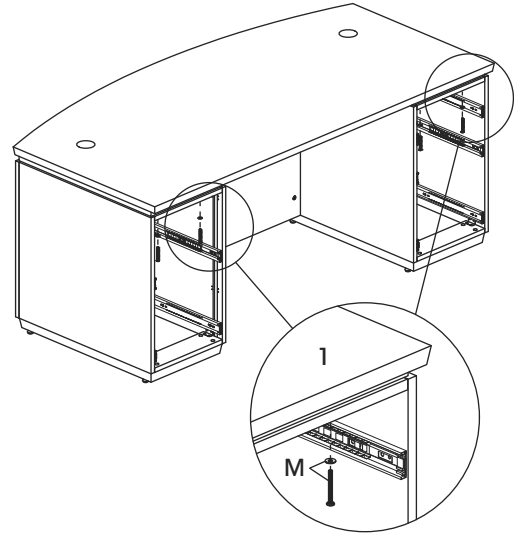

12. Fixez la garniture de panneau cache-jambes (3) sur la surface de bureau (1) au moyen de trois boulons M6 x 15 mm (F). (Voir Figure 12)

Figure 12

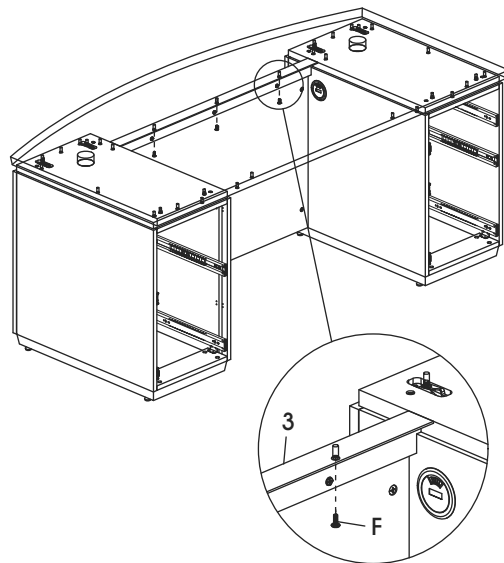

## MONTAGE DU BUREAU SUITE

13. Réinstallez les tiroirs dans chaque classeur à caisson (4,5) et insérez les passe-fils pour surface de bureau (A). (Voir Figure 13)

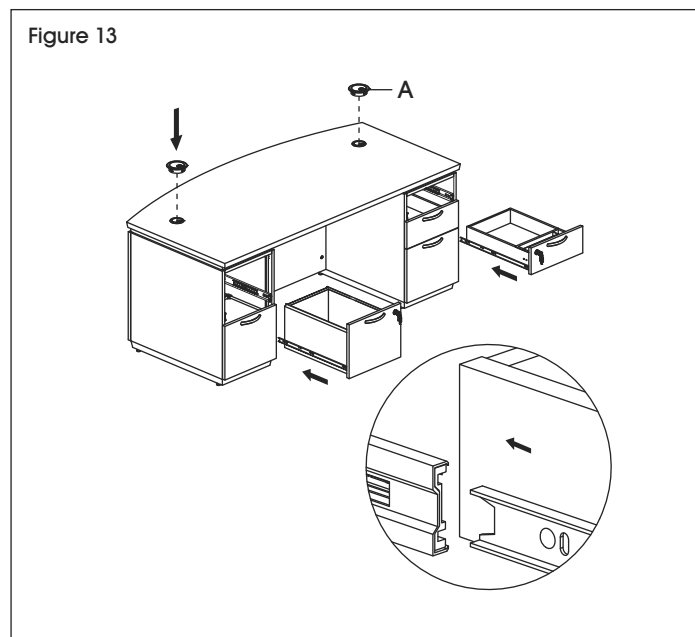

14. Dans chaque tiroir du classeur, fixez les attaches pour classeur (O) sur les deux côtés du tiroir et insérez la barre métallique (N). (Voir Figure 14)

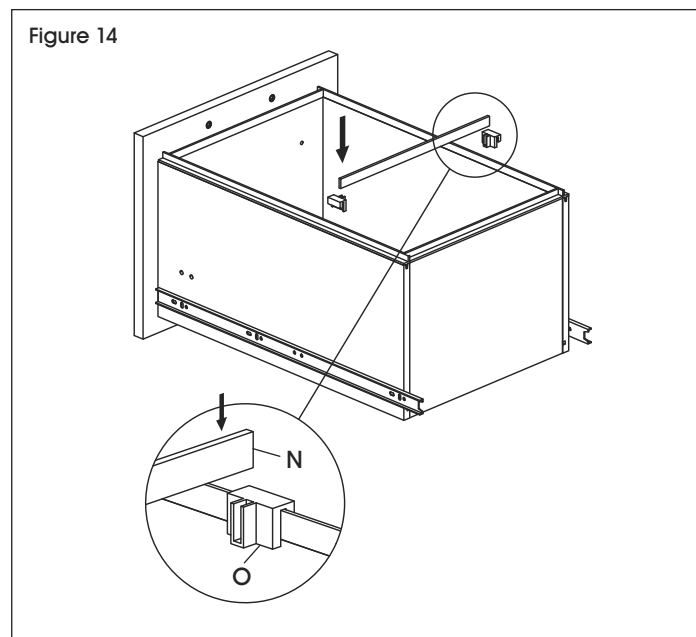

Montage terminé

## PIÈCES DU BUREAU EN L

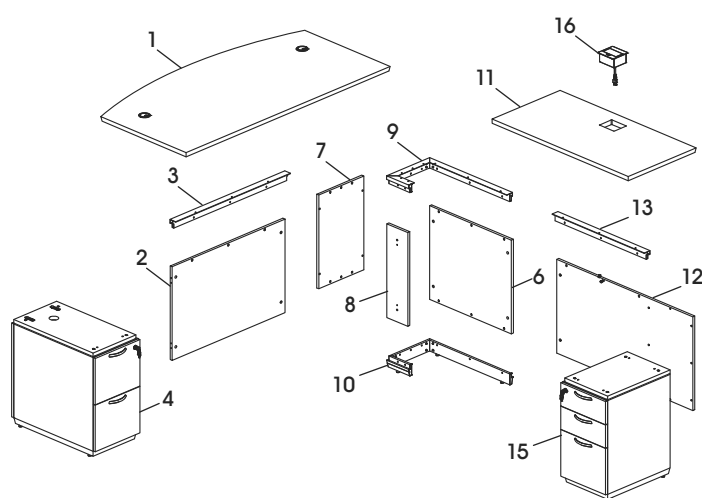

Retour avec configuration à droite illustré ci-dessus

#	DESCRIPTION	QTÉ
1	Surface de bureau	1
2	Panneau cache-jambes stratifié	1
3	Garniture de panneau cache-jambes	1
4	Classeur à caisson – 2 tiroirs (bureau en L avec configuration à droite)	1
6	Panneau latéral	1
7	Panneau arrière	1
8	Panneau latéral intérieur	1
9	Garniture supérieure de demi-pied	1
10	Garniture inférieure de demi-pied	1
11	Surface de bureau du retour	1
12	Panneau cache-jambes du retour	1
13	Garniture de panneau cache-jambes du retour	1
15	Classeur à caisson du retour – 3 tiroirs (bureau en L avec configuration à droite)	1
16	Système d'alimentation pour retour	1
	Classeur à caisson – 3 tiroirs (bureau en L avec configuration à gauche) (non illustré)	1
	Classeur à caisson du retour – 2 tiroirs (bureau en L avec configuration à gauche) (non illustré)	1

# MATÉRIEL DE BUREAU EN L

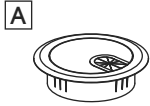

Passe-fil pour surface de bureau x 2

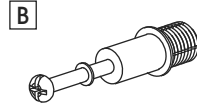

Goujon d'excentrique x 16

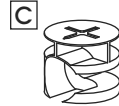

Excentrique x 20

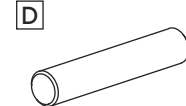

Cheville x 4



Cache pour excentrique x 20

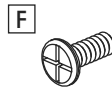

Boulon M6 x 15 mm x 22

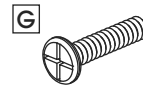

Boulon M6 x 25 mm x 22

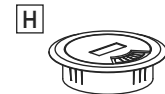

Passe-fil pour caisson x 4

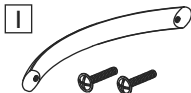

Poignée x 5  
Boulon M4 x 22 mm x 10

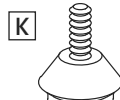

Patin réglable x 11

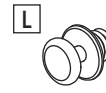

Boulon à épaulement x 2

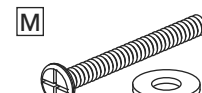

Boulon M6 x 55 mm x 6  
Rondelle x 6

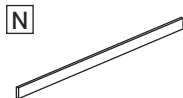

Barre métallique x 3

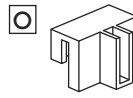

Attache pour classeur x 6

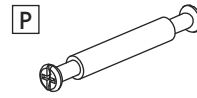

Goujon d'excentrique à extrémité double x 2

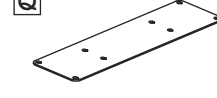

Plaque de connexion x 1

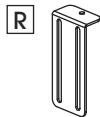

Support en L x 2

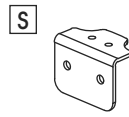

Petit support x 2

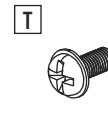

Boulon M4 x 10 x 4

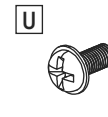

Boulon M3 x 8 x 4



Vis ST3,5 x 12 x 2

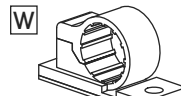

Attache-câbles x 5

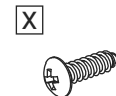

Vis ST4 x 16 mm x 5



**REMARQUE :** Les instructions suivantes illustrent un bureau à devant arqué avec configuration à droite.



**REMARQUE :** Serrez tous les boulons, vis, goujons d'excentrique et excentriques à l'aide d'un tournevis cruciforme.



**REMARQUE :** Si vous assemblez un bureau en L à gauche, le classeur à caisson du bureau principal comportera 3 tiroirs et le caisson du retour comportera 2 tiroirs.



**REMARQUE :** Montez le meuble sur une surface lisse qui ne marque pas afin d'éviter les rayures. Vérifiez les tiroirs et les emballages pour vous assurer que toutes les pièces et le matériel d'installation sont inclus.

# MONTAGE DU BUREAU EN L

**REMARQUE :** Pour une configuration de bureau en L à gauche, fixez les classeurs à caisson et les composants du retour sur le côté opposé de la surface du bureau.

1. Retirez les poignées préfixées (I) de l'intérieur du classeur à caisson à 2 tiroirs (4) et le classeur à caisson du retour (15). Alignez les trous à l'extérieur du tiroir sur ceux de la poignée. Fixez celle-ci à l'aide de deux boulons M4 x 22 mm (I). Répétez l'opération pour les autres tiroirs. (Voir Figure 15)

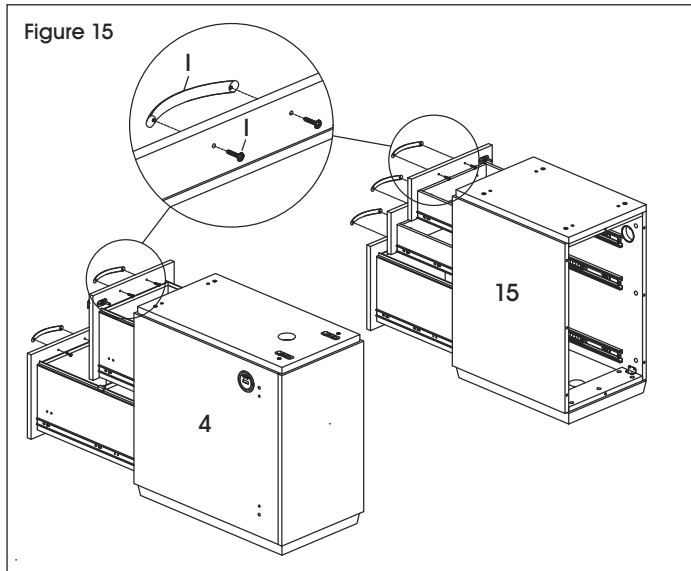

2. À deux, retournez avec précaution les classeurs à caisson (4,15). Installez quatre patins réglables (K) dans chacun des classeurs à caisson. Placez les classeurs à caisson à l'endroit. (Voir Figure 16)

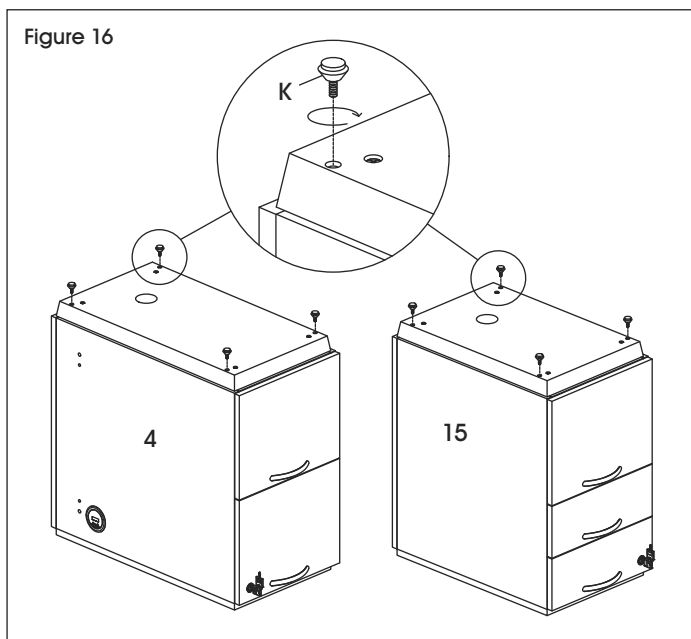

3. Installez quatre goujons d'excentrique (B) dans le panneau arrière (7). Installez quatre excentriques (C) dans le panneau latéral (6) et le panneau latéral intérieur (8). Fixez le panneau latéral et le panneau latéral intérieur au panneau arrière. (Voir Figure 17)

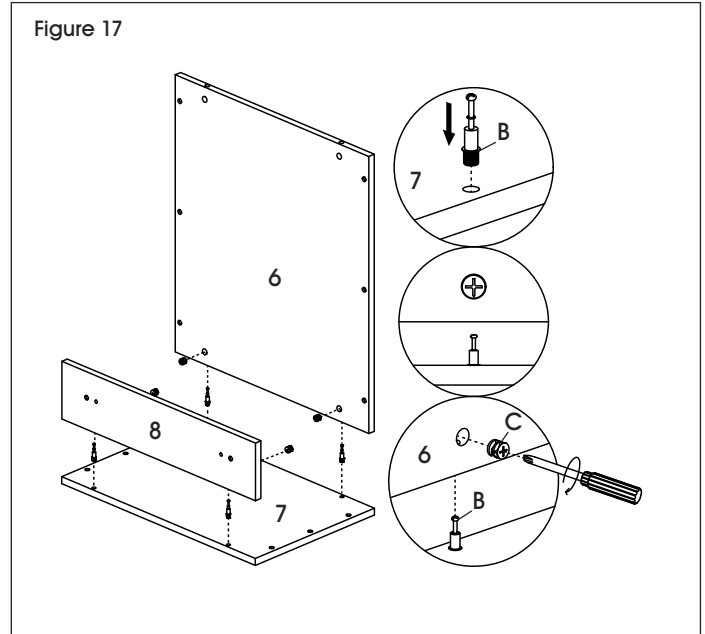

**IMPORTANT!** Vérifiez que la flèche pointe vers le bord du panneau avant d'insérer l'excentrique dans le trou du panneau. Tournez-le de  $\frac{1}{4}$  de tour vers la droite pour le verrouiller.

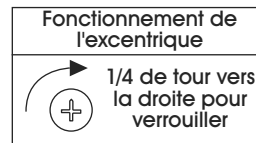

**IMPORTANT!** Les goujons d'excentrique (B) doivent être serrés après insertion dans le panneau. Pour les serrer, saisissez la partie inférieure du goujon et serrez avec un tournevis cruciforme.

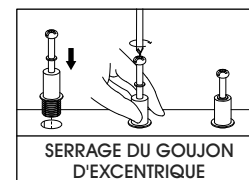

## MONTAGE DU BUREAU EN L

4. Fixez la garniture inférieure de demi-pied (10) au bord inférieur des panneaux de demi-pied à l'aide de huit boulons M6 x 25 mm (G). Installez trois patins réglables (K) dans la garniture inférieure de demi-pied. (Voir Figure 18)

 **REMARQUE :** Dans le cas d'une configuration à gauche, le panneau latéral (6) doit être positionné à droite lorsque les panneaux assemblés sont placés à l'envers.

Figure 18



5. Retournez le demi-pied sur les patins réglables. Installez la garniture supérieure de demi-pied (9) à l'aide de huit boulons M6 x 25 mm (G). (Voir Figure 19)

Figure 19

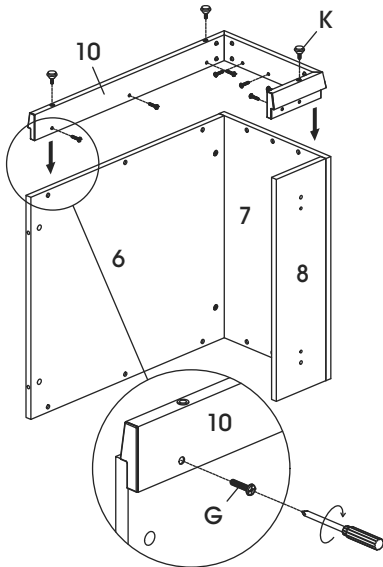
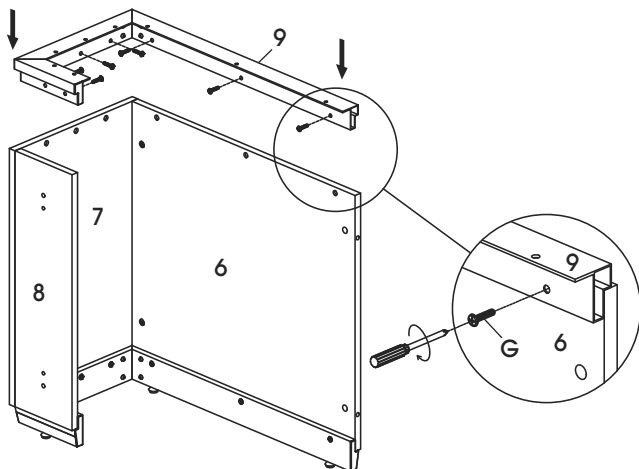

6. Retirez tous les tiroirs des deux classeurs à caisson (4,15). (Voir Figure 20)

 **REMARQUE :** Pour retirer les tiroirs, repérez les languettes sur les glissières des tiroirs. En appuyant sur la languette gauche et en tirant la languette droite vers le haut, retirez le corps du tiroir du classeur.

Figure 20



7. Installez deux goujons d'excentrique (B) dans le panneau intérieur du classeur à caisson à 2 tiroirs (4) et dans le panneau latéral intérieur (8) du demi-pied. (Voir Figure 21)

 **REMARQUE :** Pour une configuration à gauche du bureau en L, il faudra utiliser un classeur à caisson à 3 tiroirs.

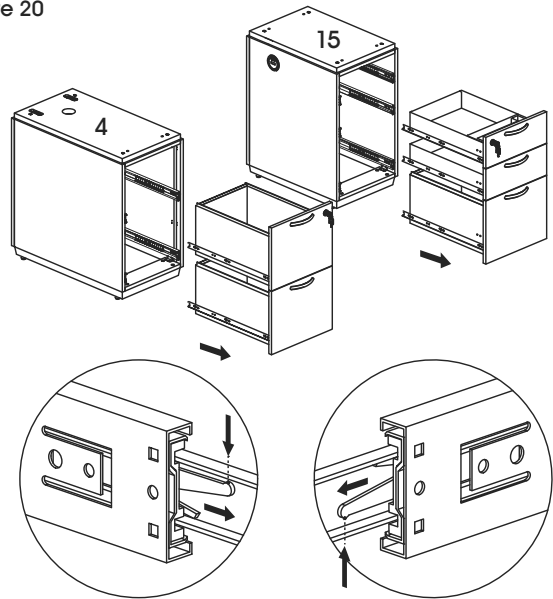
Figure 21



## MONTAGE DU BUREAU EN L SUITE

8. Installez quatre excentriques (C) et quatre chevilles (D) dans le panneau cache-jambes stratifié (2).  
(Voir Figure 22)

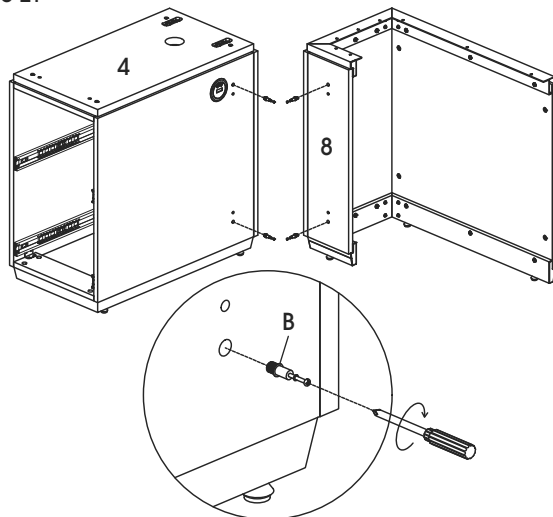
Figure 22

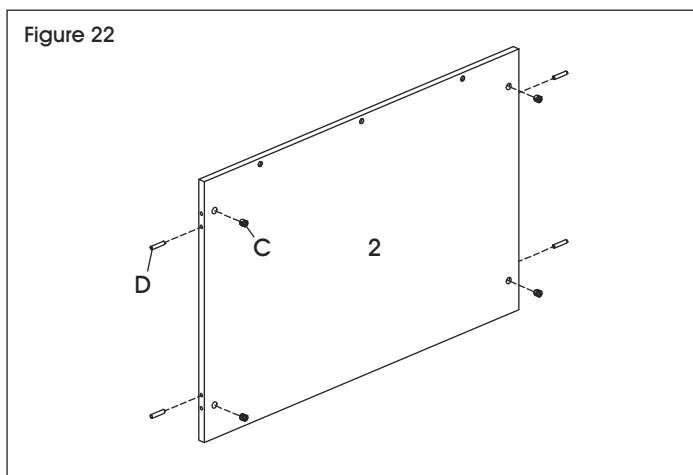

9. À deux, fixez le panneau cache-jambes stratifié (2) entre le classeur à caisson à 2 tiroirs (4) et le panneau latéral intérieur (8). Serrez les excentriques (C).  
(Voir Figure 23)

Figure 23

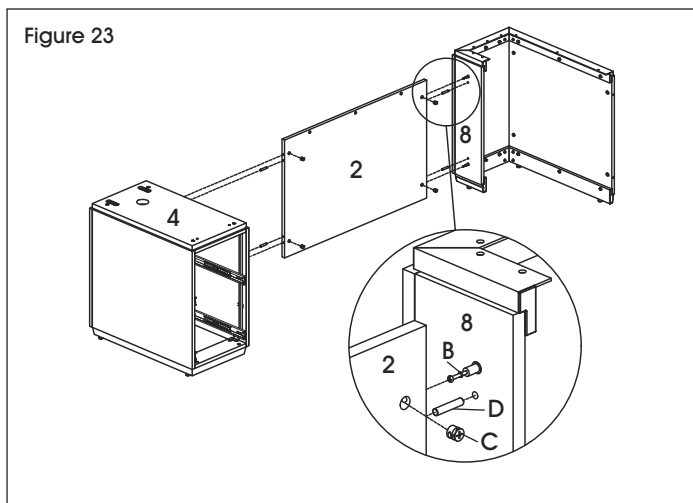

10. Fixez la garniture de panneau cache-jambes (3) sur le bord supérieur du panneau cache-jambes stratifié (2) au moyen de trois boulons M6 x 25 mm (G).  
(Voir Figure 24)

Figure 24

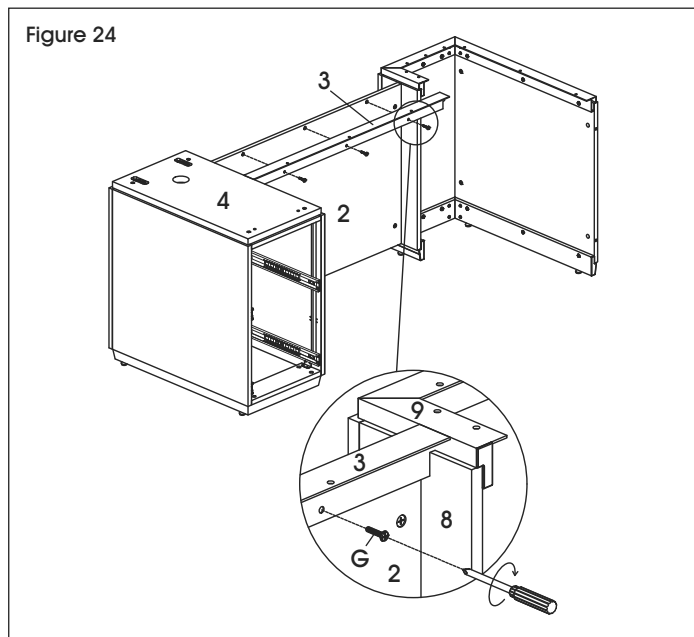

11. Installez huit goujons d'excentrique (B) dans le panneau cache-jambes du retour (12).  
(Voir Figure 25)

Figure 25

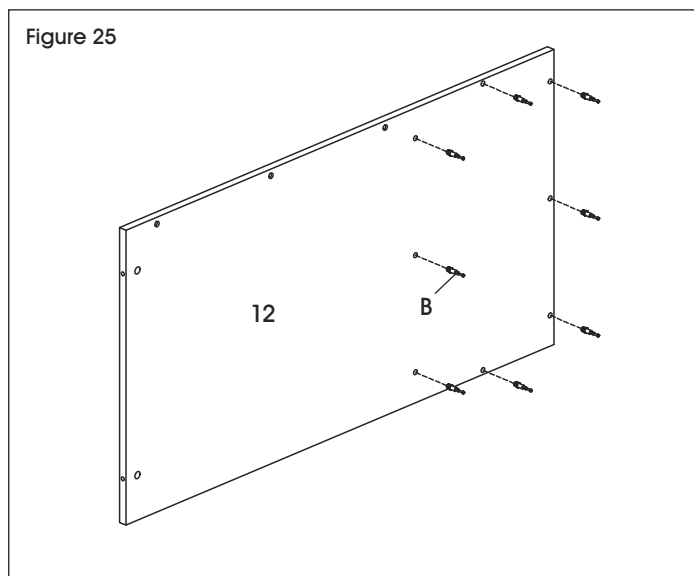

## MONTAGE DU BUREAU EN L SUITE

12. Installez huit excentriques (C) dans le panneau cache-jambes du retour (15). (Voir Figure 26)

Figure 26

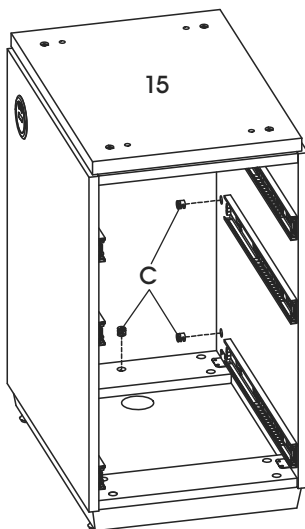

13. Fixez le classeur à caisson du retour (15) sur le panneau cache-jambes du retour (12). Serrez les excentriques (C) à l'intérieur du panneau cache-jambes du retour. (Voir Figures 27 et 28)

Figure 27

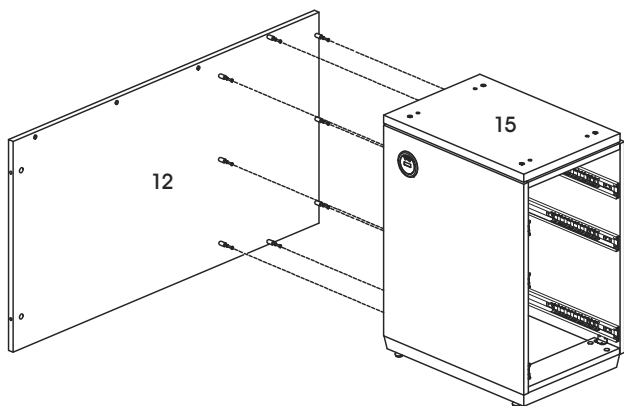
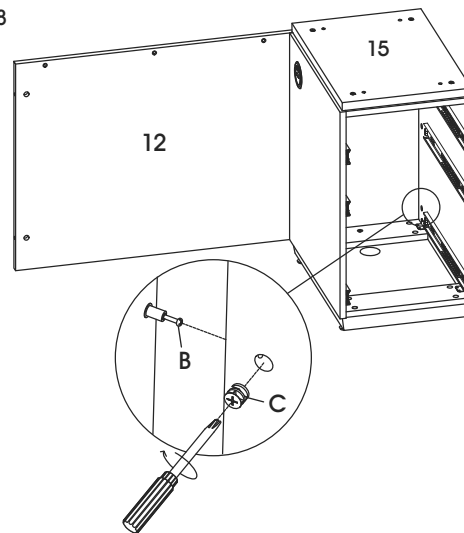
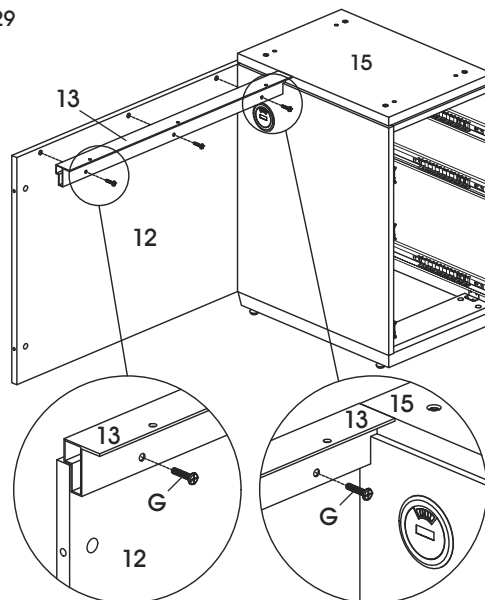

Figure 28



14. Fixez la garniture de panneau cache-jambes du retour (13) sur le bord supérieur du panneau cache-jambes du retour (12) au moyen de trois boulons M6 x 25 mm (G). (Voir Figure 29)

Figure 29





## MONTAGE DU BUREAU EN L SUITE



Placez les éléments assemblés à l'endroit souhaité.

15. À deux, fixez le panneau cache-jambes du retour (12) au panneau latéral (6) sur le demi-pied à l'aide de deux goujons d'excentrique à extrémité double (P) et de quatre excentriques (C). (Voir Figure 30)

Figure 30

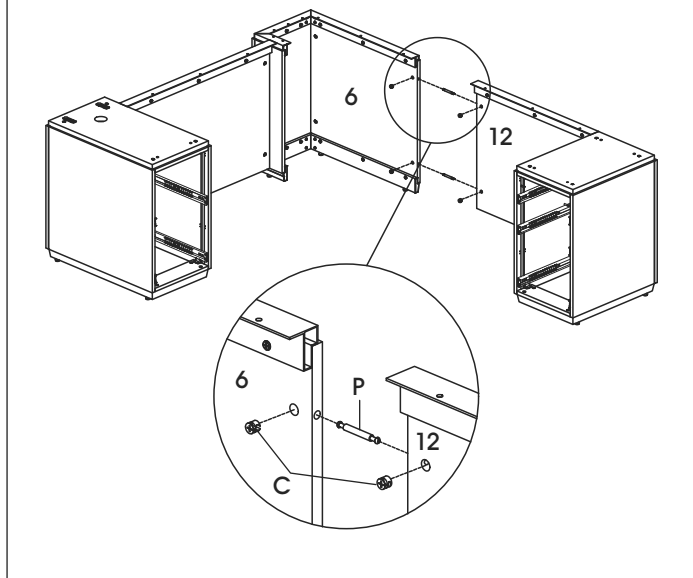

16. À deux, retournez la surface de bureau (1). Les trous préfiletés sur la surface de bureau doivent être orientés vers le haut. Installez deux boulons à épaulement (L) dans les trous préfiletés noirs sur le côté droit de la surface du bureau. (Voir Figure 31)



**REMARQUE :** Dans le cas d'une configuration à gauche, installez les boulons à épaulement (L) sur le côté gauche de la surface de bureau renversée (1).

Figure 31

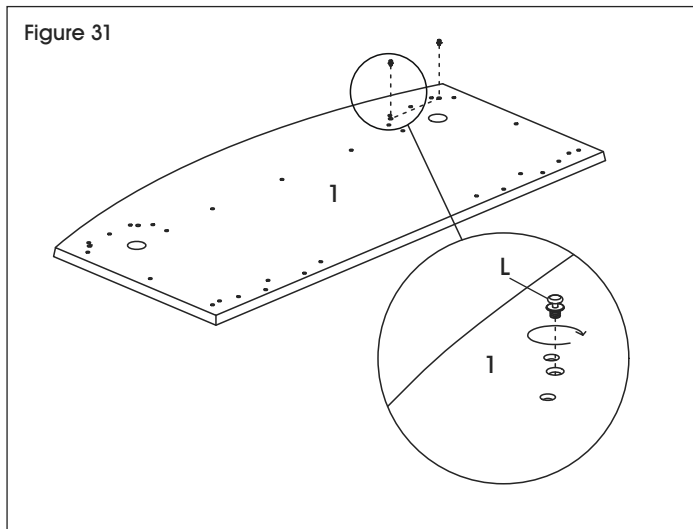

17. À deux, soulevez la surface de bureau (1) et alignez soigneusement les boulons à épaulement (L) avec les supports à fentes dans le classeur à caisson à 2 tiroirs (4). Abaissez la surface de bureau sur le cadre assemblé. (Voir Figure 32)

Figure 32

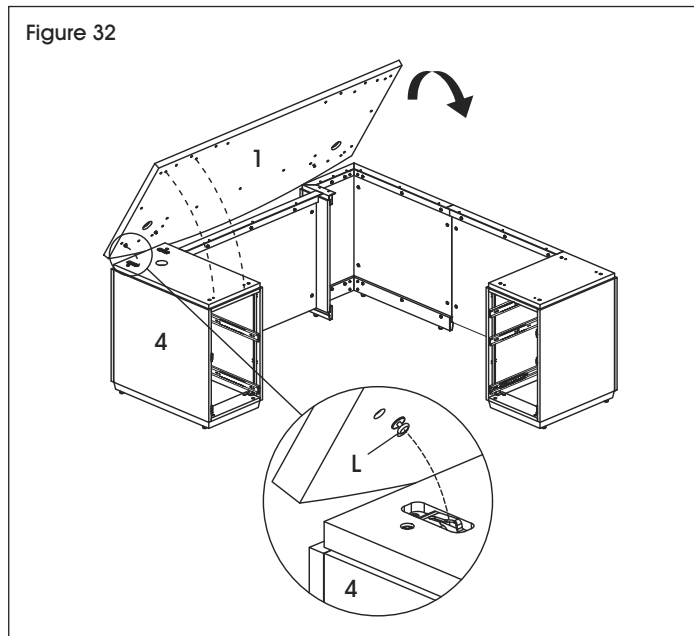

## MONTAGE DU BUREAU EN L SUITE

18. Poussez avec soin la surface de bureau (1) vers l'arrière du classeur à caisson (4) et du demi-pied pour verrouiller les boulons à épaulement (L) en place. (Voir Figure 33)

 **REMARQUE :** La surface de bureau doit être déplacée d'environ 3/4 po vers l'arrière du classeur à caisson.

 **REMARQUE :** Les supports à fentes ne se trouvent que d'un seul côté de la surface du bureau. Privilégiez le côté avec les supports à fentes lorsque vous poussez la surface de bureau.

Figure 33



19. Fixez la surface de bureau (1) au classeur à caisson (4) à l'aide de deux boulons M6 x 55 mm et rondelles (M). (Voir Figure 34)

Figure 34

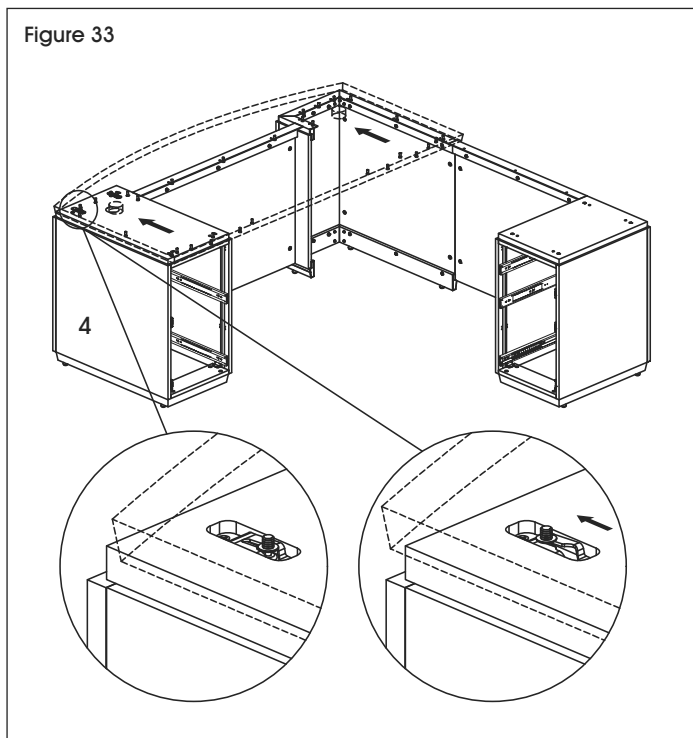
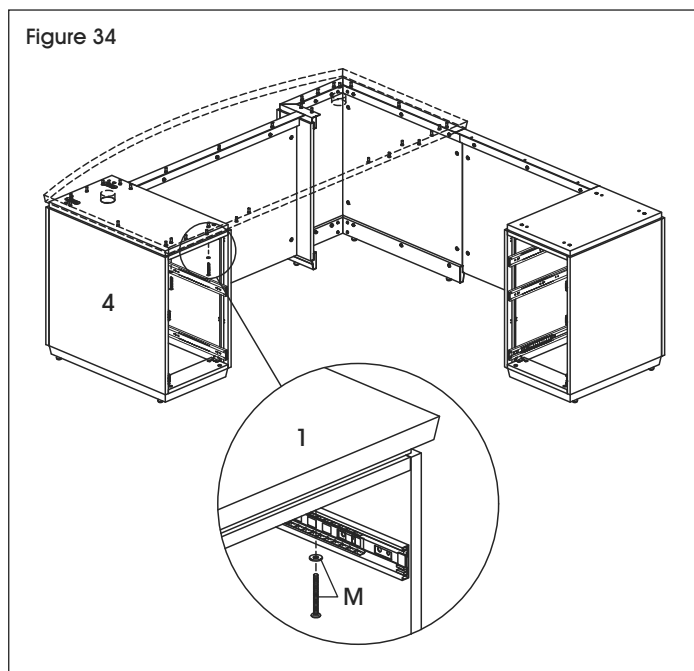

20. Insérez le système d'alimentation du retour (16) dans la surface de bureau du retour (11). À deux, retournez avec précaution la surface de bureau du retour. (Voir Figure 35)

Figure 35

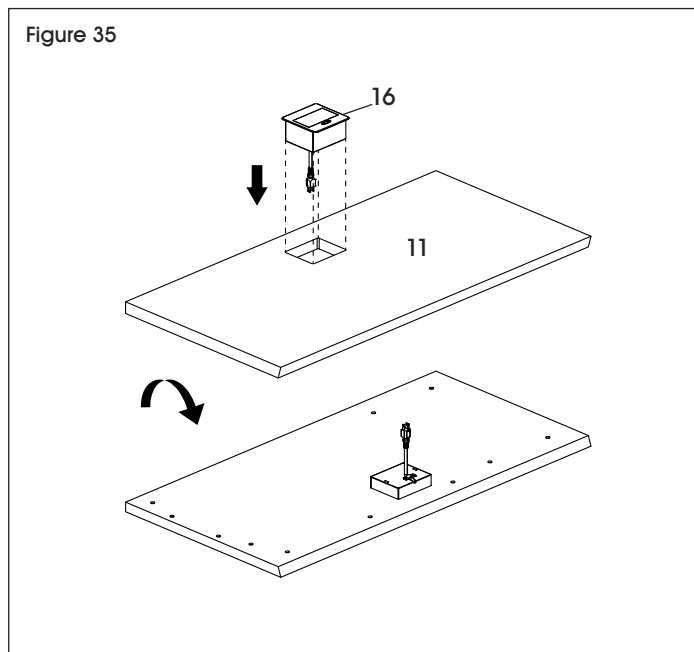

## MONTAGE DU BUREAU EN L SUITE

21. Fixez sans serrer le support en L (R) et le petit support (S) à l'aide de deux boulons M4 x 10 mm (T). Répétez l'opération pour le support en L et le petit support restants. (Voir Figure 36)

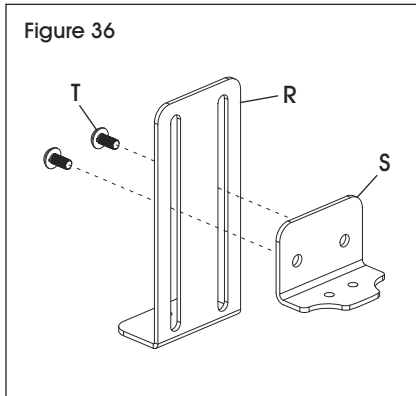

22. Fixez les supports assemblés au dessous du centre d'alimentation du retour (16) avec quatre boulons M3 x 8 mm (U). (Voir Figure 37)

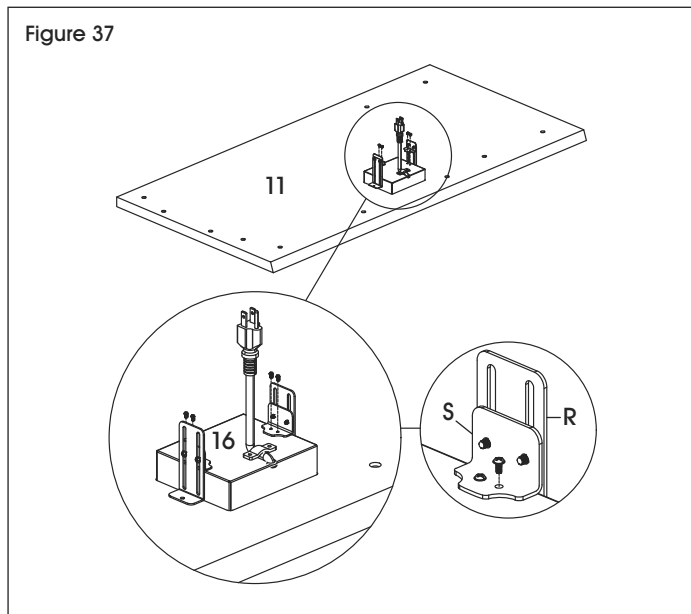

23. Fixez les deux supports en L (R) à la surface de bureau du retour (11) à l'aide de deux vis ST3,5 x 12 mm (V). Serrez complètement les boulons reliant le support en L et le petit support (S). (Voir Figure 38)

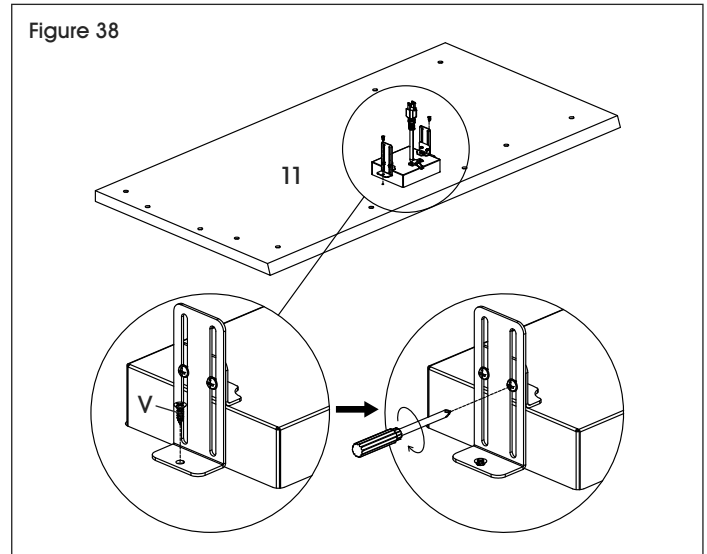

24. À deux, placez la surface de bureau du retour (11) sur le cadre du retour et le classeur à caisson (15). Fixez la plaque de connexion (Q) entre la surface de bureau (1) et la surface de bureau du retour (11) avec huit boulons M6 x 15 mm (F). (Voir Figure 39)

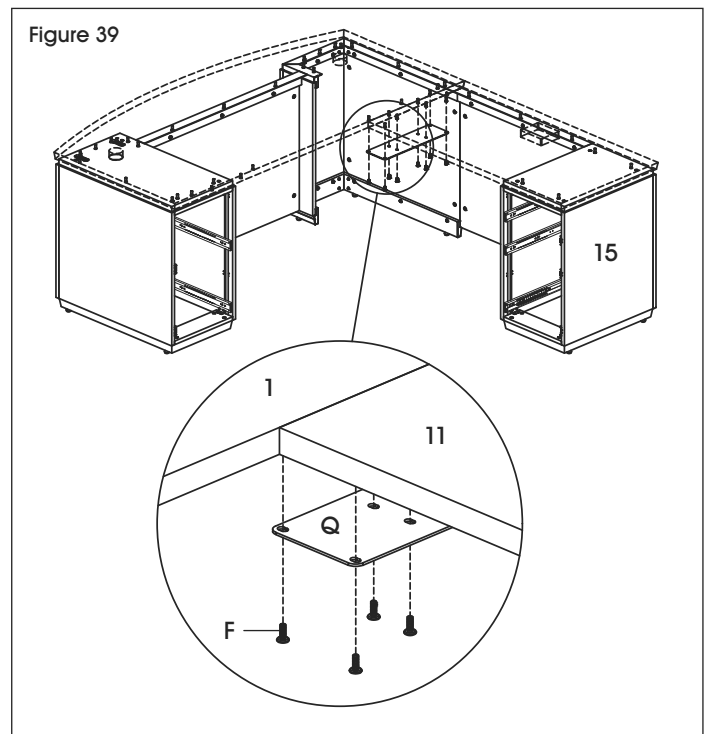

## MONTAGE DU BUREAU EN L SUITE

25. Fixez le classeur à caisson du retour (15) à la surface de bureau du retour (11) à l'aide de quatre boulons M6 x 55 mm et de quatre rondelles (M). (Voir Figure 40)

Figure 40

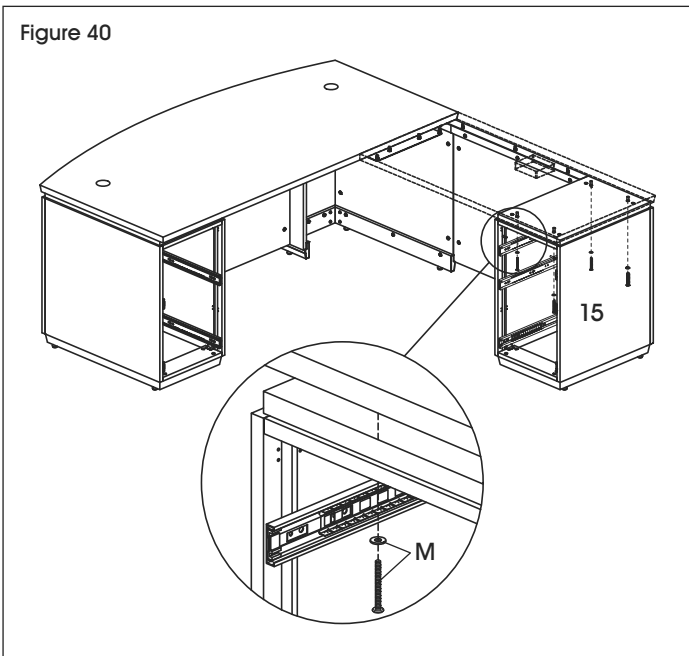

26. Fixez la garniture du panneau cache-jambes (3), la garniture supérieure du demi-pied (9) et la garniture du panneau cache-jambes du retour (13) à la surface de bureau (1) et à la surface de bureau du retour (11) à l'aide de 14 boulons M6 x 15 mm (F). (Voir Figure 41)

Figure 41

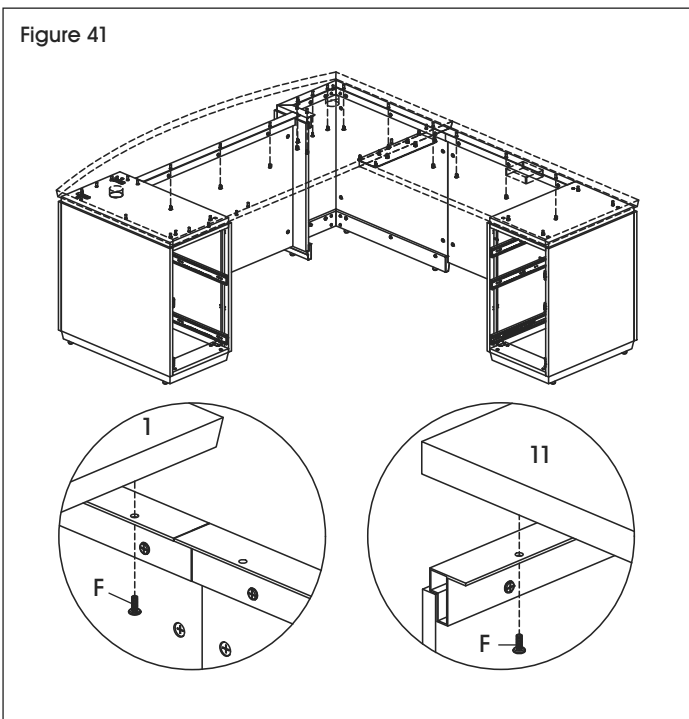

27. Installez les passe-fils pour surface de bureau (A) dans la surface de bureau (1). Installez les caches pour excentrique (E) pour donner un aspect fini. (Voir Figure 42)

Figure 42

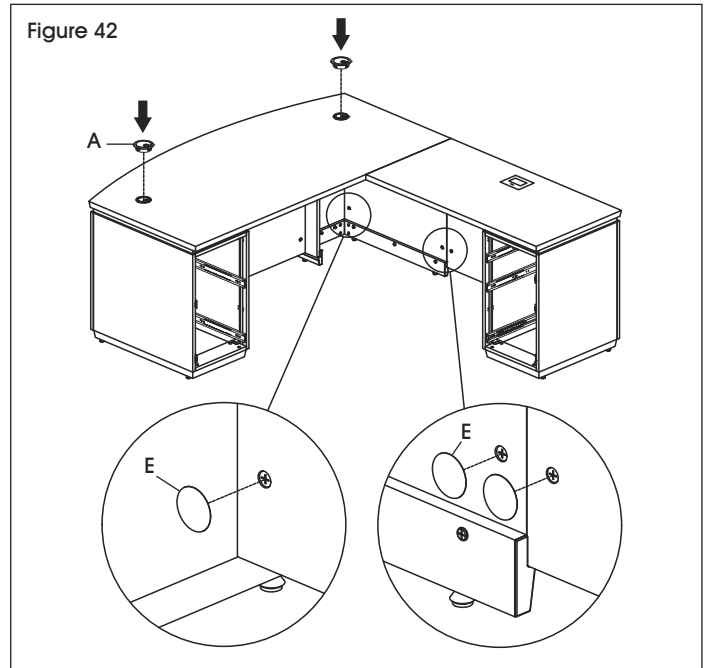

28. Réinstallez les tiroirs dans le classeur à caisson (4) et le classeur à caisson du retour (15). (Voir Figure 43)

Figure 43

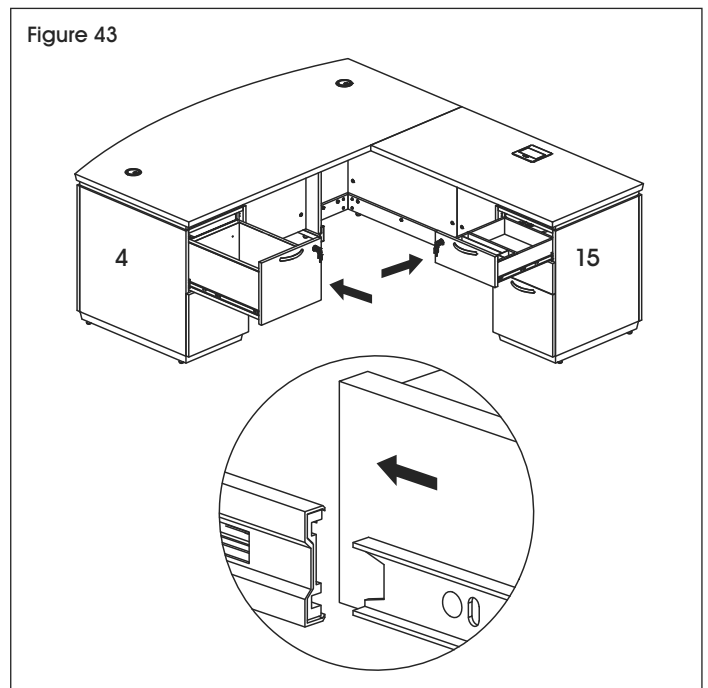

## MONTAGE DU BUREAU EN L SUITE

29. Dans chaque tiroir du classeur, fixez les attaches pour classeur (O) sur les deux côtés du tiroir et insérez la barre métallique (N). (Voir Figure 44)

Figure 44

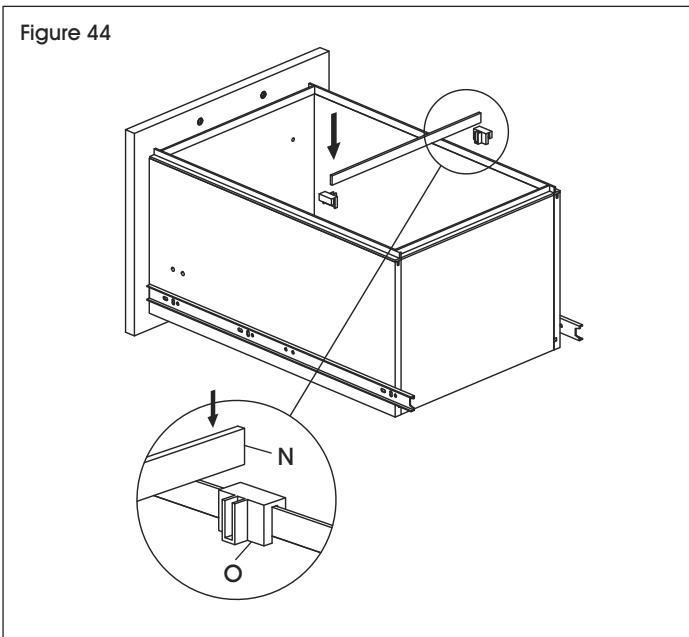

30. Placez les attache-câbles (W) à l'endroit souhaité pour bien organiser les câbles sous la surface de bureau. Les attache-câbles peuvent être fixées à l'aide d'adhésif ou de vis ST4 x 16 mm (X). (Voir Figure 45)

Figure 45

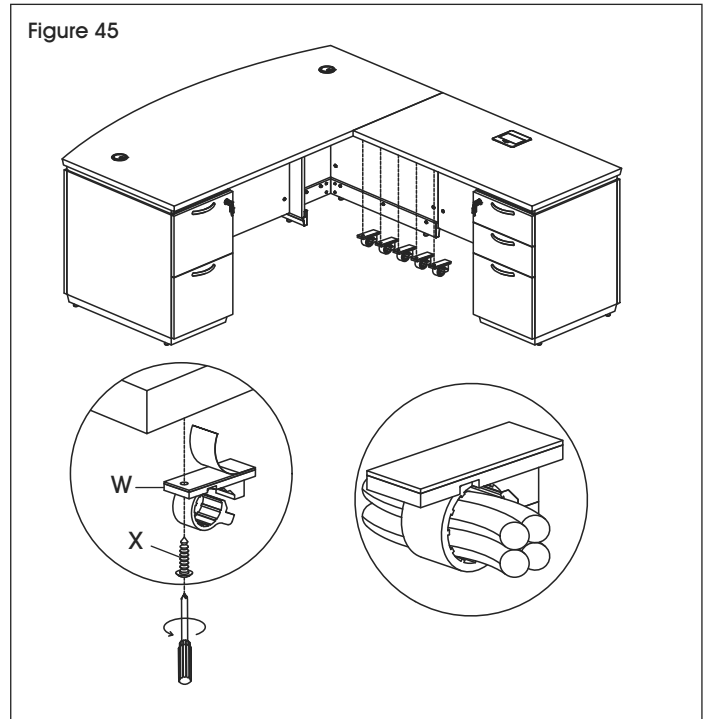

Montage terminé

**ULINE**

1 800 295-5510  
uline.ca