

**ULINE** H-1604

# MINI PAK'R™ AIR CUSHION MACHINE

1-800-295-5510  
uline.com

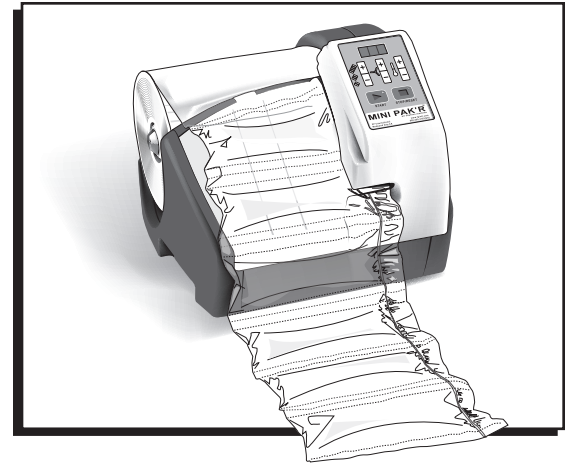

## BOX CONTENTS

- Air Cushion Machine
- Power Cord
- Two (2) Spare Teflon® Seal Belts
- Quick Start Guide
- User Manual

## PARTS

### EXTERNAL

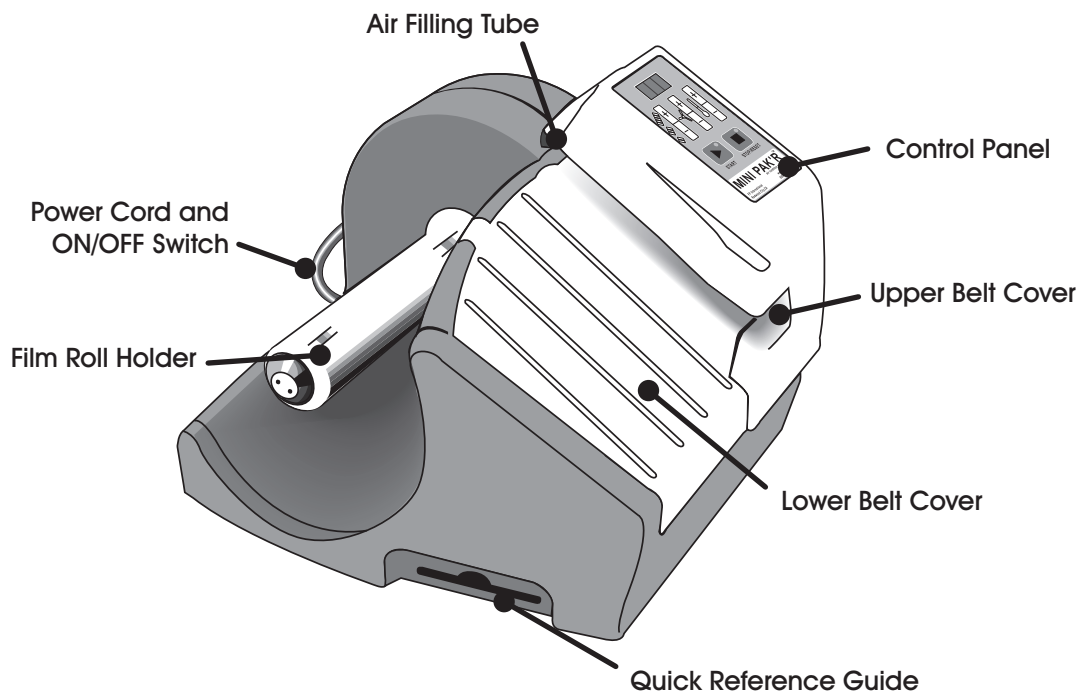

### INTERNAL

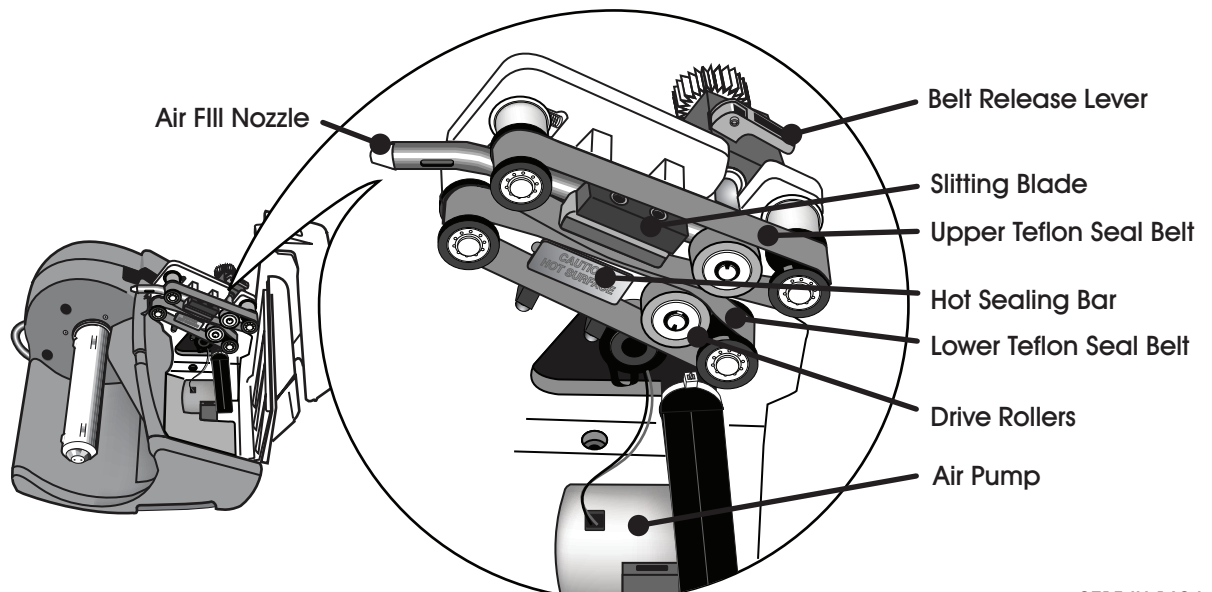

## OPERATION OVERVIEW

1. Load Film Roll\* onto the Film Roll Holder. (See Below)
2. Guide right side of Film onto the Air Fill Nozzle and pull through the machine. (See Below)
3. Upper and Lower Seal Belts and Drive Rollers advance the film.
4. Air Pump injects air through the Air Fill Nozzle and fills Air Cushions.
5. Hot Sealing Bar seals Air Cushions.
6. Slitting Blade cuts right side of Film from the Air Fill Nozzle.

\*Works only with Uline Air Cushioning rolls:  
S-12881, S-12882, S-12883, S-12884, S-12885.

## LOADING A FILM ROLL

### CONNECT POWER

1. Plug Power Cord into the rear of the machine, then plug cord into a grounded outlet. (See Figure 1)
2. Switch machine power ON (I)

### LOAD FILM ROLL

1. Slide film onto Film Roll Holder until it seats firmly — Film feeds from top of Roll. (See Figure 2)

### THREADING THE FILM

1. Unwind 18 inches of film.
2. Open the Air Channel on right side of Film Roll. (See Figure 3)
3. Slide the Air Channel over the end of the Air Fill Tube. (See Figure 4)
4. Advance Film.

- **To Advance Film Manually:**

Pull Film down the Air Fill Tube and through the Sealer.

- **To Advance Film Automatically:**

Pull Film down the Air Fill Tube until it stops. (See Figure 5)

- Press and hold the Start button — Film advances automatically. (See Figure 6)



**NOTE:** There are two different widths of film rolls. Refer to Figure A for the 8" wide roll and Figure B for the 16" wide roll to see what the final result should look like after loading film.

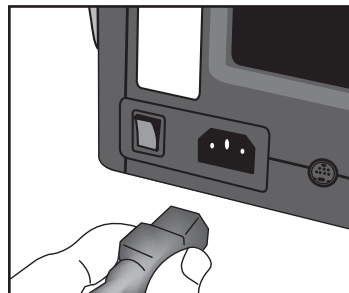

Figure 1

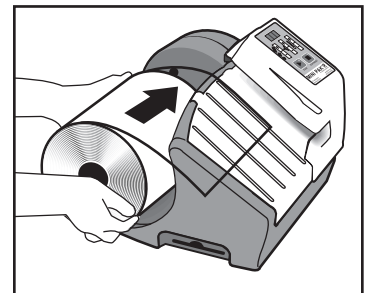

Figure 2

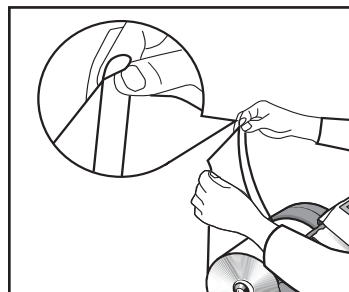

Figure 3

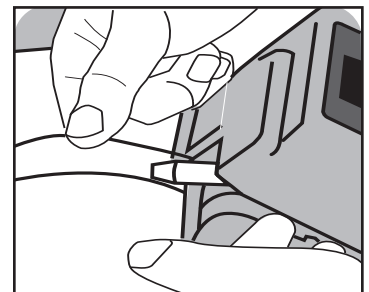

Figure 4

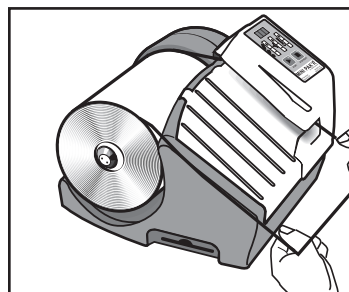

Figure 5

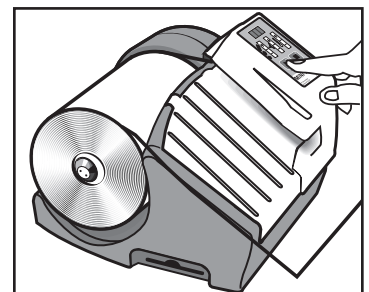

Figure 6

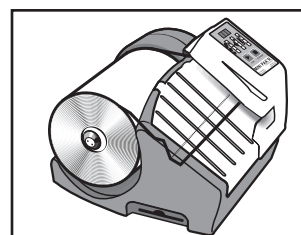

Figure A

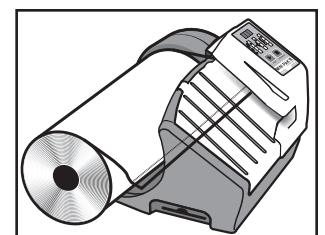
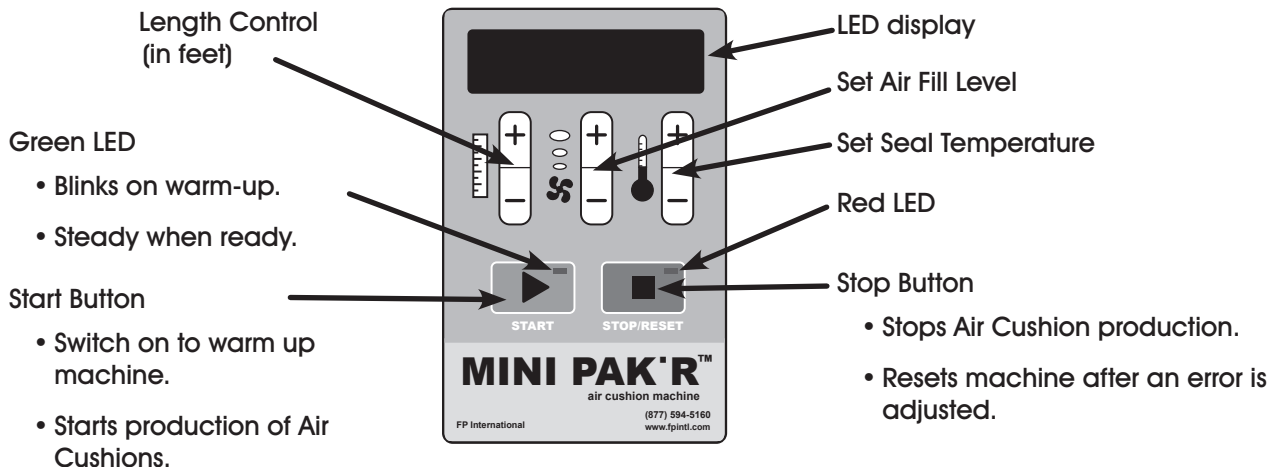

Figure B

## CONTROL PANEL



## BASIC OPERATION

### BASIC USE

1. When machine is switched on, display shows "sty" (Standby). (See Figure 7)



Figure 7

2. Mini Pak'r™ detects the film roll once it is loaded.
3. Green LED on Start Button begins flashing. Machine warms up.
4. Display shows the seal temperature during warm-up.
5. Once seal temperature is reached, green LED stops flashing.
6. Display shows "rdy" (Ready). (See Figure 8)



Figure 8

7. Press Start Button to begin making Air Cushions. (See Figure 9)

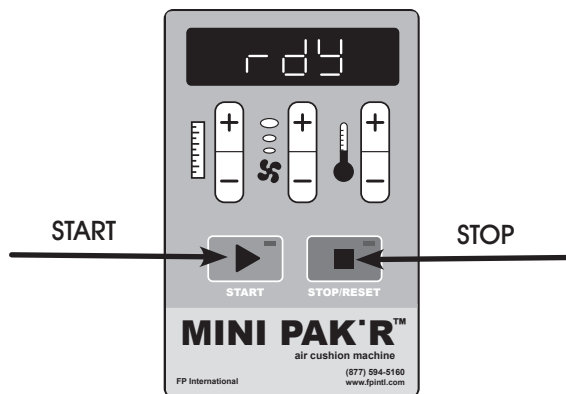

Figure 9

8. Air Pump blows air into the Film, after a few seconds the Drive Motor advances the Air Cushions through the Seal Bar and Slitting Blade.
9. Finished Air Cushions emerge at front of machine.
10. Press Stop Button to stop production.



**NOTE:** Machine is preset to operate continuously, producing Air Cushions until the roll is empty. To create a fixed length of Air Cushions, use the Length Control buttons (see Length Control, page 4).

## BASIC OPERATION CONTINUED

### STANDBY

When out of use for 15 minutes, machines goes to "Standby" mode.

1. Display shows "sty". (See Figure 10)
2. Press the Reset Button to resume Air Cushion production. (See Figure 10)
3. Seal Bar begins heating up.
4. Press Start Button again when green LED stops flashing and Display reads "rdy". (See Figure 11)

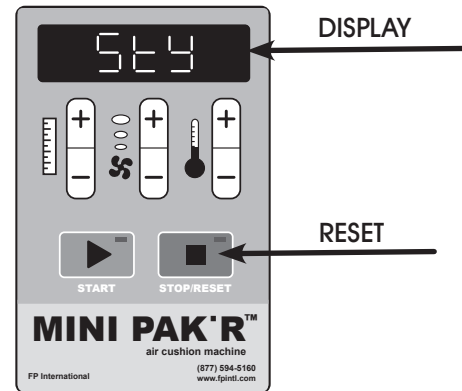

Figure 10

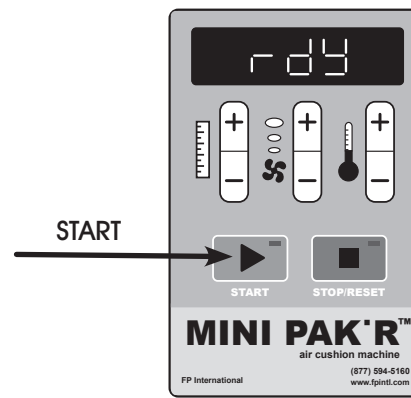



Figure 11

## CHANGING MINI PAK'R™ SETTINGS

 **NOTE:** Machine automatically sets the correct air and temperature settings for the Film Roll loaded. No need to adjust the settings manually. However, if needed, you can change some settings with the Control Panel.

### LENGTH CONTROL

Sets the length of Air Cushions to be produced each time you press the Start Button.

- **Continuous Mode:** This is the factory preset. Press the Start Button and machine runs the film until the roll is empty or you press the Stop Button. Display will show the number of Air Cushions produced.
- **Fixed Length:** To produce a fixed length of Air Cushions, press the "+" Button until the desired length shows in the Display. The machine will count down the length of Air Cushions yet to produce. (See Figure 12)
- **Change from Fixed to Continuous:** Press the "-" Button until the Display shows "---".

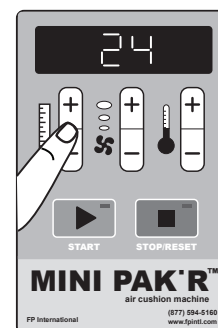

Figure 12

# CHANGING MINI PAK'R™ SETTINGS CONTINUED

## AIR CONTROL

Regulates the amount of air in the Air Cushions. (See Figure 13)

- For fuller cushions, press the "+" Button.
- For less full cushions, press the "-" Button.



Figure 13



**NOTE:** Air Cushions are designed to be inflated around 2/3 full. This allows pillows to absorb shock of impacts during the shipping cycle.

## TEMPERATURE CONTROL

Regulates the temperature of the Seal Bar. (See Figure 14)

- To increase the sealing temperature, press the "+" Button.
- To decrease the sealing temperature, press the "-" Button.



Figure 14



**NOTE:** When the temperature setting is changed, the Mini Pak'r™ may take a few moments to raise or lower the temperature. The green LED flashes during heat-up or cool-down until the correct temperature is reached.

If Air Cushions continue to have leaking or burned through seals, contact Uline customer service at 1-800-295-5510.

# MAINTENANCE



**WARNING! Burn Risk:** Before opening the covers, turn power OFF, unplug the power cord and wait 10 minutes for Seal Bar to cool.

## REPLACING SLITTING BLADES

Replace Blades:

- If film jams frequently.
  - After processing 50 Film Rolls.
  - If blade does not cut properly or makes very rough cuts.
1. Turn Power OFF, unplug power cord and wait 10 minutes for Seal Bar to cool.
  2. Open Belt Cover with a slotted or Phillips screwdriver. (See Figure 15)
  3. Remove Blade. (See Figure 16)
    - Replace Blade. (See Figure 17)

## REPLACING SEAL BELTS

Replace Belts:

- If film jams frequently.
  - The film won't advance with Drive Motor running.
  - Machine produces poor seals even after adjusting the seal temperature.
1. Turn Power OFF, unplug power cord and wait 10 minutes for Seal Bar to cool.
  2. Open Belt Cover with a slotted or Phillips screwdriver. (See Figure 15)
  3. Lift Belt Release lever to loosen Seal Belts. (See Figure 18)
  4. Push spring-loaded rollers toward front of machine to loosen either Seal Belt. (See Figure 19)
  5. Remove and replace Seal Belt. Replace both Seal Belts at the same time.
  6. Tighten Belts by locking Belt Release lever in place. (See Figure 20)

## ROUTINE MAINTENANCE

**Weekly:** Clean the Seal Belts and Drive Rollers with warm water and mild detergent if needed.

**Monthly:** Check the Mini Pak'r™ for damage. Replace worn or damaged parts if necessary. And/or contact Uline customer service at 1-800-295-5510.

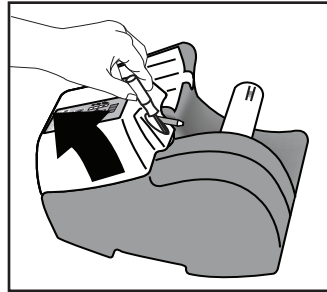

Figure 15

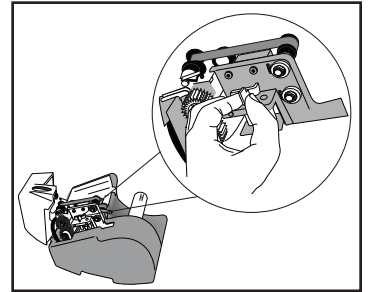

Figure 16

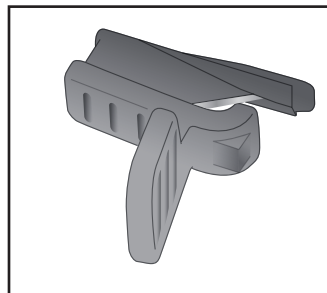

Figure 17

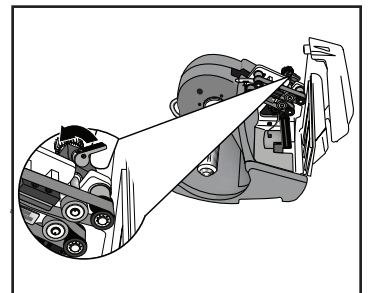

Figure 18

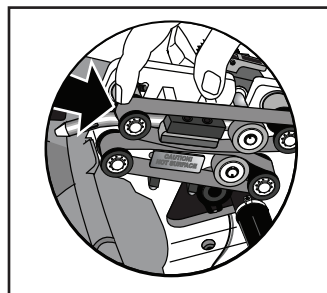

Figure 19

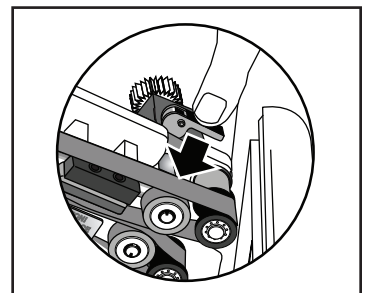

Figure 20

# ERRORS AND TROUBLESHOOTING

## ERROR CODES

Consult the chart below if the Display shows an Error Code and the red LED flashes. Try the appropriate action for the problem, then press the STOP/RESET Button to resume operation.

DISPLAY CODE	ISSUE	ACTION
E1	Cover open	Make sure covers are closed
E2	Jam/end of roll	In case of jam, open belt cover and remove jammed film carefully.
E3	Temp. Too high	Contact Uline for assistance. (800-295-5510)
E4	Temp. Too low	Contact Uline for assistance. (800-295-5510)
E5	Temp. Not rising	Contact Uline for assistance. (800-295-5510)
E6	No roll detected	Press stop/reset. This may clear the error. If not, display will show "sty" (standby). Advance the film slowly at the front of the machine so the film roll rotates. The display should show the seal temperature and then "rdy" (ready). If the error can't be cleared, contact Uline for assistance. (800-295-5510)

## TROUBLESHOOTING

OPERATING ISSUE	CAUSES	RECOMMENDATIONS
No power to Mini Pak'r™ Machine	Power cord is unplugged Circuit breaker OFF Power Switch OFF Main fuse is blown Belt cover(s) open	Plug power cord into Mini Pak'r™ Machine and outlet Turn circuit breaker ON at Electrical Panel Turn Power Switch ON Replace Mains Fuse Tighten Belt Cover Screw with Screwdriver
Film won't advance	Film Roll installed backwards Using incompatible film	Turn film roll around (page 2) Install compatible roll
Air Cushions do not hold air	Air Fill Tube not inside film Air Pump not working Seals leaking Too much air fill	Reload film onto Air Fill Tube (page 2) Contact Uline for assistance Adjust seal temperature (page 5) Reduce air fill (page 5)
Film jams frequently	Blade is dull Drive belts are worn	Replace Blade (page 6) Replace both Drive Belts (page 6)
Machine won't stop automatically	Length control set to continuous	Press + or – Length Control Buttons to set desired length of Air Cushion production (page 4)