

ULINE H-161, H-293
H-963, H-1252
**IMPULSE SEALER
WITH CUTTER**

1-800-295-5510
uline.com

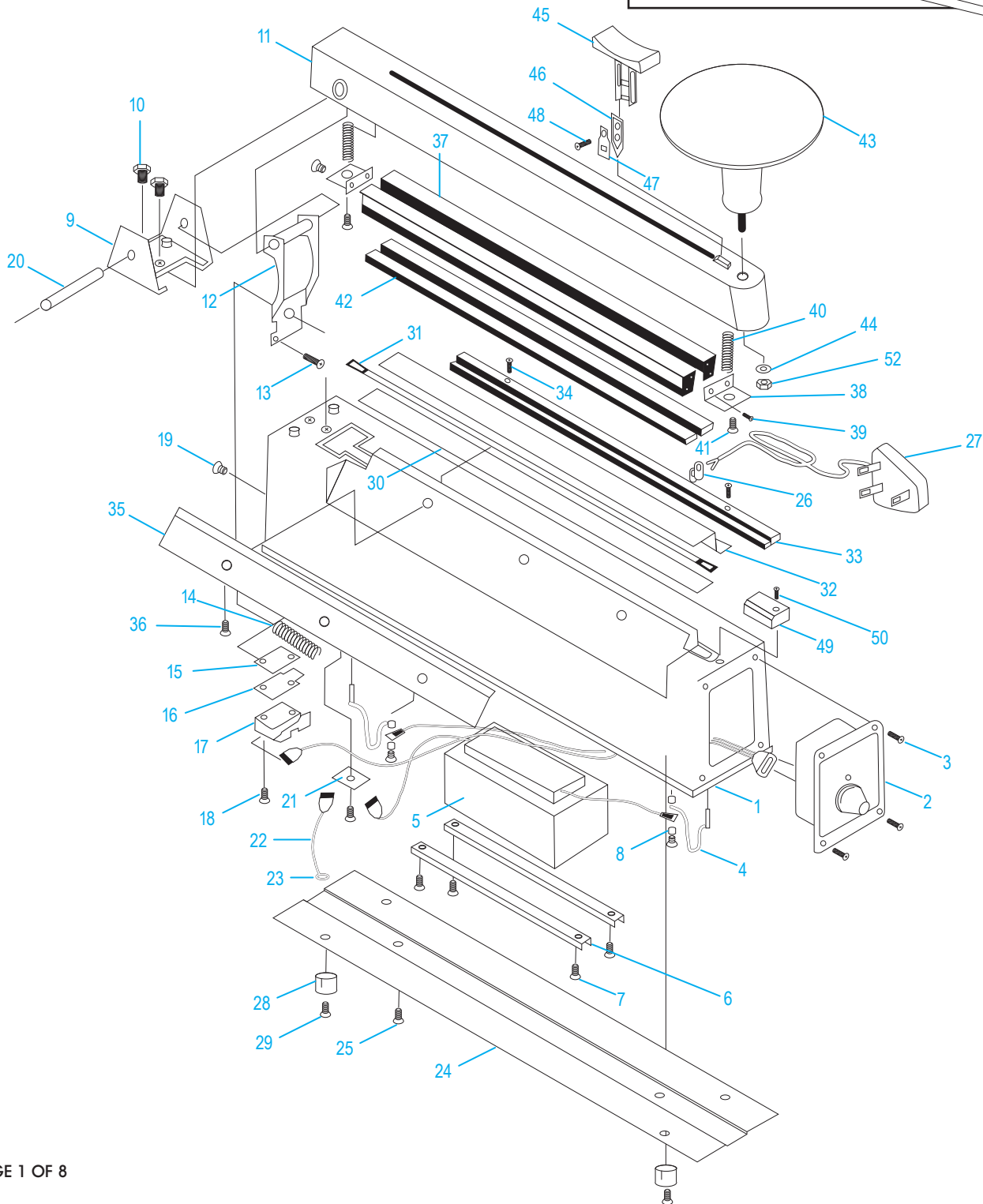
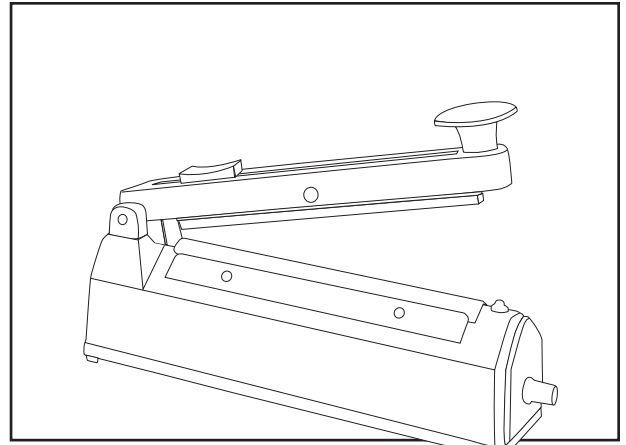

**IMPULSE SEALER
WITH CUTTER**

#	DESCRIPTION	QTY.	ULINE PART NO.	MFG. PART NO.
1	Body	1	-----	-----
2	Timer (For H-161)	1	H-161CPS	TIMER
2	Timer (For H-293)	1	H-293-011	KF300HC11
2	Timer (For H-963)	1	H-963-TIMER	2
2	Timer (For H-1252)	1	H-1252-TIMER	TI500H
3	Screw	4	-----	-----
4	Bow Spring	2	H-163-4	#4
5	Transformer (For H-161)	1	H-163-TRANSF	-----
5	Transformer (For H-293)	1	H-190-18/19	KF300H1819
5	Transformer (For H-963)	1	H-963-TRANSF	TR400C
5	Transformer (For H-1252)	1	H-1029-TRFMR	-----
6	Transformer Bracket	1	-----	-----
7	Screw	1	H-163-7	7
7-1	Spring Washer	1	H-163-7-1	#7-1
8	Plastic Washer	1	H-163-8	#8
9	Hinge Bracket (For H-161)	1	-----	-----
9	Hinge Bracket (For H-293)	1	H-293-HINGE	KF300HC3
9	Hinge Bracket (For H-963)	1	-----	-----
9	Hinge Bracket (For H-1252)	1	-----	-----
10	Screw	2	-----	-----
11	Arm (For H-161)	1	H-161-ACAST	-----
11	Arm (For H-293)	1	H-293-ARM	-----
11	Arm (For H-963)	1	H-963-11ARM	FK-400HC
11	Arm (For H-1252)	1	H-1252-11	11
12	Arm Operating Bracket	1	-----	-----
13	Microswitch Adjusting Screw	1	H-963-SCREW	-----
14	Arm Return Spring	1	-----	KF300H40
15	Microswitch Bracket**	1	-----	-----
16	Insulated Plate**	1	-----	-----
17	Microswitch**	1	-----	-----
17-1	Microswitch Spring Plate**	1	-----	-----
18	Microswitch Assembled Screw**	1	-----	-----
19	Microswitch Fixed Screw	1	H-1029-SCREW	-----
20	Hinge Pin	1	H-963-HINGE	-----

**See page 4.

**IMPULSE SEALER
WITH CUTTER**

#	DESCRIPTION	QTY.	ULINE PART NO.	MFG. PART NO.
21	Wire Connector	1	-----	-----
22	Earth Wire	1	-----	-----
23	Earth Wire Nut Washer	1	-----	-----
24	Base Plate (For H-161)	1	-----	-----
24	Base Plate (For H-293)	1	-----	-----
24	Base Plate (For H-963)	1	-----	-----
24	Base Plate (For H-1252)	1	-----	-----
25	Earth Wire Screw	1	-----	-----
26	Bushing	1	-----	-----
27	Power Cord	1	H-293-015	KF300HC15
28	Rubber Foot	4	H-293-022	KF300HC22
29	Rubber Foot Screw	4	H-963-29	8643
30	Lower Teflon (Adhesive)(For H-161)	1	-----	-----
30	Lower Teflon (Adhesive)(For H-293)	1	-----	-----
30	Lower Teflon (Adhesive)(For H-963)	1	-----	-----
30	Lower Teflon (Adhesive)(For H-1252)	1	-----	-----
31	Heating Element (For H-161)	1	-----	-----
31	Heating Element (For H-293)	1	-----	-----
31	Heating Element (For H-963)	1	-----	-----
31	Heating Element (For H-1252)	1	-----	-----
32	Upper Teflon (For H-161)	1	-----	-----
32	Upper Teflon (For H-293)	1	H-293-008	KF300HC8
32	Upper Teflon (For H-963)	1	-----	-----
32	Upper Teflon (For H-1252)	1	-----	-----
33	Teflon Plate (For H-161)	1	-----	-----
33	Teflon Plate (For H-293)	1	-----	-----
33	Teflon Plate (For H-963)	1	-----	-----
33	Teflon Plate (For H-1252)	1	-----	-----
34	Teflon Plate Screw	3	H-963-SCREWS	50
35	Teflon Fixed Plate (For H-161)	1	-----	-----
35	Teflon Fixed Plate (For H-293)	1	H-293-FIXPLT	-----
35	Teflon Fixed Plate (For H-963)	1	H-963-16FXPL	-----
35	Teflon Fixed Plate (For H-1252)	1	H-1252-FIXPL	-----
36	Teflon Fixed Plate Screw	3	H-293-036	KF300HC36

**IMPULSE SEALER
WITH CUTTER**

#	DESCRIPTION	QTY.	ULINE PART NO.	MFG. PART NO.
37	Sealing Bar (For H-161)	1	H-161-37	37
37	Sealing Bar (For H-293)	1	H-293-PLATE	-----
37	Sealing Bar (For H-963)	1	H-963-SEALBR	-----
37	Sealing Bar (For H-1252)	1	-----	-----
38	Sealing Bar Bracket	2	H-963-38	-----
39	Sealing Bar Fixed Bracket Screw	2	-----	-----
40	Sealing Bar Return Spring	2	H-161-040	40
41	Sealing Bar Return Spring Screw	2	H-293-041	KF300HC41
42	Silicon Rubber (Sealing Pad) (For H-161)	1	H-161-007	7
42	Silicon Rubber (Sealing Pad) (For H-293)	1	H-293-007	KF300HC7
42	Silicon Rubber (Sealing Pad) (For H-963)	1	H-963-RPAD	KF400HC
42	Silicon Rubber (Sealing Pad) (For H-1252)	1	H-1252PAD	-----
43	Handle Knob Assembly (Includes 44, 52)	1	H-306HK	KF400HKNOB
44	Handle Knob Washer	1	H-1252-44	44
45	Blade Holder*	1	H-161-45	45
46	Cutter Blade* (For H-161)	1	H-963-BLADE	-----
47	Blade Fixed Plate*	1	H-293-47	47
48	Blade Fixed Screw Nut*	1	H-293-48	48
49	Heating Element Cover	1	H-963-49	49
50	Heating Element Cover Screw	1	-----	-----
51	Pin Assembly (Not Shown) (For H-1252)	1	H-1252-PIN	-----
52	Nut For Handle	1	-----	-----
	*Cutter Assembly (Includes Parts 45, 46, 47, 48)	1	H-293-8	KF300HC24
	**Microswitch Assembly (Includes Parts 15, 16, 17, 18)	1	H-306MS	H293MI
	8" Service Kit (For H-161) (Includes: 2 Heating Elements, 2 PTFE Tape Strips, 2 PTFE Covers)	1	H-495	-----
	12" Service Kit (For H-293) (Includes: 2 Heating Elements, 2 PTFE Tape Strips, 2 PTFE Covers)	1	H-294	-----
	16" Service Kit (For H-963) (Includes: 2 Heating Elements, 2 PTFE Tape Strips, 2 PTFE Covers)	1	H-964	-----
	20" Service Kit (For H-1252) (Includes: 2 Heating Elements, 2 PTFE Tape Strips, 2 PTFE Covers)	1	H-1253	-----



H-161, H-293
H-963, H-1252

SELLADORA DE IMPULSO CON CORTADORA

01-800-295-5510
uline.mx

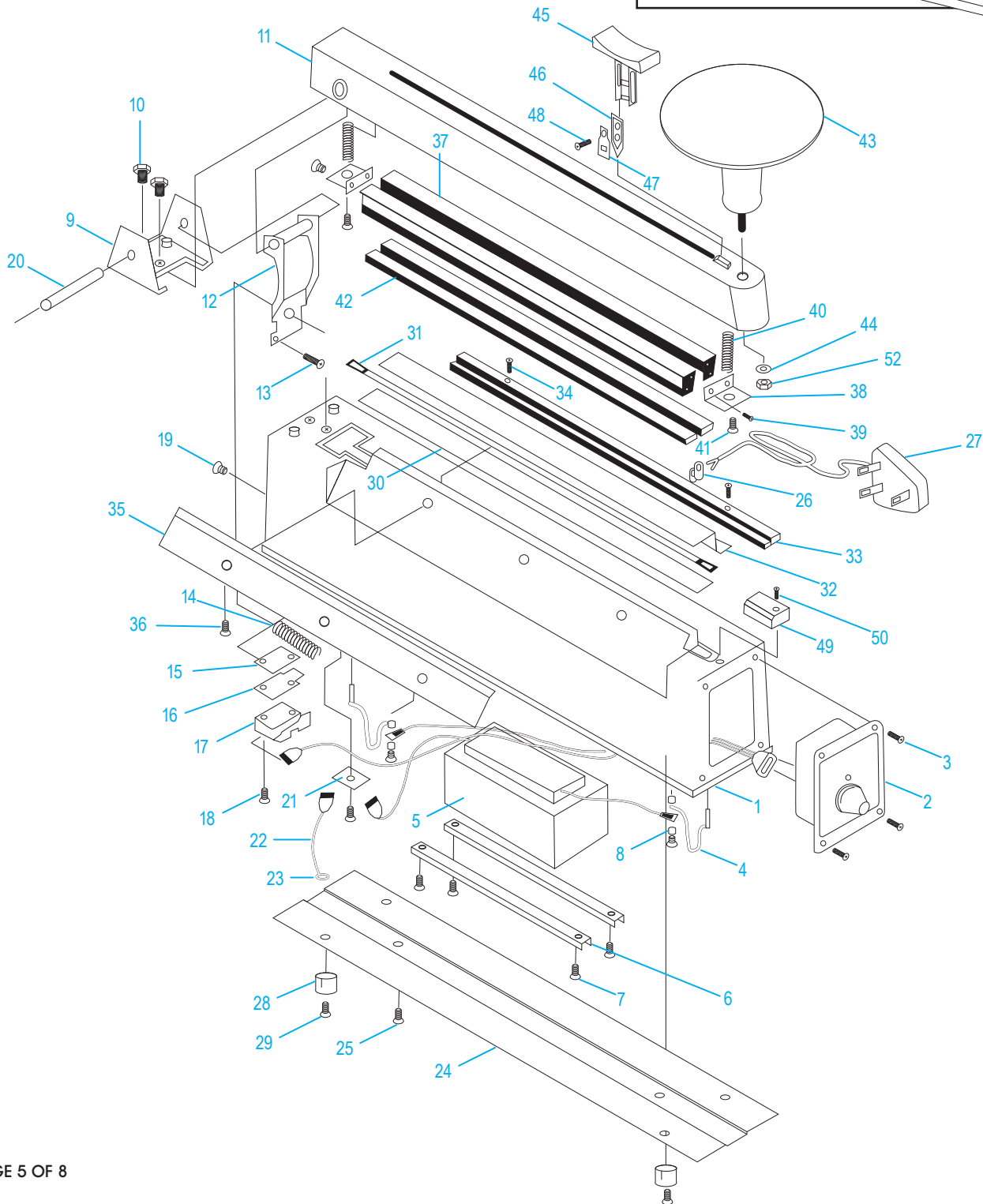
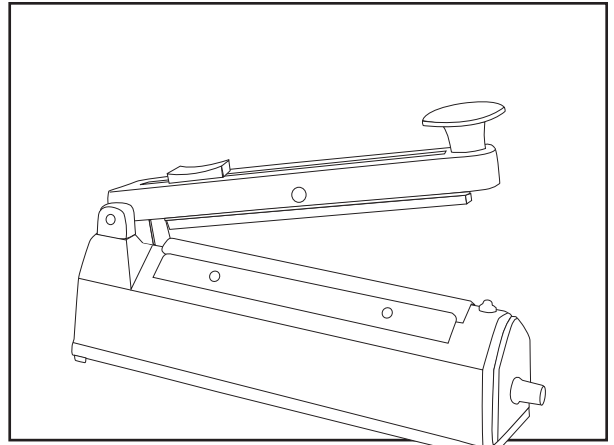



H-161, H-293
H-963, H-1252

01-800-295-5510

uline.mx

**SELLADORA DE IMPULSO
CON CORTADORA**

#	DESCRIPCIÓN	CANT.	NO. DE PARTE DE ULINE	NO. DE PARTE DEL FABRICANTE
1	Armazón	1	-----	-----
2	Temporizador (Para H-161)	1	H-161CPS	TIMER
2	Temporizador (Para H-293)	1	H-293-011	KF300HC11
2	Temporizador (Para H-963)	1	H-963-TIMER	2
2	Temporizador (Para H-1252)	1	H-1252-TIMER	TI500H
3	Tornillo	4	-----	-----
4	Resorte	2	H-163-4	#4
5	Transformador (Para H-161)	1	H-163-TRANSF	-----
5	Transformador (Para H-293)	1	H-190-18/19	KF300H1819
5	Transformador (Para H-963)	1	H-963-TRANSF	TR400C
5	Transformador (Para H-1252)	1	H-1029-TRFMR	-----
6	Soporte del Transformador	1	-----	-----
7	Tornillo	1	H-163-7	7
7-1	Rondana de Presión	1	H-163-7-1	#7-1
8	Rondana de Plástico	1	H-163-8	#8
9	Soporte de Bisagra (Para H-161)	1	-----	-----
9	Soporte de Bisagra (Para H-293)	1	H-293-HINGE	KF300HC3
9	Soporte de Bisagra (Para H-963)	1	-----	-----
9	Soporte de Bisagra (Para H-1252)	1	-----	-----
10	Tornillo	2	-----	-----
11	Brazo (Para H-161)	1	H-161-ACAST	-----
11	Brazo (Para H-293)	1	H-293-ARM	-----
11	Brazo (Para H-963)	1	H-963-11ARM	FK-400HC
11	Brazo (Para H-1252)	1	H-1252-11	11
12	Soporte del Brazo	1	-----	-----
13	Tornillo de Ajuste del Microinterruptor	1	H-963-SCREW	-----
14	Resorte del Brazo	1	-----	KF300H40
15	Soporte del Microinterruptor**	1	-----	-----
16	Placa Aislada**	1	-----	-----
17	Microinterruptor**	1	-----	-----
17-1	Placa de Microinterruptor con Resorte**	1	-----	-----
18	Tornillo de Ensamble del Microinterruptor**	1	-----	-----
19	Tornillo Fijo del Microinterruptor	1	H-1029-SCREW	-----
20	Pasador de Bisagra	1	H-963-HINGE	-----

**Vea página 8.



H-161, H-293
H-963, H-1252

**SELLADORA DE IMPULSO
CON CORTADORA**

01-800-295-5510

uline.mx

#	DESCRIPCIÓN	CANT.	NO. DE PARTE DE ULINE	NO. DE PARTE DEL FABRICANTE
21	Conector de Alambre	1	-----	-----
22	Cable de Tierra	1	-----	-----
23	Rondana de Cable de Tierra	1	-----	-----
24	Placa de Base (Para H-161)	1	-----	-----
24	Placa de Base (Para H-293)	1	-----	-----
24	Placa de Base (Para H-963)	1	-----	-----
24	Placa de Base (Para H-1252)	1	-----	-----
25	Tornillo Cable para de Tierra	1	-----	-----
26	Cojinete	1	-----	-----
27	Enchufe	1	H-293-015	KF300HC15
28	Pata de Goma	4	H-293-022	KF300HC22
29	Tornillo para Pata de Goma	4	H-963-29	8643
30	Teflón Inferior (Adhesivo) (Para H-161)	1	-----	-----
30	Teflón Inferior (Adhesivo) (Para H-293)	1	-----	-----
30	Teflón Inferior (Adhesivo) (Para H-963)	1	-----	-----
30	Teflón Inferior (Adhesivo) (Para H-1252)	1	-----	-----
31	Resistencia (Para H-161)	1	-----	-----
31	Resistencia (Para H-293)	1	-----	-----
31	Resistencia (Para H-963)	1	-----	-----
31	Resistencia (Para H-1252)	1	-----	-----
32	Teflón Superior (Para H-161)	1	-----	-----
32	Teflón Superior (Para H-293)	1	H-293-008	KF300HC8
32	Teflón Superior (Para H-963)	1	-----	-----
32	Teflón Superior (Para H-1252)	1	-----	-----
33	Placa de Teflón (Para H-161)	1	-----	-----
33	Placa de Teflón (Para H-293)	1	-----	-----
33	Placa de Teflón (Para H-963)	1	-----	-----
33	Placa de Teflón (Para H-1252)	1	-----	-----
34	Tornillo para Placa de Teflón	3	H-963-SCREWS	50
35	Placa de Teflón (Para H-161)	1	-----	-----
35	Placa Fija de Teflón (Para H-293)	1	H-293-FIXPLT	-----
35	Placa Fija de Teflón (Para H-963)	1	H-963-16FXPL	-----
35	Placa Fija de Teflón (Para H-1252)	1	H-1252-FIXPL	-----
36	Tornillo para Placa Fija de Teflón	3	H-293-036	KF300HC36

#	DESCRIPCIÓN	CANT.	NO. DE PARTE DE ULINE	NO. DE PARTE DEL FABRICANTE
37	Barra de Sellado (Para H-161)	1	H-161-37	37
37	Barra de Sellado (Para H-293)	1	H-293-PLATE	-----
37	Barra de Sellado (Para H-963)	1	H-963-SEALBR	-----
37	Barra de Sellado (Para H-1252)	1	-----	-----
38	Soporte de la Barra de Sellado	2	H-963-38	-----
39	Tornillo para el Soporte Fijo de la Barra de Sellado	2	-----	-----
40	Resorte de la Barra de Sellado	2	H-161-040	40
41	Tornillo para Resorte de la Barra de Sellado	2	H-293-041	KF300HC41
42	Goma de Silicón (Almohadilla de Sellado) (Para H-161)	1	H-161-007	7
42	Goma de Silicón (Almohadilla de Sellado) (Para H-293)	1	H-293-007	KF300HC7
42	Goma de Silicón (Almohadilla de Sellado) (Para H-963)	1	H-963-RPAD	KF400HC
42	Goma de Silicón (Almohadilla de Sellado) (Para H-1252)	1	H-1252PAD	-----
43	Ensamble de la Perilla (Incluye 44, 52)	1	H-306HK	KF400HKNOB
44	Rondana para Perilla	1	H-1252-44	44
45	Portanavaja*	1	H-161-45	45
46	Navaja* (Para H-161)	1	H-963-BLADE	-----
47	Placa Fija de Navaja*	1	H-293-47	47
48	Tuerca de Tornillo para Navaja Fija*	1	H-293-48	48
49	Cubierta para la Resistencia	1	H-963-49	49
50	Tornillo de Cubierta para la Resistencia	1	-----	-----
51	Ensamble del Pasador (No se muestra) (Para H-1252)	1	H-1252-PIN	-----
52	Tuerca para Perilla	1	-----	-----
	*Ensamble de la Cortadora (Incluye Partes 45, 46, 47, 48)	1	H-293-8	KF300HC24
	**Ensamble del Microinterruptor (Incluye Partes 15, 16, 17, 18)	1	H-306MS	H293MI
	Kit de Servicio de 8"(Para H-161) (Incluye: 2 Resistencias, 2 Tiras de Cinta PTFE, 2 Cubiertas PTFE)	1	H-495	-----
	Kit de Servicio de 12"(Para H-293) (Incluye: 2 Resistencias, 2 Tiras de Cinta PTFE, 2 Cubiertas PTFE)	1	H-294	-----
	Kit de Servicio de 16"(Para H-963) (Incluye: 2 Resistencias, 2 Tiras de Cinta PTFE, 2 Cubiertas PTFE)	1	H-964	-----
	Kit de Servicio de 20" (Para H-1252) (Incluye: 2 Resistencias, 2 Tiras de Cinta PTFE, 2 Cubiertas PTFE)	1	H-1253	-----